

Caravans 2024

Technical Information

Valid from September 15th, 2023



Dethleffs Plus Factors –

Explanation of symbols

In the Dethleffs caravans, there are a lot of smart ideas and standard features for more safety and comfort. Here we present the most important ones with the corresponding symbols which can be found on the pages of the vehicle. More detailed information can be found at: www.dethleffs.com/plus-factors.

Family benefits



Happy family: Layouts with bunk beds – ideal for families. Up to three bunk beds available as an option.



Practical refrigerator with large volume and separate freezer compartment (details see technical data)

Added comfort



Inviting: 70 cm wide XXL entrance door



SleepWell: Fixed beds with 7-zone mattresses with ergonomic wooden slatted bed frames



More room: Fold-away lower bunk bed for more storage or greater playground (dep. on model)



Practical pull-down bed for easy stowage above the seating group (depending on model)



More legroom: One-leg telescopic table with easy lowering function for converting the lounge to bed (depending on model)

Added safety



Vehicle roof made of robust GRP – protects from unusual weather conditions



Roof, front and rear made of robust GRP



Better safe than sorry: Benefit from Safety Packages for more safety on the road (option)



Safety on the road: Brand chassis from safety experts



Safety clutch: Stabilises rolling and pitching movements



Safety on the road: Thanks to the outstanding deceleration values and automated re-adjustment

Added equipment



Winter expert! Winter-proof caravans thanks to optional Winter Comfort Packages (option)



Agile travelling – with caravans that go up to 100 km/h



For a healthy room climate: Optimum ventilation of the overhead lockers avoids condensation



System Information Unit: The SIU control unit incl. the sensors for displaying the vehicle leveling and the battery voltage are installed as standard (further sensors optionally available via Dethleffs Original Accessories)



Caravans 2024

	c'joy	c'go	c'go up	Aero	Aero up	Camper®
	Single-axle	Single-axle	Single-axle	Single-axle	Single-axle	Single-axle
Bunk bed layouts						
8 m						
6 m						
5 m						
Conversion length	410 LK 480 QLK	495 QSK 565 FMK	465 KR 525 KR	470 FSK 490 QSK 500 QSK	460 KR 530 KR	500 QSK 530 FSK 540 QMK 550 ESK
Width	2,12 m 2,12 m	2,3 m 2,5 m	2,3 m 2,3 m	2,3 m 2,3 m 2,3 m	2,3 m 2,3 m	2,3 m 2,3 m 2,5 m 2,3 m
Double bed layouts						
8 m						
6 m						
5 m						
Conversion length	420 QSH 480 FSH	415 QL 475 FR 495 FR		410 QS 470 FR		470 FR
Width	2,12 m 2,12 m	2,2 m 2,3 m 2,3 m		2,3 m 2,3 m		2,3 m
Single beds layouts						
8 m						
6 m						
5 m						
Conversion length	460 LE	475 EL		470 EL 510 ER 520 ER 530 ER		460 EL 470 ER 510 LE 510 ER
Width	2,12 m	2,3 m		2,3 m 2,3 m 2,3 m 2,3 m		2,3 m 2,3 m 2,3 m 2,3 m

IMPORTANT INFORMATION REGARDING THE SELECTION OF YOUR CARAVAN

When purchasing a caravan, it is especially important to select not only an appealing design, but also the right layout. Weight also plays an essential role here. Family, friends, optional equipment, accessories, and baggage – there should be enough space for all of this. At the same time, there are legal and technical limits for configuration and loading. Each caravan is designed for a certain weight which must not be exceeded during travel. This raises a question for caravan buyers: How should I configure my vehicle to accommodate baggage and accessories according to my needs without causing the vehicle to exceed this maximum weight? To help you make this decision, we have provided you some information below that is particularly important when selecting your vehicle from our product range:

1. The technically permissible maximum laden mass...

... is a value specified by the manufacturer which the vehicle must not exceed. Based on the layout, Dethleffs specifies an upper limit for the vehicle, which can vary from layout to layout (e.g. 1,600 kg, 1,700 kg). You will find the corresponding specification for each layout in the technical data.

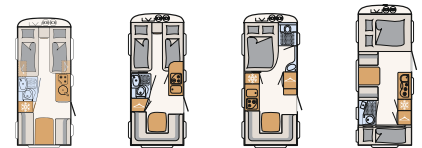

Caravans		460 EL	470 ER	470 FR	500 QSK
Sleeping berths standard / max.		3	3	4	5/6 ○
● Technically permissible maximum laden mass*	kg	1500	1500	1500	1500
Manufacturer-specified mass for optional equipment*	kg	180	188	158	96
● Mass in running order (± 5 %)*	kg	1235 (1173 to 1297)*	1225 (1164 to 1286)*	1245 (1183 to 1307)*	1295 (1130 to 1360)*

2. The mass in running order...

... consists – to put it simply – of the basic vehicle with standard equipment. It is legally permissible and possible for the mass in running order of your vehicle to deviate from the nominal value specified in the sales documents. The permissible tolerance is ± 5%. The permissible range in kilograms is stated in parentheses after the mass in running order. In order to provide you with full transparency regarding possible weight deviations, Dethleffs weighs each vehicle at the end of the line and informs your trading partner of the weighing result of your vehicle for forwarding to you. For detailed explanations of the mass in running order and the effect of tolerances on the minimum payload and the payload, please refer to the “Legal notes” section.

3. The standard sleeping berths...

... are specified by the manufacturer and shown in the sales documents. The number of sleeping berths can be increased (e.g. 3-person bunk bed) or, if required, reduced (e.g. sideboard instead of seating group) by selecting optional equipment.

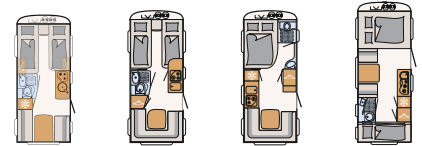

Caravans		460 EL	470 ER	470 FR	500 QSK
● Sleeping berths standard / max.		3	3	4	5/6 ○
Technically permissible maximum laden mass*	kg	1500	1500	1500	1500
● Manufacturer-specified mass for optional equipment*	kg	180	188	158	96
Mass in running order ((± 5 %)*	kg	1235 (1173 to 1297)*	1225 (1164 to 1286)*	1245 (1183 to 1307)*	1295 (1130 to 1360)*

4. The mass for optional equipment specified by the manufacturer...

... is a value set for each layout by Dethleffs for the maximum mass of optional equipment that can be ordered. This limit is intended to ensure that the minimum payload, i.e. the legally required free mass for baggage and retrofitted accessories, is actually available for the load capacity of the vehicles delivered by Dethleffs. If, in exceptional cases, the weighing at the end of the line nevertheless shows that the actual load capacity falls short of the minimum payload due to a permissible weight deviation, we will check together with your trading partner and you whether we should, for example, increase the load capacity of the vehicle or remove optional equipment before delivering the vehicle. For detailed explanations of the effects of the tolerances on the minimum payload and the payload, please refer to the "Legal notes" section.

Optional equipment**

	Included in package	Price	Additional weight (kg)*	Code	460 EL	470 ER	470 FR
Bathroom							
Bathroom in alternative design	-	399,-	4	604	-	-	-
Multimedia							
Multifunctional external connection, 12 V, 220 V, TV and SAT	-	1.129,-	10	1049	-	○	○
Flat screen TV 22" incl. DVD player and receiver	-	999,-	3.5	1103	○	○	○

5. The additional weight of optional equipment and packages...

... increases the actual mass of the vehicle (= mass in running order plus selected optional equipment) and reduces the payload. The specified value shows the additional weight compared to the standard equipment of the respective layout. The total weight of the selected packages and optional equipment must not exceed the mass for optional equipment specified by the manufacturer.



INDEX CARAVANS MODEL YEAR 2024

IMPORTANT INFORMATION	REGARDING THE SELECTION OF YOUR CARAVAN	5
c'joy	c'joy	8
c'go & c'go up	c'go & c'go up.....	14
Aero & Aero up	Aero & Aero up.....	24
Camper®	Camper®	35
Nomad	Nomad.....	52
Beduin Scandinavia	Beduin Scandinavia.....	68
LEGAL NOTES	ON WEIGHT-RELATED INFORMATION	78
	TECHNICAL INFORMATION / FOOTNOTES.....	80

c'joy

Perfect for beginners

The c'joy has everything you need to experience great freedom. Thanks to its compact dimensions and low weight, it is also suitable for small cars and, depending on the towing vehicle, can also be driven with a class B driving licence. Nevertheless, it offers enough space - and that for up to 6 people - depending on the model. This makes holidays fun!

Upholstery



+ Upholstery Timor



+ Upholstery Kapan

○

Wood décor



+ Wood décor Tindari Bora

○ optionally available

Technical info

Overall length, approx.	622 - 714 cm
Overall width, approx.	212 cm
Overall height, approx.	265 cm
Headroom in living area, approx.	198 cm

Maximum values partly not possible for all models or only in connection with certain options.

Plus factors

- + Don't be afraid of narrow passages: with a width of just 212 cm, it is very easy to ride
- + Real lightweight: With the appropriate towing vehicle, a class B driving licence is often sufficient
- + Protects you from bad weather: roof, front and rear made of robust GRP
- + The perfect entry-level caravan: attractively priced and everything you need inside and out
- + You don't have to do without anything: The large storage compartments there is room for everything you need



c'joy

Technical info



c'joy		410 LK	420 QSH	460 LE	480 FSH	480 QLK
Standard chassis		Lightweight chassis, 1100 kg	Lightweight chassis, 1100 kg	Lightweight chassis, 1200 kg	Lightweight chassis, 1200 kg	Lightweight chassis, 1200 kg
Overall length, approx.	cm	622	625	675	708	714
Body length approx.	cm	499	503	553	593	593
Overall width, approx.	cm	212	212	212	212	212
Overall height, approx.	cm	265	265	265	265	265
Circumferential dimension awning approx.	cm	914	918	968	1008	1008
Headroom in living area, approx.	cm	198	198	198	198	198
Thickness floor / side walls / roof	mm	38 / 28 / 28	38 / 28 / 28	38 / 28 / 28	38 / 28 / 28	38 / 28 / 28
Tire size		185 R14C 8PR	185 R14C 8PR	185 R14C 8PR	185 R14C 8PR	185 R14C 8PR
Bed dimension: Front bed, L x W, approx.	cm	190 x 140 - 115	195 x 150	190 x 100 - 90	200 x 160	190 x 150
Bed dimension: Central / middle bed, L X W, approx.	cm		170 x 90 - 80		170 x 90	190 x 120
Bed dimension: Rear bed, L x W, approx.	cm	190 x 65 / 190 x 70 / 2x 190 x 70 ○ / 190 x 60 ○		200 x 80 / 195 x 80 / 200 - 195 x 190 ○		190 x 60 / 190 x 70 / 2x 190 x 60 ○ / 190 x 70 ○
Sleeping berths standard / max.		4 / 5 ○	3	3	3	5 / 6 ○
Mass in running order (+/-5%)*	kg	950 (903 to 998)*	920 (874 to 966)*	960 (912 to 1008)*	1025 (974 to 1076)*	1065 (1012 to 1118)*
Manufacturer-specified mass for optional equipment*	kg	60	100	155	86	126
Technically permissible maximum laden mass*	kg	1100	1100	1200	1200	1300
Heating		S 3004, 3.5 kW Gas	S 3004, 3.5 kW Gas	S 3004, 3.5 kW Gas	S 3004, 3.5 kW Gas	S 3004, 3.5 kW Gas
Refrigerator volume (thereof freezer), approx.	l	131,5 (15)	131,5 (15)	83 (8,2)	131,5 (15)	131,5 (15)
Fresh water tank capacity, total/ Fresh water tank capacity at driving filling	l	12 / 12	12 / 12	12 / 12	12 / 12	12 / 12
Sockets: 12 V / 230 V / USB		0 / 3 / 0	0 / 3 / 0	0 / 3 / 0	0 / 3 / 0	0 / 2 / 0

○ Optional equipment — Not possible ● Standard equipment ◆ Mandatory △ Not known at the time of publication



The specified mass in running order is a standard value defined in the type approval procedure. Due to manufacturing tolerances, the actual weighed mass in running order may deviate from the value stated above. Deviations of up to ± 5% of the mass in running order are legally permissible and possible. The permissible range in kilograms is stated in parentheses after the mass in running order. The mass for optional equipment specified by the manufacturer is an imputed value determined for each type and layout by which Dethleffs specifies the maximum weight available for factory-fitted optional equipment. The purpose of limiting optional equipment is to ensure that the minimum payload, i.e. the legally required free mass for baggage and retrofitted accessories, is actually available for the load capacity of vehicles delivered by

Dethleffs. The actual weight of your vehicle after leaving the factory can only be determined when it is weighed at the end of the line. If, in exceptional cases, the weighing shows that the actual load capacity falls short of the minimum payload due to a permissible weight deviation, despite the limitation of the optional equipment, we will check together with your trading partner and you before delivery of the vehicle whether we should, for example, increase the load capacity of the vehicle or remove optional equipment. The technically permissible maximum laden mass of the vehicle must not be exceeded. For detailed information and explanations on the topic of weight and the configuration of the vehicle, please refer to the "Legal notes" section.

Standard equipment

	410 LK	420 QSH	460 LE	480 FSH	480 QLK
Chassis					
Chassis galvanised, with overrun braking system and automatic reverse	●	●	●	●	●
Tyres on steel wheels 185 R14 C 8 PR, up to and including 1.600 kg	●	●	●	●	●
Chassis features					
High-quality brand-name tyres, designed for a speed of 100 km/h	●	●	●	●	●
Lightweight corner steadies	●	●	●	●	●
Exterior features					
Floor of the gas bottle locker made of rot-resistant and robust corrugated aluminium	●	●	●	●	●
Front, rear and roof made of robust GRP	●	●	●	●	●
Opening windows, insulated and double-glazed (graphite grey) with blackout and mosquito blinds	●	●	●	●	●
Storage space for 2 gas bottles with 11 kg filling weight each	●	●	●	●	●
Two-piece entrance door	●	●	●	●	●
Exterior design					
Sides in hammer finish, white	●	●	●	●	●
Access locker doors					
Access locker door rear right side 560x1150 mm	●	—	—	—	●
Interior design					
Upholstery Timor	●	●	●	●	●
Wood décor Tindari Bora	●	●	●	●	●
Textile equipment					
7-zones cold foam mattress single bed, left side, standard	—	—	●	—	—
7-zones cold foam mattress single bed, right side, standard	—	—	●	—	—
Cold foam double bed mattress	—	●	—	●	●
Furniture layouts					
AirPlus - perfect air circulation in the interior and rear ventilation of the overhead lockers and sideboards	●	●	●	●	●
Bunk bed with 2 sleeping berths, foldable	●	—	—	—	●
Bunk beds with safety net and ladder	●	—	—	—	●
Seating lounge converts to bed	●	●	●	●	●
Special slatted frame with flexible natural rubber holders, opening for optimal use of storage compartments under the beds	●	●	●	●	●
Kitchen					
Practical 3-flames cooker with manual ignition	●	●	●	●	●
Spacious fridge with 83 liters volume and 8.2 liters freezer compartment	—	—	●	—	—
Spacious refrigerator with 131.5 litre capacity and 15 litre freezer compartment	●	●	—	●	●
Bathroom					
Shapely washbasin	●	●	●	●	●
Shower tray	●	●	●	●	●
Skylight with mosquito net	●	●	●	●	●
Heating					
Gas heating S 3004 with automatic ignition	●	●	●	●	●
Electrical installation					
12 V power supply throughout vehicle	●	●	●	●	●
Awning light 12V	●	●	●	●	●
CEE external output socket for 230V on-board electrics	●	●	●	●	●
Compact power distribution unit with 230V safety device and 12V fuse box in wardrobe incl. powerful 340W transformer	●	●	●	●	●
Water supply					
Electric water supply	●	●	●	●	●
Fresh water canister 12 l	●	●	●	●	●
Miscellaneous					
SIU-ready (preparation for SIU control unit)	●	●	●	●	●

Packages c'joy

Package	Dynamic Package (13094)	Dynamic Package (13274)	Dynamic Package (13275)
Safety coupling	x	x	x
Shock absorbers	x	x	x
Fresh water tank 44 l	x	x	x
Mobile 22 l waste water tank	x	x	x
Spare wheel carrier in gas locker	x	x	x
Access locker door front right side 1000x420 mm	x		
Access locker door rear right side 1000x420 mm		x	
Access locker door front right side 750x300 mm			x
Additional weight (kg)*	28.1	28.1	28.1

Package	Autonomy Package I (10011)	Autonomy Package II (10012)
Battery (95 Ah)	x	x
Battery charger	x	x
Central 12V main switch	x	x
Voltage display	x	x
Fan 12V for S 3004	x	
Additional weight (kg)*	31	29

Touring Package (9243)	
Hot water supply	
Hot air system	
Skylight 700 x 500 mm	
Flyscreen door	
Additional weight (kg)*	13

△ Not known at the time of publication



The factory installation of optional equipment increases the actual mass of the vehicle and reduces the payload. The specified additional weight for packages and optional equipment shows the additional weight compared with the standard equipment of the respective model or layout. The total weight of the selected optional equipment must not exceed the mass for optional equipment specified by the manufacturer in the model overviews. This is an imputed

value determined for each model and layout that Dethleffs uses to determine the maximum weight available for factory-installed optional equipment. In the event of an increase of load capacity, the mass for optional equipment specified by the manufacturer is increased. For detailed information and explanations on the topic of weight, please refer to the "Legal notes" section.

Optional equipment**

Included in package	Additional weight (kg)*	Code	410 LK	420 QSH	460 LE	480 FSH	480 QLK
---------------------	-------------------------	------	--------	---------	--------	---------	---------

Chassis							
17" alloy wheels in Dethleffs design (single axle)	—	1	11608	○	○	○	○
Tyres on alloy wheels 185 R14 C LI102, up to and including 1600 kg	—	1	836	○	○	○	○
Weight upgrade							
Weight upgrade to 1.200 kg (without chassis change)	—	0	134	○	○	—	—
Weight upgrade to 1.300 kg (without chassis change)	—	0	135	—	○	—	—
Weight upgrade to 1.360 kg (without chassis change)	—	0	9619	○	○	○	○
Weight upgrade to 1.500 kg	—	20	136	—	○	—	—
Weight upgrade to 1.500 kg	—	0	136	—	—	—	○
Chassis features							
Draw bar cover	—	2.5	13098	○	○	○	○
ETS Plus stabilisation system	—	5.3	10764	○	○	○	○
Spare tyre with alloy wheel 185 R14 C LI 102, up to and including 1.600 kg	—	17	837	—	○	—	○
Spare tyre with alloy wheel 215/60 R17 C LI 109	—	24.1	11540	○	○	○	○
Spare tyre with steel wheel 185 R14 C 8 PR, up to and including 1.600 kg	—	18	831	—	○	—	○
Wheel trims for 14" tyres	—	0.5	276	○	○	○	○
Exterior features							
Flyscreen door	TP	3	360	○	○	○	○
Front window	—	3	982	●	○	●	○
Kitchen window, sliding (change of window shape)	—	3	6406	○	○	○	○
Opening window in bathroom	—	2	1028	○	○	○	○
Rear window	—	4	1108	—	—	○	—
Skylight 700 x 500 mm	TP	8	11575	○	○	○	○
Spare wheel carrier in gas locker	DP	1	432	○	○	○	○
Access locker doors							
Access locker door front left side 1000x420 mm	—	2	6415	—	○	—	○
Access locker door front right side 1000x420 mm	DP	2	6416	—	○	—	○
Access locker door front right side 750x300 mm	DP	2	6420	○	—	—	—
Access locker door rear left side 1000x420 mm	—	2	6417	—	—	○	—
Access locker door rear right side 1000x420 mm	DP	2	6418	—	—	○	—
Interior design							
Upholstery Kapan	—	0	13226	○	○	○	○
Furniture layouts							
Bunk bed with 3 sleeping berths, not foldable	—	21	200	○	—	—	○
Single beds convert to double bed	—	6	685	—	—	○	—
Multimedia							
Multifunctional external connection, 12 V, 220 V, TV and SAT	—	1	611	○	○	○	○
Preparation for flat screen TV (antenna cable and TV bracket)	—	2	678	○	○	○	○
Heating							
Fan 12V for S 3004	AP	2	177	○	○	○	○
Hot air system	TP	0	142	○	○	○	○
Ultraheat additional heating for S 3004, electric 220 V	—	2	364	○	○	○	○



The factory installation of optional equipment increases the actual mass of the vehicle and reduces the payload. The specified additional weight for packages and optional equipment shows the additional weight compared with the standard equipment of the respective model or layout. The total weight of the selected optional equipment must not exceed the mass for optional equipment specified by the manufacturer in the model overviews. This is an imputed

value determined for each model and layout that Dethleffs uses to determine the maximum weight available for factory-installed optional equipment. In the event of an increase of load capacity, the mass for optional equipment specified by the manufacturer is increased. For detailed information and explanations on the topic of weight, please refer to the "Legal notes" section.

Optional equipment**

	Included in package	Additional weight (kg)*	Code	410 LK	420 QSH	460 LE	480 FSH	480 QLK
Air Conditioning								
Pre-wiring for A/C	—	3.5	172	○	○	○	○	○
Electrical installation								
Additional lighting through LED spotlights	—	2	9692	○	○	○	○	○
USB port for spotlight bar	—	0.5	9989	○	○	○	○	○
Water supply								
Fresh water tank 44 l	DP	6	9240	○	○	○	○	○
Hot water supply	TP	2	123	○	○	○	○	○
Mobile 22 l waste water tank	DP	3	367	○	○	○	○	○
Shower equipment with shower fittings and curtain	—	3	1097	○	○	○	○	○
Gas supply								
Gas detection system	—	0.5	10058	○	○	○	○	○
Packages								
Autonomy Package I ²⁾	—	31	10011	○	○	○	○	○
Autonomy Package II	—	29	10012	○	○	○	○	○
Dynamic Package ¹⁾	—	28.1	13094	—	○	—	○	○
Dynamic Package ¹⁾	—	28.1	13274	—	—	○	—	—
Dynamic Package ¹⁾	—	28.1	13275	○	—	—	—	—
Touring Package	—	13	9243	○	○	○	○	○
Miscellaneous								
Registration documents (CoC papers)	—	0	15151	◆	◆	◆	◆	◆

○ Optional equipment — Not possible ● Standard equipment ◆ Mandatory △ Not known at the time of publication

TP Touring Package DP Dynamic Package AP Autonomy Package



The factory installation of optional equipment increases the actual mass of the vehicle and reduces the payload. The specified additional weight for packages and optional equipment shows the additional weight compared with the standard equipment of the respective model or layout. The total weight of the selected optional equipment must not exceed the mass for optional equipment specified by the manufacturer in the model overviews. This is an imputed

value determined for each model and layout that Dethleffs uses to determine the maximum weight available for factory-installed optional equipment. In the event of an increase of load capacity, the mass for optional equipment specified by the manufacturer is increased. For detailed information and explanations on the topic of weight, please refer to the "Legal notes" section.

c'go & c'go up

Caravans to go

The c'go makes you want to pack your bags and go on tour right away. Be inspired by the new and modern interior and feel at home, no matter where your journey takes you. In addition, the c'go has a wide choice of layouts: from the small compact to the spacious family caravan. Only the c'go up promises more freedom with its clever pull-down bed above the seating group, making it the ideal travel companion and particularly popular with young couples and small families. When do we leave?

Upholstery

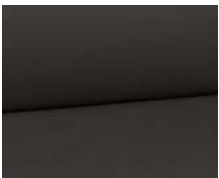

+ Upholstery Ronda



+ Upholstery Estepona



+ Upholstery Manilva

Wood décor

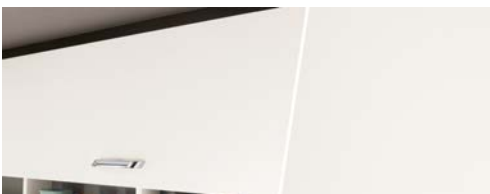

+ WEB Alaska White

optionally available

Technical info

Overall length, approx.	631 - 803 cm
Overall width, approx.	220 - 250 cm
Overall height, approx.	261 - 271 cm
Headroom in living area, approx.	198 - 208 cm

Maximum values partly not possible for all models or only in connection with certain options.

Plus factors

- + Lightweight: So light, in many cases you can even tow it with a class B driving licence (depending on the towing vehicle)
- + Something for everyone: thanks to the large selection of layouts
- + Protects you from bad weather: roof, front and rear made of robust GRP
- + Fresh look: chic, modern interior design and a stylish selection of upholstery to suit individual tastes
- + c'go up with standard fold-down bed (200 x 140 cm lying surface) above the seating group



c'go & c'go up Technical info



c'go & c'go up		415 QL	475 EL	475 FR	495 FR
Standard chassis		Lightweight chassis, 1200 kg	Lightweight chassis, 1300 kg	Lightweight chassis, 1300 kg	Lightweight chassis, 1360 kg
Overall length, approx.	cm	631	676	680	725
Body length approx.	cm	498	552	558	588
Overall width, approx.	cm	220	230	230	230
Overall height, approx.	cm	261	261	261	261
Circumferential dimension awning approx.	cm	902	955	962	992
Headroom in living area, approx.	cm	198	198	198	198
Thickness floor / side walls / roof	mm	38 / 28 / 28	38 / 28 / 28	38 / 28 / 28	38 / 28 / 28
Tire size		185 R14C 8PR	185 R14C 8PR	185 R14C 8PR	185 R14C 8PR
Bed dimension: Front bed, L x W, approx.	cm	200 x 135	210 x 85 / 185 x 85 / 200 x 190 ○	205 x 144 - 110	200 x 145 - 110
Bed dimension: Central / middle bed, L X W, approx.	cm				
Bed dimension: Rear bed, L x W, approx.	cm	200 x 130 - 100	210 x 105	212 x 132 - 149	210 x 150 - 130
Sleeping berths standard / max.		3	3	4	4
Mass in running order (+/-5%)*	kg	1005 (955 to 1055)*	1125 (1069 to 1181)*	1135 (1078 to 1192)*	1160 (1102 to 1218)*
Manufacturer-specified mass for optional equipment*	kg	115	90	69	101
Technically permissible maximum laden mass*	kg	1200	1300	1300	1360
Heating		S 3004, 3.5 kW Gas	S 3004, 3.5 kW Gas	S 3004, 3.5 kW Gas	S 3004, 3.5 kW Gas
Refrigerator volume (thereof freezer), approx.	l	78 (11)	78 (11)	137 (15)	137 (15)
Waste water tank, approx.	l	23	23	23	23
Fresh water tank capacity, total/ Fresh water tank capacity at driving filling	l	44 / 15	44 / 15	44 / 15	44 / 15
Sockets: 12 V / 230 V / USB		0 / 5 / 0	0 / 5 / 0	0 / 5 / 0	0 / 5 / 0



* INFO

The specified mass in running order is a standard value defined in the type approval procedure. Due to manufacturing tolerances, the actual weighed mass in running order may deviate from the value stated above. Deviations of up to $\pm 5\%$ of the mass in running order are legally permissible and possible. The permissible range in kilograms is stated in parentheses after the mass in running order. The mass for optional equipment specified by the manufacturer is an imputed value determined for each type and layout by which Dethleffs specifies the maximum weight available for factory-fitted optional equipment. The purpose of limiting optional equipment is to ensure that the minimum payload, i.e. the legally required free mass for baggage and retrofitted accessories, is actually available for the load capacity of vehicles delivered by

Dethleffs. The actual weight of your vehicle after leaving the factory can only be determined when it is weighed at the end of the line. If, in exceptional cases, the weighing shows that the actual load capacity falls short of the minimum payload due to a permissible weight deviation, despite the limitation of the optional equipment, we will check together with your trading partner and you before delivery of the vehicle whether we should, for example, increase the load capacity of the vehicle or remove optional equipment. The technically permissible maximum laden mass of the vehicle must not be exceeded. For detailed information and explanations on the topic of weight and the configuration of the vehicle, please refer to the "Legal notes" section.

ć'go & ć'go up

Technical info

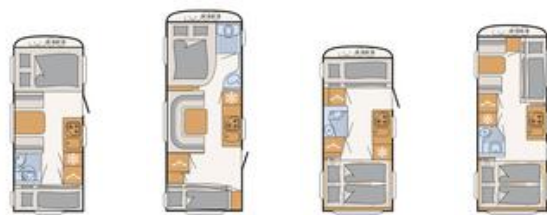

ć'go & ć'go up		495 QSK	565 FMK	up 465 KR	up 525 KR
Standard chassis		Lightweight chassis, 1360 kg	Lightweight chassis, 1600 kg	Lightweight chassis, 1500 kg	Lightweight chassis, 1600 kg
Overall length, approx.	cm	714	803	682	756
Body length approx.	cm	587	672	551	623
Overall width, approx.	cm	230	250	230	230
Overall height, approx.	cm	261	261	271	271
Circumferential dimension awning approx.	cm	990	1086	968	1040
Headroom in living area, approx.	cm	198	198	208	208
Thickness floor / side walls / roof	mm	38 / 28 / 28	38 / 28 / 28	38 / 28 / 28	38 / 28 / 28
Tire size		185 R14C 8PR	185 R14C 8PR	185 R14C 8PR	185 R14C 8PR
Bed dimension: Front bed, L x W, approx.	cm	210 x 135	205 x 165 - 130	2x 210 x 95	205 x 75 / 200 x 75 / 175 x 90 - 80
Bed dimension: Central / middle bed, L X W, approx.	cm	190 x 90	200 x 110		
Bed dimension: Rear bed, L x W, approx.	cm	2x 210 x 75 / 3x 210 x 75 ○	2x 200 x 80 / 2x 200 x 80 ○ / 200 x 70 ○	200 x 145 / 210 x 170 - 160	200 x 145 / 212 x 170 - 160
Sleeping berths standard / max.		5 / 6 ○	5 / 6 ○	6	7
Mass in running order (+/-5%)*	kg	1165 (1107 to 1223)*	1370 (1302 to 1439)*	1230 (1169 to 1292)*	1340 (1273 to 1407)*
Manufacturer-specified mass for optional equipment*	kg	86	113	155	128
Technically permissible maximum laden mass*	kg	1360	1600	1500	1600
Heating		S 3004, 3.5 kW Gas	S 5004, 6 kW Gas	S 3004, 3.5 kW Gas	S 3004, 3.5 kW Gas
Refrigerator volume (thereof freezer), approx.	l	137 (15)	137 (15)	137 (15)	137 (15)
Waste water tank, approx.	l	23	23	23	23
Fresh water tank capacity, total/ Fresh water tank capacity at driving filling	l	44 / 15	44 / 15	44 / 15	44 / 15
Sockets: 12 V / 230 V / USB		0 / 5 / 0	0 / 6 / 0	0 / 5 / 0	0 / 6 / 0

○ Optional equipment — Not possible ● Standard equipment ◆ Mandatory ▲ Not known at the time of publication



* INFO

The specified mass in running order is a standard value defined in the type approval procedure. Due to manufacturing tolerances, the actual weighed mass in running order may deviate from the value stated above. Deviations of up to ± 5% of the mass in running order are legally permissible and possible. The permissible range in kilograms is stated in parentheses after the mass in running order. The mass for optional equipment specified by the manufacturer is an imputed value determined for each type and layout by which Dethleffs specifies the maximum weight available for factory-fitted optional equipment. The purpose of limiting optional equipment is to ensure that the minimum payload, i.e. the legally required free mass for baggage and retrofitted accessories, is actually available for the load capacity of vehicles delivered by

Dethleffs. The actual weight of your vehicle after leaving the factory can only be determined when it is weighed at the end of the line. If, in exceptional cases, the weighing shows that the actual load capacity falls short of the minimum payload due to a permissible weight deviation, despite the limitation of the optional equipment, we will check together with your trading partner and you before delivery of the vehicle whether we should, for example, increase the load capacity of the vehicle or remove optional equipment. The technically permissible maximum laden mass of the vehicle must not be exceeded. For detailed information and explanations on the topic of weight and the configuration of the vehicle, please refer to the "Legal notes" section.

Standard equipment

	415 QL	475 EL	475 FR	495 FR	495 QSK	565 FMK	up 465 KR	up 525 KR
Chassis								
Tyres on steel wheels 185 R14 C 8 PR, up to and including 1.600 kg	●	●	●	●	●	●	●	●
Zinc-plated chassis with inertia braking system with reversing automatic	●	●	●	●	●	●	●	●
Chassis features								
AAA self-adjusting brake	—	—	—	—	—	—	●	●
ACS stabiliser	●	●	●	●	●	●	●	●
High-quality brand-name tyres, designed for a speed of 100 km/h	●	●	●	●	●	●	●	●
Lightweight zinc-plated corner steadies	●	●	●	●	●	●	●	●
Octagon shock absorber	●	●	●	●	●	●	●	●
Exterior features								
Floor of the gas bottle locker made of rot-resistant and robust corrugated aluminium	●	●	●	●	●	●	●	●
Front, rear and roof made of robust GRP	●	●	●	●	●	●	●	●
One-piece habitation door	●	●	●	●	●	●	●	●
Opening windows, trapezoid, insulated and double-glazed (graphite grey) with blackout and mosquito blinds	●	—	●	●	●	●	●	●
Skylight Mini Heki	●	—	●	●	●	●	●	●
Spare wheel carrier in gas locker	●	●	●	●	●	●	●	●
Storage space for 2 gas bottles with 11 kg filling weight each	●	●	●	●	●	●	●	●
Exterior design								
Sides in hammer finish, white	●	●	●	●	●	●	●	●
Access locker doors								
Access locker door front right side 1000x420 mm	●	●	●	●	●	—	—	—
Access locker door front right side 749x297 mm	—	—	—	—	—	—	●	—
Access locker door front right side 997x419 mm	—	—	—	—	—	—	—	●
Interior design								
Upholstery Ronda	●	●	●	●	●	●	●	●
WEB Alaska White	●	●	●	●	●	●	●	●
Textile equipment								
7-zones cold foam mattress single bed, left side, standard	—	●	—	—	—	—	—	—
7-zones cold foam mattress single bed, right side, standard	—	●	—	—	—	—	—	—
Cold foam double bed mattress	●	—	●	●	●	●	●	●
Furniture layouts								
AirPlus - perfect air circulation in the interior and rear ventilation of the overhead lockers and sideboards	●	●	●	●	●	●	●	●
Bunk bed with 2 sleeping berths, foldable	—	—	—	—	●	●	●	●
Bunk beds with safety net and ladder	—	—	—	—	●	●	●	●
Seating lounge converts to bed	●	●	●	●	●	●	●	●
Spacious pull-down bed above seating lounge, with manual control	—	—	—	—	—	—	●	●
Special slatted frame with flexible natural rubber holders, opening for optimal use of storage compartments under the beds	●	●	●	●	●	●	●	●
Interior features								
Smoke detector	●	●	●	●	●	●	●	●
Kitchen								
Generous drawers with soft closing for absolutely silent closing	●	●	●	●	●	●	●	●
Large fridge with 137 liters capacity and 15 liters freezer compartment	—	—	●	●	●	●	●	●
Practical 3-flames cooker with electric ignition	●	●	●	●	●	●	●	●
Spacious fridge with 78 liters volume and 11 liters freezer compartment	●	●	—	—	—	—	—	—
Bathroom								
Shapely washbasin	●	●	●	●	●	●	●	●
Shower tray	●	●	●	●	●	●	●	●
Skylight with mosquito net	●	●	●	●	●	●	●	●
Heating								

Standard equipment

	415 QL	475 EL	475 FR	495 FR	495 QSK	565 FMK	up 465 KR	up 525 KR
Gas heating S 3004 with automatic ignition	●	●	●	●	●	—	●	●
Gas heating S 5004 with automatic ignition	—	—	—	—	—	●	—	—
Electrical installation								
12 V power supply throughout vehicle	●	●	●	●	●	●	●	●
Additional lighting through LED spotlights	●	●	●	●	●	●	●	●
Awning light 12V	●	●	●	●	●	●	●	●
CEE external output socket for 230V on-board electrics	●	●	●	●	●	●	●	●
Compact power distribution unit with 230V safety device and 12V fuse box in wardrobe incl. powerful 340W transformer	●	●	●	●	●	●	●	●
LED spots in front and rear seating lounges	●	●	●	●	●	●	●	●
Water supply								
Electric water supply	●	●	●	●	●	●	●	●
Fresh water tank 44 l	●	●	●	●	●	●	●	●
Mobile 22 l waste water tank	●	●	●	●	●	●	●	●
Miscellaneous								
Dethleffs Connect - System Information Unit: SIU control unit incl. voltage and levelling display via the Dethleffs app.	●	●	●	●	●	●	●	●

Packages c'go & c'go up

Package	Safety Package (9556)	Safety Package (9556)
ATC Trailer Control	x	x
DuoControl safety gas pressure regulator with crash sensor	x	
DuoControl safety gas pressure regulator with crash sensor and EisEx gas regulator heater		x
Additional weight (kg)*	4.4	4.4

Package	Autonomy Package I (10011)	Autonomy Package II (10012)
Battery (95 Ah)	x	x
Battery charger	x	x
Central 12V main switch	x	x
Voltage display	x	x
Fan 12V for S 3004	x	
Additional weight (kg)*	31	29



The factory installation of optional equipment increases the actual mass of the vehicle and reduces the payload. The specified additional weight for packages and optional equipment shows the additional weight compared with the standard equipment of the respective model or layout. The total weight of the selected optional equipment must not exceed the mass for optional equipment specified by the manufacturer in the model overviews. This is an imputed

value determined for each model and layout that Dethleffs uses to determine the maximum weight available for factory-installed optional equipment. In the event of an increase of load capacity, the mass for optional equipment specified by the manufacturer is increased. For detailed information and explanations on the topic of weight, please refer to the "Legal notes" section.

Package	Edition 10 Package 415 QL (14232)	Edition 10 Package 475 EL/FR (14232)	Edition 10 Package 495 FR (14232)	Edition 10 Package 495 QSK (14232)	Edition 10 Package 565 FMK (14232)	Edition 10 Package up 465 KR (14234)	Edition 10 Package up 525 KR (14236)
Draw bar cover	x	x	x	x	x	x	x
17" alloy wheels in Dethleffs design (single axle)	x	x	x	x	x	x	x
Corner steadies incl. large-area support feet	x	x	x	x	x	x	x
Hot water supply	x	x	x	x	x	x	x
Flyscreen door	x	x	x	x	x	x	x
Hot air system	x	x	x	x	x	x	x
Heki II skylight incl. illuminated roof lining	x	x	x	x	x	x	x
Weight upgrade 1.700 kg (incl. steel wheel 195 R14 C LI106)	x						
Front window	x	x	x	x	x		
Indirect lighting	x	x	x	x	x	x	x
Shower equipment with shower fittings and curtain	x	x	x	x	x	x	x
ATC Trailer Control	x	x	x	x	x	x	x
Smooth sides white	x	x				x	
Weight upgrade 1.700 kg (incl. steel wheel 195 R14 C LI106)		x					
Smooth sides white			x	x	x		x
Weight upgrade 1.700 kg (incl. steel wheel 195 R14 C LI106)			x				
Weight upgrade 1.700 kg (incl. steel wheel 195 R14 C LI106)				x			
Weight upgrade 1.700 kg (incl. steel wheel 195 R14 C LI106)					x		
Weight upgrade 1.700 kg (incl. steel wheel 195 R14 C LI106)						x	
Weight upgrade 1.800 kg (incl. steel wheel 195 R14 C LI106)							x
Additional weight (kg)*	65	86	94	66	56	55	55

Touring Package (7345)

Hot water supply
Hot air system
Flyscreen door
Heki II skylight incl. illuminated roof lining

Additional weight (kg)*

15

△ Not known at the time of publication



The factory installation of optional equipment increases the actual mass of the vehicle and reduces the payload. The specified additional weight for packages and optional equipment shows the additional weight compared with the standard equipment of the respective model or layout. The total weight of the selected optional equipment must not exceed the mass for optional equipment specified by the manufacturer in the model overviews. This is an imputed

value determined for each model and layout that Dethleffs uses to determine the maximum weight available for factory-installed optional equipment. In the event of an increase of load capacity, the mass for optional equipment specified by the manufacturer is increased. For detailed information and explanations on the topic of weight, please refer to the "Legal notes" section.

Optional equipment**

	Included in package	Additional weight (kg)*	Code	415 QL	475 EL	475 FR	495 FR	495 QSK	565 FMK	up 465 KR	up 525 KR
Chassis											
17" alloy wheels in Dethleffs design (single axle)	ED	1	11608	○	○	○	○	○	○	○	○
Tyres on alloy wheels 185 R14 C LI102, up to and including 1600 kg	—	1	836	○	○	○	○	○	○	○	○
Tyres on alloy wheels 195 R14 C LI106, 1700 kg and 1800 kg	—	1	838	○	○	○	○	○	○	○	○
Weight upgrade											
Weight upgrade 1.700 kg (incl. steel wheel 195 R14 C LI106)	ED	15	278	○	—	—	—	—	—	—	—
Weight upgrade 1.700 kg (incl. steel wheel 195 R14 C LI106)	ED	36	278	—	○	○	—	—	—	—	—
Weight upgrade 1.700 kg (incl. steel wheel 195 R14 C LI106)	ED	6	278	—	—	—	—	—	○	—	—
Weight upgrade 1.700 kg (incl. steel wheel 195 R14 C LI106)	ED	8	278	—	—	—	—	—	—	○	—
Weight upgrade 1.700 kg (incl. steel wheel 195 R14 C LI106)	ED	44	278	—	—	—	○	—	—	—	—
Weight upgrade 1.700 kg (incl. steel wheel 195 R14 C LI106)	ED	16	278	—	—	—	—	○	—	—	—
Weight upgrade 1.800 kg (incl. steel wheel 195 R14 C LI106)	—	6	279	—	—	—	—	—	○	—	—
Weight upgrade 1.800 kg (incl. steel wheel 195 R14 C LI106)	ED	8	279	—	—	—	—	—	—	—	○
Weight upgrade 1.900 kg (incl. alloy wheel 225/70 R15 C LI112)	—	13	394	—	—	—	—	—	○	—	—
Weight upgrade 2.000 kg (incl. alloy wheel 225/70 R15 C LI112)	—	13	138	—	—	—	—	—	○	—	—
Weight upgrade to 1.300 kg	—	0	135	○	—	—	—	—	—	—	—
Weight upgrade to 1.360 kg (without chassis change)	—	0	9619	○	○	○	—	—	—	—	—
Weight upgrade to 1.400 kg	—	0	359	○	○	—	—	○	—	—	—
Weight upgrade to 1.400 kg	—	16	359	—	—	○	—	—	—	—	—
Weight upgrade to 1.400 kg	—	38	359	—	—	—	○	—	—	—	—
Weight upgrade to 1.500 kg	—	16	136	—	—	○	—	—	—	—	—
Weight upgrade to 1.500 kg	—	38	136	—	—	—	○	—	—	—	—
Weight upgrade to 1.500 kg	—	0	136	○	○	—	—	○	—	—	—
Chassis features											
ATC Trailer Control	SHP, ED	4	748	○	○	○	○	○	○	○	○
Corner steadies incl. large-area support feet	ED	4	9138	○	○	○	○	○	○	○	○
Draw bar cover	ED	2	434	○	○	○	○	○	○	○	○
Solid rubber support wheel with support load indicator	—	2	10063	○	○	○	○	○	○	○	○
Spare tyre with alloy wheel 185 R14 C LI 102, up to and including 1.600 kg	—	17	837	○	○	○	○	○	○	○	○
Spare tyre with alloy wheel 195 R14 C 8PR-LI 106, 1.700 kg and 1.800 kg	—	19	839	○	○	○	○	○	○	○	○
Spare tyre with alloy wheel 215/60 R17 C LI 109	—	24.1	11540	○	○	○	○	○	○	○	○
Spare tyre with steel wheel 185 R14 C 8 PR, up to and including 1.600 kg	—	18	831	○	○	○	○	○	○	○	○
Spare tyre with steel wheel 195 R14 C LI 106, 1.700 kg and 1.800 kg	—	20.4	833	○	○	○	○	○	○	○	○
Wheel trims for 14" tyres	—	0.5	276	○	○	○	○	○	○	○	○
Exterior features											
Flyscreen door	TP, ED	3	360	○	○	○	○	○	○	○	○
Front window	ED	3	982	○	○	○	○	○	○	—	—
Heki II skylight incl. illuminated roof lining	TP, ED	10	274	○	○	○	○	○	○	○	○
Kitchen window, sliding (change of window shape)	—	3	6406	○	○	○	○	○	○	○	○
One-piece habitation door with window	—	0	6427	—	—	—	—	—	—	○	○



The factory installation of optional equipment increases the actual mass of the vehicle and reduces the payload. The specified additional weight for packages and optional equipment shows the additional weight compared with the standard equipment of the respective model or layout. The total weight of the selected optional equipment must not exceed the mass for optional equipment specified by the manufacturer in the model overviews. This is an imputed

value determined for each model and layout that Dethleffs uses to determine the maximum weight available for factory-installed optional equipment. In the event of an increase of load capacity, the mass for optional equipment specified by the manufacturer is increased. For detailed information and explanations on the topic of weight, please refer to the "Legal notes" section.

Optional equipment**

	Included in package	Additional weight (kg)*	Code	415 QL	475 EL	475 FR	495 FR	495 QSK	565 FMK	up 465 KR	up 525 KR
Opening window in bathroom	—	2	1028	○	○	○	○	○	○	○	○
Exterior design											
Smooth sides white	ED	17	443	○	○	○	—	—	—	○	—
Smooth sides white	ED	17	443	—	—	—	○	○	○	—	○
Access locker doors											
Access locker door front left side 1000x420 mm	—	2	6415	○	○	—	—	○	●	—	—
Access locker door front right side 1675x885 mm	—	0	9430	—	—	—	—	—	—	—	○
Access locker door front right side 560x1150 mm	—	0	10393	—	—	—	—	—	—	○	—
Access locker door rear left side 749x297 mm	—	2	1077	—	—	—	—	—	—	—	○
Access locker door rear right side 749x297 mm	—	2	1078	—	—	—	—	—	—	○	○
Access locker door rear right side 750x300 mm	—	2	6422	○	—	○	○	—	—	—	—
Interior design											
Upholstery Estepona	—	0	13901	○	○	○	○	○	○	○	○
Upholstery Manilva	—	0	13902	○	○	○	○	○	○	○	○
Textile equipment											
7-zones mattress, made of heat-regulating material	—	0	10318	○	○	○	○	○	○	○	○
Loose carpet	—	7	513	○	○	○	○	○	○	○	○
Furniture layouts											
Bunk bed with 3 sleeping berths, not foldable	—	21	200	—	—	—	—	○	○	—	—
Hanging table with rotating device	—	0	8699	—	—	—	—	○	—	—	—
Seat enlargement for opposite seating lounge (in comb. with option 8699) ³⁾	—	0	7750	—	—	—	—	○	—	—	—
Single beds convert to double bed	—	6	685	—	○	—	—	—	—	—	—
Multimedia											
Multifunctional external connection, 12 V, 220 V, TV and SAT ⁴⁾	—	1	611	○	○	○	○	○	○	○	○
Preparation for flat screen TV (antenna cable and TV bracket)	—	2	678	○	○	○	○	○	○	○	○
Heating											
Electric floor heating	—	6	387	○	○	○	○	○	○	○	○
Fan 12 V with automatic speed control for S 5004	—	2	178	—	—	—	—	—	○	—	—
Fan 12V for S 3004	AP	2	177	○	○	○	○	○	—	○	○
Hot air system	TP, ED	0	142	○	○	○	○	○	○	○	○
Ultraheat additional heating for S 3004, electric 220 V	—	2	364	○	○	○	○	○	—	○	○
Ultraheat additional heating for S 5004, electric 220 V	—	2	422	—	—	—	—	—	○	—	—
Air Conditioning											
Pre-wiring for A/C	—	3.5	172	○	○	○	○	○	○	○	○
Electrical installation											
Indirect lighting	ED	1	633	○	○	○	○	○	○	○	○
USB port for spotlight bar	—	0.5	9989	○	○	○	○	○	○	—	○
Water supply											



The factory installation of optional equipment increases the actual mass of the vehicle and reduces the payload. The specified additional weight for packages and optional equipment shows the additional weight compared with the standard equipment of the respective model or layout. The total weight of the selected optional equipment must not exceed the mass for optional equipment specified by the manufacturer in the model overviews. This is an imputed

value determined for each model and layout that Dethleffs uses to determine the maximum weight available for factory-installed optional equipment. In the event of an increase of load capacity, the mass for optional equipment specified by the manufacturer is increased. For detailed information and explanations on the topic of weight, please refer to the "Legal notes" section.

Optional equipment**

	Included in package	Additional weight (kg)*	Code	415 QL	475 EL	475 FR	495 FR	495 QSK	565 FMK	up 465 KR	up 525 KR
City water connection	—	2	414	—	—	—	—	—	—	○	○
Hot water supply	TP, ED	2	123	○	○	○	○	○	○	○	○
Shower equipment with shower fittings and curtain	ED	3	1097	○	○	○	○	○	○	○	○
Gas supply											
DuoControl safety gas pressure regulator with crash sensor	SHP	0.4	784	○	○	○	○	○	○	○	○
DuoControl safety gas pressure regulator with crash sensor and EisEx gas regulator heater	—	2.5	784	—	—	—	—	—	—	○	○
Gas detection system	—	0.5	10058	○	○	○	○	○	○	○	○
Gas socket (exterior) ⁵⁾	—	1	187	○	○	○	○	○	○	○	○
Packages											
Autonomy Package I ⁶⁾	—	31	10011	○	○	○	○	○	○	○	○
Autonomy Package II	—	29	10012	○	○	○	○	○	○	○	○
Edition 10 Package 415 QL	—	65	14232	○	—	—	—	—	—	—	—
Edition 10 Package 475 EL/FR	—	86	14232	—	○	○	—	—	—	—	—
Edition 10 Package 495 FR	—	94	14232	—	—	—	○	—	—	—	—
Edition 10 Package 495 QSK	—	66	14232	—	—	—	—	○	—	—	—
Edition 10 Package 565 FMK	—	56	14232	—	—	—	—	—	○	—	—
Edition 10 Package up 465 KR	—	55	14234	—	—	—	—	—	—	○	—
Edition 10 Package up 525 KR	—	55	14236	—	—	—	—	—	—	—	○
Safety Package	—	4.4	9556	○	○	○	○	○	○	—	—
Safety Package	—	4.4	9556	—	—	—	—	—	—	○	○
Touring Package	—	15	7345	○	○	○	○	○	○	○	○
Miscellaneous											
Registration documents (CoC papers)	—	0	15151	◆	◆	◆	◆	◆	◆	◆	◆

○ Optional equipment — Not possible ● Standard equipment ◆ Mandatory △ Not known at the time of publication

ED Edition 10 Package SHP Safety Package TP Touring Package AP Autonomy Package



The factory installation of optional equipment increases the actual mass of the vehicle and reduces the payload. The specified additional weight for packages and optional equipment shows the additional weight compared with the standard equipment of the respective model or layout. The total weight of the selected optional equipment must not exceed the mass for optional equipment specified by the manufacturer in the model overviews. This is an imputed

value determined for each model and layout that Dethleffs uses to determine the maximum weight available for factory-installed optional equipment. In the event of an increase of load capacity, the mass for optional equipment specified by the manufacturer is increased. For detailed information and explanations on the topic of weight, please refer to the "Legal notes" section.

Aero & Aero up

Smile please - the Aero has arrived

The traditional classic in an airy, modern Aero look. The curved rear light moulding with recessed integral tail lights almost looks like a smile. Inside, the clear, bright design immediately puts you in a good mood. Sophisticated and popular layout solutions offer maximum space and flexibility. The Aero Up promises even more flexibility with its comfortable pull-down bed above the seating group.

Upholstery



+ Upholstery Fyn



+ Upholstery Skagen

○



+ Upholstery Visby

○

Wood décor

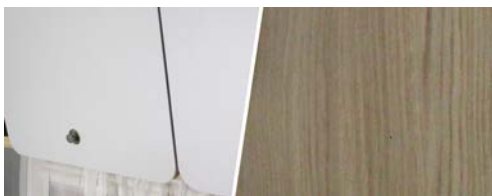

+ Wood décor Maryland Oak

○ optionally available

Technical info

Overall length, approx.	634 - 773 cm
Overall width, approx.	230 cm
Overall height, approx.	261 cm
Headroom in living area, approx.	198 cm

Maximum values partly not possible for all models or only in connection with certain options.

Plus factors

- + I know you: the popular, sophisticated floor plan solutions meet everyone's requirements
- + Winter is coming: be prepared for colder temperatures with the optional Winter Comfort Package
- + Protects you from bad weather: roof, front and rear made of robust GRP
- + A real eye-catcher: the new, modern exterior design turns heads and the interior design has a winning concept
- + Aero up with standard fold-down bed (200 x 140 cm sleeping area) above the seating group

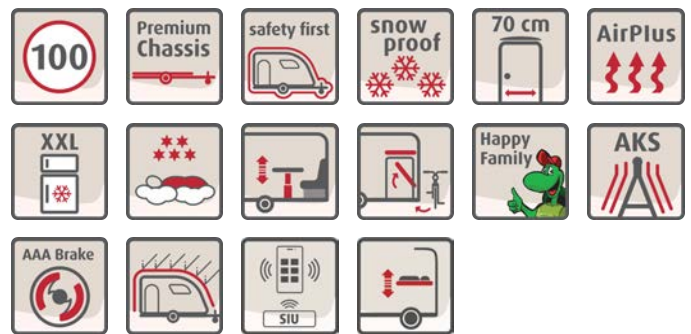

Aero & Aero up

Technical info



Aero & Aero up		410 QS	470 EL	470 FR	470 FSK
Standard chassis		Lightweight chassis, 1300 kg	Lightweight chassis, 1360 kg	Lightweight chassis, 1360 kg	Lightweight chassis, 1360 kg
Overall length, approx.	cm	634	683	695	696
Body length approx.	cm	513	562	575	566
Overall width, approx.	cm	230	230	230	230
Overall height, approx.	cm	261	261	261	261
Circumferential dimension awning approx.	cm	918	971	980	971
Headroom in living area, approx.	cm	198	198	198	198
Thickness floor / side walls / roof	mm	39 / 28 / 28	39 / 28 / 28	39 / 28 / 28	39 / 28 / 28
Tire size		185 R14 8PR	185 R14 8PR	185 R14 8PR	185 R14 8PR
Bed dimension: Front bed, L x W, approx.	cm	210 x 135	210 x 85 / 190 x 85 / 210 - 190 x 210 ○	200 x 145 - 110	200 x 145 - 110
Bed dimension: Central / middle bed, L X W, approx.	cm				190 x 100
Bed dimension: Rear bed, L x W, approx.	cm	190 x 135	210 x 130 - 100	210 x 125	2x 210 x 80 / 2x 210 x 80 ○ / 210 x 70 ○
Sleeping berths standard / max.		3	3	4	5 / 6 ○
Mass in running order (+/-5%)*	kg	1110 (1055 to 1166)*	1240 (1178 to 1302)*	1210 (1150 to 1271)*	1210 (1150 to 1271)*
Manufacturer-specified mass for optional equipment*	kg	109	34	53	43
Technically permissible maximum laden mass*	kg	1300	1360	1360	1360
Heating		S 3004, 3.5 kW Gas / Combi 6 G/E, 6 kW Gas-Electric ○	S 3004, 3.5 kW Gas / Combi 6 G/E, 6 kW Gas-Electric ○	S 3004, 3.5 kW Gas / Combi 6 G/E, 6 kW Gas-Electric ○	Combi 6 G/E, 6 kW Gas-Electric
Refrigerator volume (thereof freezer), approx.	l	78 (11)	137 (15)	137 (15)	137 (15)
Waste water tank, approx.	l	23	23	23	23
Fresh water tank capacity, total/ Fresh water tank capacity at driving filling	l	44 / 15	44 / 15	44 / 15	44 / 15
Sockets: 12 V / 230 V / USB		0 / 8 / 1	0 / 9 / 1	0 / 9 / 1	0 / 9 / 1



* INFO

The specified mass in running order is a standard value defined in the type approval procedure. Due to manufacturing tolerances, the actual weighed mass in running order may deviate from the value stated above. Deviations of up to ± 5% of the mass in running order are legally permissible and possible. The permissible range in kilograms is stated in parentheses after the mass in running order. The mass for optional equipment specified by the manufacturer is an imputed value determined for each type and layout by which Dethleffs specifies the maximum weight available for factory-fitted optional equipment. The purpose of limiting optional equipment is to ensure that the minimum payload, i.e. the legally required free mass for baggage and retrofitted accessories, is actually available for the load capacity of vehicles delivered by

Dethleffs. The actual weight of your vehicle after leaving the factory can only be determined when it is weighed at the end of the line. If, in exceptional cases, the weighing shows that the actual load capacity falls short of the minimum payload due to a permissible weight deviation, despite the limitation of the optional equipment, we will check together with your trading partner and you before delivery of the vehicle whether we should, for example, increase the load capacity of the vehicle or remove optional equipment. The technically permissible maximum laden mass of the vehicle must not be exceeded. For detailed information and explanations on the topic of weight and the configuration of the vehicle, please refer to the "Legal notes" section.

Aero & Aero up

Technical info



Aero & Aero up		490 QSK	500 QSK	510 ER	520 ER
Standard chassis		Lightweight chassis, 1500 kg	Lightweight chassis, 1500 kg	Lightweight chassis, 1500 kg	Lightweight chassis, 1500 kg
Overall length, approx.	cm	720	726	731	751
Body length approx.	cm	595	605	615	635
Overall width, approx.	cm	230	230	230	230
Overall height, approx.	cm	261	261	261	261
Circumferential dimension awning approx.	cm	1000	1010	1020	1040
Headroom in living area, approx.	cm	198	198	198	198
Thickness floor / side walls / roof	mm	39 / 28 / 28	39 / 28 / 28	39 / 28 / 28	39 / 28 / 28
Tire size		185 R14 8PR	185 R14 8PR	185 R14 8PR	185 R14 8PR
Bed dimension: Front bed, L x W, approx.	cm	210 x 135	210 x 145	200 x 85 / 190 x 85 / 200 x 195 ○	200 x 85 / 195 x 85 / 200 x 195 ○
Bed dimension: Central / middle bed, L X W, approx.	cm	200 x 90	190 x 90		
Bed dimension: Rear bed, L x W, approx.	cm	2x 180 x 70 / 2x 180 x 70 ○ / 165 x 65 ○	2x 210 x 80 / 2x 210 x 80 ○ / 210 x 70 ○	210 x 145 - 90	210 x 145 - 125
Sleeping berths standard / max.		5 / 6 ○	5 / 6 ○	4	4
Mass in running order (+/-5%)*	kg	1270 (1207 to 1334)*	1270 (1207 to 1334)*	1300 (1235 to 1365)*	1330 (1264 to 1397)*
Manufacturer-specified mass for optional equipment*	kg	121	120	99	67
Technically permissible maximum laden mass*	kg	1500	1500	1500	1500
Heating		S 3004, 3.5 kW Gas / Combi 6 G/E, 6 kW Gas-Electric ○	S 3004, 3.5 kW Gas / Combi 6 G/E, 6 kW Gas-Electric ○	S 3004, 3.5 kW Gas / Combi 6 G/E, 6 kW Gas-Electric ○	S 3004, 3.5 kW Gas / Combi 6 G/E, 6 kW Gas-Electric ○
Refrigerator volume (thereof freezer), approx.	l	137 (15)	137 (15)	137 (15)	137 (15)
Waste water tank, approx.	l	23	23	23	23
Fresh water tank capacity, total/ Fresh water tank capacity at driving filling	l	44 / 15	44 / 15	44 / 15	44 / 15
Sockets: 12 V / 230 V / USB		0 / 9 / 1	0 / 9 / 1	0 / 9 / 1	0 / 9 / 1



* INFO

The specified mass in running order is a standard value defined in the type approval procedure. Due to manufacturing tolerances, the actual weighed mass in running order may deviate from the value stated above. Deviations of up to ± 5% of the mass in running order are legally permissible and possible. The permissible range in kilograms is stated in parentheses after the mass in running order. The mass for optional equipment specified by the manufacturer is an imputed value determined for each type and layout by which Dethleffs specifies the maximum weight available for factory-fitted optional equipment. The purpose of limiting optional equipment is to ensure that the minimum payload, i.e. the legally required free mass for baggage and retrofitted accessories, is actually available for the load capacity of vehicles delivered by

Dethleffs. The actual weight of your vehicle after leaving the factory can only be determined when it is weighed at the end of the line. If, in exceptional cases, the weighing shows that the actual load capacity falls short of the minimum payload due to a permissible weight deviation, despite the limitation of the optional equipment, we will check together with your trading partner and you before delivery of the vehicle whether we should, for example, increase the load capacity of the vehicle or remove optional equipment. The technically permissible maximum laden mass of the vehicle must not be exceeded. For detailed information and explanations on the topic of weight and the configuration of the vehicle, please refer to the "Legal notes" section.

Aero & Aero up

Technical info



Aero & Aero up		up 460 KR	up 530 ER	up 530 KR
Standard chassis		Lightweight chassis, 1600 kg	Lightweight chassis, 1600 kg	Lightweight chassis, 1600 kg
Overall length, approx.	cm	680	773	771
Body length approx.	cm	556	648	648
Overall width, approx.	cm	230	230	230
Overall height, approx.	cm	261	261	261
Circumferential dimension awning approx.	cm	972	1065	1065
Headroom in living area, approx.	cm	198	198	198
Thickness floor / side walls / roof	mm	39 / 28 / 28	39 / 28 / 28	39 / 28 / 28
Tire size		185 R14 8PR	185 R14 8PR	185 R14 8PR
Bed dimension: Front bed, L x W, approx.	cm	210 x 73 / 213 x 91	2x 205 x 88 / 205 x 208 ○	200 x 74 / 205 x 77 / 177 x 69
Bed dimension: Central / middle bed, L X W, approx.	cm			
Bed dimension: Rear bed, L x W, approx.	cm	200 x 144 / 213 x 155	200 x 144 / 213 x 155	200 x 144 / 213 x 155
Sleeping berths standard / max.		4	4	4
Mass in running order (+/-5%)*	kg	1290 (1226 to 1355)*	1405 (1335 to 1475)*	1405 (1335 to 1475)*
Manufacturer-specified mass for optional equipment*	kg	114	90	90
Technically permissible maximum laden mass*	kg	1500	1600	1600
Heating		S 3004, 3.5 kW Gas / Combi 6 G/E, 6 kW Gas-Electric ○	S 3004, 3.5 kW Gas / Combi 6 G/E, 6 kW Gas-Electric ○	S 3004, 3.5 kW Gas / Combi 6 G/E, 6 kW Gas-Electric ○
Refrigerator volume (thereof freezer), approx.	l	137 (15)	137 (15)	137 (15)
Waste water tank, approx.	l	23	23	23
Fresh water tank capacity, total/ Fresh water tank capacity at driving filling	l	44 / 15	41 / 15	44 / 15
Sockets: 12 V / 230 V / USB		0 / 5 / 1	0 / 9 / 1	0 / 9 / 1

○ Optional equipment — Not possible ● Standard equipment ◆ Mandatory △ Not known at the time of publication



The specified mass in running order is a standard value defined in the type approval procedure. Due to manufacturing tolerances, the actual weighed mass in running order may deviate from the value stated above. Deviations of up to ± 5% of the mass in running order are legally permissible and possible. The permissible range in kilograms is stated in parentheses after the mass in running order. The mass for optional equipment specified by the manufacturer is an imputed value determined for each type and layout by which Dethleffs specifies the maximum weight available for factory-fitted optional equipment. The purpose of limiting optional equipment is to ensure that the minimum payload, i.e. the legally required free mass for baggage and retrofitted accessories, is actually available for the load capacity of vehicles delivered by

Dethleffs. The actual weight of your vehicle after leaving the factory can only be determined when it is weighed at the end of the line. If, in exceptional cases, the weighing shows that the actual load capacity falls short of the minimum payload due to a permissible weight deviation, despite the limitation of the optional equipment, we will check together with your trading partner and you before delivery of the vehicle whether we should, for example, increase the load capacity of the vehicle or remove optional equipment. The technically permissible maximum laden mass of the vehicle must not be exceeded. For detailed information and explanations on the topic of weight and the configuration of the vehicle, please refer to the "Legal notes" section.

Standard equipment

	410 QS	470 EL	470 FR	470 FSK	490 QSK	500 QSK	510 ER	520 ER	up 460 KR	up 530 ER	up 530 KR
Chassis											
Tyres on steel wheels 185 R14 C 8 PR, up to and including 1.600 kg	●	●	●	●	●	●	●	●	●	●	●
Zinc-plated chassis with inertia braking system with reversing automatic	●	●	●	●	●	●	●	●	●	●	●
Chassis features											
AAA self-adjusting brake	—	—	—	—	—	—	—	—	●	●	●
ACS stabiliser	●	●	●	●	●	●	●	●	●	●	●
High-quality brand-name tyres, designed for a speed of 100 km/h	●	●	●	●	●	●	●	●	●	●	●
Lightweight zinc-plated corner steadies	●	●	●	●	●	●	●	●	●	●	●
Octagon shock absorber	●	●	●	●	●	●	●	●	●	●	●
Exterior features											
Floor of the gas bottle locker made of rot-resistant and robust corrugated aluminium	●	●	●	●	●	●	●	●	●	●	●
Front, rear and roof made of robust GRP	●	●	●	●	●	●	●	●	●	●	●
Opening window in bathroom	●	●	●	●	●	●	●	●	●	●	●
Opening windows, insulated and double-glazed (graphite grey) with blackout and mosquito blinds	●	●	●	●	●	●	●	●	●	●	●
Rear window	●	●	●	●	—	●	●	●	●	●	●
Skylight incl. illumination, 400 x 400 mm	●	●	●	●	●	●	●	●	●	●	●
Skylight, 400 x 400 mm	●	●	●	●	●	●	●	●	●	●	●
Space-saving gas locker door which opens upwards	●	●	●	●	●	●	●	●	●	●	●
Spare wheel carrier in gas locker	●	●	●	●	●	●	●	●	●	●	●
Storage space for 2 gas bottles with 11 kg filling weight each	●	●	●	●	●	●	●	●	●	●	●
Wide, one-piece habitation door with window	●	●	●	●	●	●	●	●	●	●	●
Exterior design											
Design element for front	●	●	●	●	●	●	●	●	●	●	●
Design element for rear	●	●	●	●	●	●	●	●	●	●	●
Sides in hammer finish, white	●	●	●	●	●	●	●	●	●	●	●
Access locker doors											
Access locker door front right side 1000x420 mm	●	●	●	—	●	●	●	●	—	●	—
Access locker door front right side 1675x885 mm	—	—	—	—	—	—	—	—	—	—	●
Access locker door front right side 560x1150 mm	—	—	—	—	—	—	—	—	●	—	—
Access locker door rear left side 1000x420 mm ⁷⁾	—	—	—	—	●	—	—	—	—	—	—
Interior design											
Upholstery Fyn	●	●	●	●	●	●	●	●	●	●	●
Wood décor Maryland Oak	●	●	●	●	●	●	●	●	●	●	●
Textile equipment											
7-zones mattress, made of heat-regulating material	●	●	●	●	●	●	●	●	●	●	●
Furniture layouts											
AirPlus - perfect air circulation in the interior and rear ventilation of the overhead lockers and sideboards	●	●	●	●	●	●	●	●	●	●	●
Bunk bed with 2 sleeping berths, foldable	—	—	—	●	●	●	—	—	●	—	●
Bunk beds with safety net and ladder	—	—	—	●	●	●	—	—	●	—	●
One-legged telescopic table, height adjustable	—	—	●	—	—	—	●	●	●	●	●
Seating lounge converts to bed	●	●	●	●	●	●	●	●	●	●	●
Spacious pull-down bed above seating lounge, with manual control	—	—	—	—	—	—	—	—	●	●	●
Special slatted frame with flexible natural rubber holders, opening for optimal use of storage compartments under the beds	●	●	●	●	●	●	●	●	—	—	—
Interior features											
Smoke detector	●	●	●	●	●	●	●	●	●	●	●
Kitchen											
Generous drawers with soft closing for absolutely silent closing	●	●	●	●	●	●	●	●	●	●	●
Large fridge with 137 liters capacity and 15 liters freezer compartment	—	●	●	●	●	●	●	●	●	●	●
Practical 3-flames cooker with electric ignition	●	●	●	●	●	●	●	●	●	●	●
Spacious fridge with 78 liters volume and 11 liters freezer compartment	●	—	—	—	—	—	—	—	—	—	—

Standard equipment

	410 QS	470 EL	470 FR	470 FSK	490 QSK	500 QSK	510 ER	520 ER	up 460 KR	up 530 ER	up 530 KR
Bathroom											
Integrated design washbasin made of solid surface material	●	●	●	●	●	●	●	●	●	●	●
Shower tray	●	●	●	●	●	●	●	●	●	●	●
Skylight with mosquito net	●	●	●	●	●	●	●	●	●	●	●
Heating											
Gas heating S 3004 with automatic ignition	●	●	●	—	●	●	●	●	●	●	●
Electrical installation											
12 V power supply throughout vehicle	●	●	●	●	●	●	●	●	●	●	●
Additional lighting through LED spotlights	●	●	●	●	●	●	●	●	●	●	●
Awning light 12V	●	●	●	●	●	●	●	●	●	●	●
CEE external output socket for 230V on-board electrics	●	●	●	●	●	●	●	●	●	●	●
Compact power distribution unit with 230V safety device and 12V fuse box in wardrobe incl. powerful 340W transformer	●	●	●	●	●	●	●	●	●	●	●
LED spots in front and rear seating lounges	●	●	●	●	●	●	●	●	●	●	●
USB port for spotlight bar	●	●	●	●	●	●	●	●	●	●	●
Water supply											
Electric water supply	●	●	●	●	●	●	●	●	●	●	●
Fresh water tank 44 l	●	●	●	●	●	●	●	●	●	●	●
Mobile 22 l waste water tank	●	●	●	●	●	●	●	●	●	●	●
Miscellaneous											
Dethleffs Connect - System Information Unit: SIU control unit incl. voltage and levelling display via the Dethleffs app.	●	●	●	●	●	●	●	●	●	●	●

Packages Aero & Aero up

Package	Styling Package white (13252)	Styling Package white (13252)
Smooth sides white	x	
17" alloy wheels in Dethleffs design (single axle)	x	x
Draw bar cover	x	x
Corner steadies incl. large-area support feet	x	x
Solid rubber support wheel with support load indicator	x	x
Smooth sides white		x
Additional weight (kg)*	26	26

Package	Safety Package (9556)
ATC Trailer Control	x
DuoControl safety gas pressure regulator with crash sensor and EisEx gas regulator heater	x
Additional weight (kg)*	4.4

Package	Autonomy Package I (10011)	Autonomy Package II (10012)
Battery (95 Ah)	x	x
Battery charger	x	x
Central 12V main switch	x	x
Voltage display	x	x
Fan 12V for S 3004	x	
Additional weight (kg)*	31	29

Package	Winter Comfort Package (11547)	Winter Comfort Package (11547)	Winter Comfort Package for Combi heating (13028)
Hot air heating Combi 6 G/E incl. digital control unit	x	x	
Electric floor heating	x	x	x
XPS insulation for front, rear and sides (depending on vehicle size)	x		x
XPS insulation for front, rear and sides (depending on vehicle size)		x	
Additional weight (kg)*	21	21	6



The factory installation of optional equipment increases the actual mass of the vehicle and reduces the payload. The specified additional weight for packages and optional equipment shows the additional weight compared with the standard equipment of the respective model or layout. The total weight of the selected optional equipment must not exceed the mass for optional equipment specified by the manufacturer in the model overviews. This is an imputed

value determined for each model and layout that Dethleffs uses to determine the maximum weight available for factory-installed optional equipment. In the event of an increase of load capacity, the mass for optional equipment specified by the manufacturer is increased. For detailed information and explanations on the topic of weight, please refer to the "Legal notes" section.

Package	Touring Package (13251)	Touring Package (13411)
Hot water supply	x	
Flyscreen door	x	x
Hot air system	x	x
Skylight incl. illumination, 700 x 500 mm	x	x
Additional weight (kg)*	15	13

Shower Package (6105)

City water connection

Shower equipment with shower fittings and curtain

Additional weight (kg)*	5
-------------------------	---

△ Not known at the time of publication



The factory installation of optional equipment increases the actual mass of the vehicle and reduces the payload. The specified additional weight for packages and optional equipment shows the additional weight compared with the standard equipment of the respective model or layout. The total weight of the selected optional equipment must not exceed the mass for optional equipment specified by the manufacturer in the model overviews. This is an imputed

value determined for each model and layout that Dethleffs uses to determine the maximum weight available for factory-installed optional equipment. In the event of an increase of load capacity, the mass for optional equipment specified by the manufacturer is increased. For detailed information and explanations on the topic of weight, please refer to the "Legal notes" section.

Optional equipment**

	Included in package	Additional weight (kg)*	Code	410 QS	470 EL	470 FR	470 FSK	490 QSK	500 QSK	510 ER	520 ER	up 460 KR	up 530 ER	up 530 KR
Chassis														
17" alloy wheels in Dethleffs design (single axle)	STP	1	11608	○	○	○	○	○	○	○	○	○	○	○
Tyres on alloy wheels 185 R14 C LI102, up to and including 1600 kg	—	1	836	○	○	○	○	○	○	○	○	○	○	○
Tyres on alloy wheels 195 R14 C LI106, 1700 kg and 1800 kg	—	1	838	○	○	○	○	○	○	○	○	○	○	○
Weight upgrade														
Weight upgrade 1.700 kg (incl. steel wheel 195 R14 C LI106)	—	36	278	○	—	○	○	—	—	—	—	—	—	—
Weight upgrade 1.700 kg (incl. steel wheel 195 R14 C LI106)	—	8	278	—	—	—	—	○	○	○	○	—	—	—
Weight upgrade 1.700 kg (incl. steel wheel 195 R14 C LI106)	—	7	278	—	—	—	—	—	—	—	—	○	○	—
Weight upgrade 1.700 kg (incl. steel wheel 195 R14 C LI106)	—	6	278	—	—	—	—	—	—	—	—	—	—	○
Weight upgrade 1.700 kg (incl. steel wheel 195 R14 C LI106)	—	35	278	—	○	—	—	—	—	—	—	—	—	—
Weight upgrade 1.800 kg (incl. steel wheel 195 R14 C LI106)	—	8	279	—	—	—	—	○	○	○	○	—	—	—
Weight upgrade 1.800 kg (incl. steel wheel 195 R14 C LI106)	—	6	279	—	—	—	—	—	—	—	—	—	—	○
Weight upgrade 1.800 kg (incl. steel wheel 195 R14 C LI106)	—	7	279	—	—	—	—	—	—	—	—	○	○	—
Weight upgrade 1.900 kg (incl. alloy wheel 225/70 R15 C LI112)	—	27	394	—	—	—	—	—	—	—	—	—	○	○
Weight upgrade 2.000 kg (incl. alloy wheel 225/70 R15 C LI112)	—	27	138	—	—	—	—	—	—	—	—	—	○	○
Weight upgrade to 1.360 kg (without chassis change)	—	0	9619	○	—	—	—	—	—	—	—	—	—	—
Weight upgrade to 1.400 kg	—	0	359	○	○	○	○	—	—	—	—	—	—	—
Weight upgrade to 1.500 kg	—	0	136	○	○	○	○	—	—	—	—	—	—	—
Weight upgrade to 1.600 kg	—	0	322	—	—	—	—	—	—	—	—	○	—	—
Chassis features														
ATC Trailer Control	SHP	4	748	○	○	○	○	○	○	○	○	○	○	○
Corner steadies incl. large-area support feet	STP	4	9138	○	○	○	○	○	○	○	○	○	○	○
Draw bar cover	STP	2	434	○	○	○	○	○	○	○	○	○	○	○
Solid rubber support wheel with support load indicator	STP	2	10063	○	○	○	○	○	○	○	○	○	○	○
Spare tyre with alloy wheel 185 R14 C LI 102, up to and including 1.600 kg	—	17	837	○	○	○	○	○	○	—	○	○	○	○
Spare tyre with alloy wheel 195 R14 C 8PR-LI 106, 1.700 kg and 1.800 kg	—	19	839	—	○	○	○	○	○	—	○	○	○	○
Spare tyre with alloy wheel 215/60 R17 C LI 109	—	24.1	11540	○	○	○	○	○	○	—	○	—	—	—
Spare tyre with alloy wheel 225/70 R15 C LI 112 , 1.900 kg and 2.000 kg	—	23.5	1092	—	—	—	—	—	—	—	—	—	○	○
Spare tyre with steel wheel 185 R14 C 8 PR, up to and including 1.600 kg	—	18	831	○	○	○	○	○	○	—	○	○	○	○
Spare tyre with steel wheel 195 R14 C LI 106, 1.700 kg and 1.800 kg	—	20.4	833	—	○	○	○	○	○	—	○	○	○	○
Wheel trims for 14" tyres	—	0.5	276	○	○	○	○	○	○	○	○	○	○	○
Exterior features														
Flyscreen door	TP	3	360	○	○	○	○	○	○	○	○	○	○	○
Front window	—	3	982	○	○	○	○	○	○	○	○	—	○	○
Kitchen window, sliding (change of window shape)	—	3	6406	○	○	○	○	○	○	○	○	○	○	○
Skylight incl. illumination, 700 x 500 mm	TP	10	11575	○	○	○	○	○	○	○	○	○	○	○
Exterior design														
Smooth sides white	STP	17	443	○	○	○	○	—	—	—	—	○	—	—
Smooth sides white	STP	17	443	—	—	—	—	○	○	○	○	—	○	○
Access locker doors														
Access locker door front left side 1000x420 mm	—	2	6415	○	○	—	●	○	○	○	○	—	○	—



The factory installation of optional equipment increases the actual mass of the vehicle and reduces the payload. The specified additional weight for packages and optional equipment shows the additional weight compared with the standard equipment of the respective model or layout. The total weight of the selected optional equipment must not exceed the mass for optional equipment specified by the manufacturer in the model overviews. This is an imputed

value determined for each model and layout that Dethleffs uses to determine the maximum weight available for factory-installed optional equipment. In the event of an increase of load capacity, the mass for optional equipment specified by the manufacturer is increased. For detailed information and explanations on the topic of weight, please refer to the "Legal notes" section.

Optional equipment**

	Included in package	Additional weight (kg)*	Code	410 QS	470 EL	470 FR	470 FSK	490 QSK	500 QSK	510 ER	520 ER	up 460 KR	up 530 ER	up 530 KR
Access locker door rear left 1675x885 mm ⁷⁾	—	0	10848	—	—	—	—	○	—	—	—	—	—	—
Access locker door rear right side 560x1150 mm	—	2.5	991	—	—	—	—	—	○	—	—	—	—	—
Access locker door rear right side 750x300 mm	—	2	6422	—	—	○	—	—	—	—	—	●	●	●
Interior design														
Upholstery Skagen	—	0	11522	○	○	○	○	○	○	○	○	○	○	○
Upholstery Visby	—	0	11523	○	○	○	○	○	○	○	○	○	○	○
Textile equipment														
Loose carpet	—	7	513	○	○	○	○	○	○	○	○	○	○	○
Furniture layouts														
Bunk bed with 3 sleeping berths, not foldable	—	21	200	—	—	—	○	○	○	—	—	—	—	—
Hanging table with rotating device	—	0	8699	○	—	—	—	○	○	—	—	—	—	—
Seat enlargement for opposite seating lounge (in comb. with option 8699) ³⁾	—	0	7750	○	—	—	—	○	○	—	—	—	—	—
Single beds convert to double bed	—	6	685	—	○	—	—	—	—	○	○	—	○	—
Multimedia														
Multifunctional external connection, 12 V, 220 V, TV and SAT ⁴⁾	—	1	611	○	○	○	○	○	○	○	○	○	○	○
Preparation for flat screen TV (antenna cable and TV bracket)	—	2	678	○	○	○	○	○	○	○	○	○	○	○
Heating														
Electric floor heating	WI-KO	6	387	○	○	○	○	○	○	○	○	○	○	○
Fan 12V for S 3004	AP	2	177	○	○	○	—	○	○	○	○	○	○	○
Hot air heating Combi 6 G/E incl. digital control unit	WI-KO	15	9427	○	○	○	●	○	○	○	○	○	○	○
Hot air system	TP	0	142	○	○	○	○	○	○	○	○	○	○	○
Ultraheat additional heating for S 3004, electric 220 V	—	2	364	○	○	○	—	○	○	○	○	○	○	○
Air Conditioning														
Pre-wiring for A/C	—	3.5	172	○	○	○	○	○	○	○	○	○	○	○
Roof A/C	—	37	6512	○	○	○	○	○	○	○	○	○	○	○
Electrical installation														
Indirect lighting	—	1	633	○	○	○	○	○	○	○	○	○	○	○
Water supply														
City water connection	DUP	2	414	○	○	○	○	○	○	○	○	○	○	○
Hot water supply	TP	2	123	○	○	○	—	○	○	○	○	○	○	○
Shower equipment with shower fittings and curtain	DUP	3	1097	○	○	○	○	○	○	○	○	○	○	○
Gas supply														
DuoControl safety gas pressure regulator with crash sensor and EisEx gas regulator heater	SHP	0.4	784	○	○	○	○	○	○	○	○	○	○	○
Gas detection system	—	0.5	10058	○	○	○	○	○	○	○	○	○	○	○
Gas socket (exterior) ⁵⁾	—	1	187	○	○	○	○	○	○	○	○	○	○	○
Packages														
Autonomy Package I	—	31	10011	○	○	○	—	○	○	○	○	○	○	○
Autonomy Package II	—	29	10012	○	○	○	○	○	○	○	○	○	○	○
Safety Package	—	4.4	9556	○	○	○	○	○	○	○	○	○	○	○
Shower Package	—	5	6105	○	○	○	○	○	○	○	○	○	○	○
Styling Package white	—	26	13252	○	○	○	○	—	—	—	—	○	—	—



The factory installation of optional equipment increases the actual mass of the vehicle and reduces the payload. The specified additional weight for packages and optional equipment shows the additional weight compared with the standard equipment of the respective model or layout. The total weight of the selected optional equipment must not exceed the mass for optional equipment specified by the manufacturer in the model overviews. This is an imputed

value determined for each model and layout that Dethleffs uses to determine the maximum weight available for factory-installed optional equipment. In the event of an increase of load capacity, the mass for optional equipment specified by the manufacturer is increased. For detailed information and explanations on the topic of weight, please refer to the "Legal notes" section.

Optional equipment**

	Included in package	Additional weight (kg)*	Code	410 QS	470 EL	470 FR	470 FSK	490 QSK	500 QSK	510 ER	520 ER	up 460 KR	up 530 ER	up 530 KR
Styling Package white	—	26	13252	—	—	—	—	○	○	○	○	—	○	○
Touring Package	—	13	13411	—	—	—	○	—	—	—	—	—	—	—
Touring Package	—	15	13251	○	○	○	—	○	○	○	○	○	○	○
Winter Comfort Package	—	21	11547	○	○	○	—	—	—	—	—	○	—	—
Winter Comfort Package	—	21	11547	—	—	—	—	○	○	○	○	—	○	○
Winter Comfort Package for Combi heating	—	6	13028	—	—	—	○	—	—	—	—	—	—	—
Miscellaneous														
Registration documents (CoC papers)	—	0	15151	◆	◆	◆	◆	◆	◆	◆	◆	◆	◆	◆

○ Optional equipment — Not possible ● Standard equipment ◆ Mandatory △ Not known at the time of publication

STP Styling Package SHP Safety Package TP Touring Package WI-KO Winter Comfort Package AP Autonomy Package DUP Shower Package



The factory installation of optional equipment increases the actual mass of the vehicle and reduces the payload. The specified additional weight for packages and optional equipment shows the additional weight compared with the standard equipment of the respective model or layout. The total weight of the selected optional equipment must not exceed the mass for optional equipment specified by the manufacturer in the model overviews. This is an imputed

value determined for each model and layout that Dethleffs uses to determine the maximum weight available for factory-installed optional equipment. In the event of an increase of load capacity, the mass for optional equipment specified by the manufacturer is increased. For detailed information and explanations on the topic of weight, please refer to the "Legal notes" section.

Camper®

The family caravan

With its extensive standard equipment, abundant storage space and a wide range of bunk bed layouts and compact designs, the Camper® is the ideal caravan for all those of you who love adventure.

Upholstery



+ Upholstery Cloud



+ Upholstery Galaxy

○



+ Upholstery Mount

○

Wood décor



+ Wood décor Rosario Cherry

○ optionally available

Technical info

Overall length, approx.	691 - 942 cm
Overall width, approx.	230 - 250 cm
Overall height, approx.	265 cm
Headroom in living area, approx.	198 cm

Maximum values partly not possible for all models or only in connection with certain options.

Plus factors

- + Enough space for every child: a selection of family layouts with bunk beds
- + Better safe than sorry: exemplary Dethleffs safety equipment
- + Good as standard: ready to go thanks to comprehensive specifications
- + Modern interior: three classic upholstery options
- + Kitted out for all needs: our portfolio even features short caravans less than 7 m in length

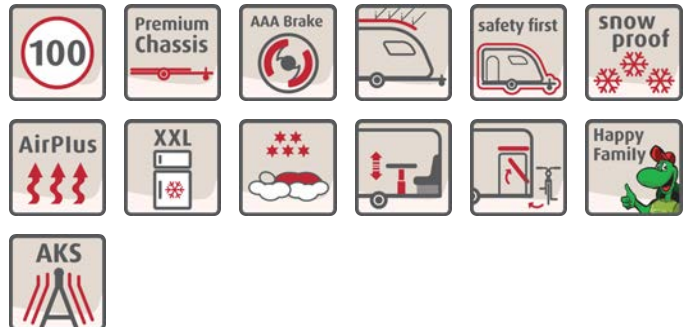

Camper®

Technical info

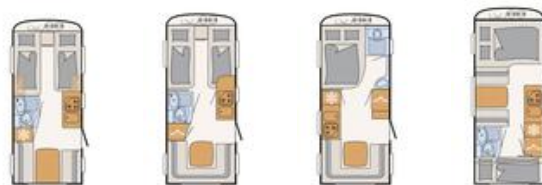

Camper®		460 EL	470 ER	470 FR	500 QSK
Standard chassis		Lightweight chassis, 1500 kg	Lightweight chassis, 1500 kg	Lightweight chassis, 1500 kg	Lightweight chassis, 1500 kg
Overall length, approx.	cm	691	713	713	729
Body length approx.	cm	550	570	570	590
Overall width, approx.	cm	230	230	230	230
Overall height, approx.	cm	265	265	265	265
Circumferential dimension awning approx.	cm	948	968	968	988
Headroom in living area, approx.	cm	198	198	198	198
Thickness floor / side walls / roof	mm	42 / 34 / 34	42 / 34 / 34	42 / 34 / 34	42 / 34 / 34
Tire size		185 R14C 8PR	185 R14C 8PR	185 R14C 8PR	185 R14C 8PR
Bed dimension: Front bed, L x W, approx.	cm	200 x 85 / 190 x 85 / 190 x 210 ○	2x 200 x 85 / 200 x 210 ○	205 x 135	210 x 135
Bed dimension: Central / middle bed, L X W, approx.	cm				190 x 100
Bed dimension: Rear bed, L x W, approx.	cm	210 x 115	210 x 125	210 x 135	210 x 70 / 195 x 75 / 210 x 75 ○ / 210 x 80 ○ / 210 x 70 ○
Sleeping berths standard / max.		3	3	4	5 / 6 ○
Mass in running order (+/-5%)*	kg	1235 (1173 to 1297)*	1225 (1164 to 1286)*	1245 (1183 to 1307)*	1295 (1230 to 1360)*
Manufacturer-specified mass for optional equipment*	kg	180	188	158	96
Technically permissible maximum laden mass*	kg	1500	1500	1500	1500
Heating		S 3004, 3.5 kW Gas / Combi 4 G/E, 4 kW Gas-Electric ○	S 3004, 3.5 kW Gas / Combi 4 G/E, 4 kW Gas-Electric ○	S 3004, 3.5 kW Gas / Combi 4 G/E, 4 kW Gas-Electric ○	S 3004, 3.5 kW Gas / Combi 4 G/E, 4 kW Gas-Electric ○
Refrigerator volume (thereof freezer), approx.	l	137 (15)	86 (11)	137 (15)	137 (15)
Waste water tank, approx.	l	22	22	22	22
Fresh water tank capacity, total/ Fresh water tank capacity at driving filling	l	43 / 15	43 / 15	43 / 15	43 / 15



* INFO

The specified mass in running order is a standard value defined in the type approval procedure. Due to manufacturing tolerances, the actual weighed mass in running order may deviate from the value stated above. Deviations of up to ± 5% of the mass in running order are legally permissible and possible. The permissible range in kilograms is stated in parentheses after the mass in running order. The mass for optional equipment specified by the manufacturer is an imputed value determined for each type and layout by which Dethleffs specifies the maximum weight available for factory-fitted optional equipment. The purpose of limiting optional equipment is to ensure that the minimum payload, i.e. the legally required free mass for baggage and retrofitted accessories, is actually available for the load capacity of vehicles delivered by

Dethleffs. The actual weight of your vehicle after leaving the factory can only be determined when it is weighed at the end of the line. If, in exceptional cases, the weighing shows that the actual load capacity falls short of the minimum payload due to a permissible weight deviation, despite the limitation of the optional equipment, we will check together with your trading partner and you before delivery of the vehicle whether we should, for example, increase the load capacity of the vehicle or remove optional equipment. The technically permissible maximum laden mass of the vehicle must not be exceeded. For detailed information and explanations on the topic of weight and the configuration of the vehicle, please refer to the "Legal notes" section.

Camper®

Technical info

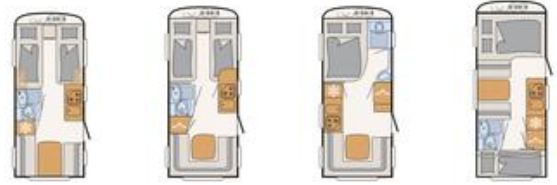

Camper®	460 EL	470 ER	470 FR	500 QSK
Sockets: 12 V / 230 V / USB	0 / 7 / 1	0 / 9 / 1	0 / 8 / 1	0 / 8 / 3

* INFO

The specified mass in running order is a standard value defined in the type approval procedure. Due to manufacturing tolerances, the actual weighed mass in running order may deviate from the value stated above. Deviations of up to $\pm 5\%$ of the mass in running order are legally permissible and possible. The permissible range in kilograms is stated in parentheses after the mass in running order. The mass for optional equipment specified by the manufacturer is an imputed value determined for each type and layout by which Dethleffs specifies the maximum weight available for factory-fitted optional equipment. The purpose of limiting optional equipment is to ensure that the minimum payload, i.e. the legally required free mass for baggage and retrofitted accessories, is actually available for the load capacity of vehicles delivered by

Dethleffs. The actual weight of your vehicle after leaving the factory can only be determined when it is weighed at the end of the line. If, in exceptional cases, the weighing shows that the actual load capacity falls short of the minimum payload due to a permissible weight deviation, despite the limitation of the optional equipment, we will check together with your trading partner and you before delivery of the vehicle whether we should, for example, increase the load capacity of the vehicle or remove optional equipment. The technically permissible maximum laden mass of the vehicle must not be exceeded. For detailed information and explanations on the topic of weight and the configuration of the vehicle, please refer to the "Legal notes" section.

Camper®

Technical info



Camper®		510 ER	510 LE	530 FSK	540 QMK
Standard chassis		Lightweight chassis, 1500 kg	Lightweight chassis, 1600 kg	Lightweight chassis, 1600 kg	Lightweight chassis, 1700 kg
Overall length, approx.	cm	766	762	788	768
Body length approx.	cm	620	630	650	650
Overall width, approx.	cm	230	230	230	250
Overall height, approx.	cm	265	265	265	265
Circumferential dimension awning approx.	cm	1018	1028	1048	1048
Headroom in living area, approx.	cm	198	198	198	198
Thickness floor / side walls / roof	mm	42 / 34 / 34	42 / 34 / 34	42 / 34 / 34	42 / 34 / 34
Tire size		185 R14C 8PR	185 R14C 8PR	185 R14C 8PR	195 R14C LI106
Bed dimension: Front bed, L x W, approx.	cm	200 x 85 / 190 x 85 / 190 x 210 ○	210 x 135	200 x 135	200 x 140
Bed dimension: Central / middle bed, L X W, approx.	cm			190 x 100	230 x 115
Bed dimension: Rear bed, L x W, approx.	cm	210 x 135	2x 200 x 85 / 195 x 210 ○	210 x 70 / 195 x 75 / 210 x 75 ○ / 210 x 80 ○ / 210 x 70 ○	190 x 75 / 190 x 70 / 2x 190 x 75 ○ / 170 x 75 ○
Sleeping berths standard / max.		4	4	5 / 6 ○	5 / 6 ○
Mass in running order (+/-5%)*	kg	1310 (1245 to 1376)*	1315 (1249 to 1381)*	1385 (1316 to 1454)*	1475 (1401 to 1549)*
Manufacturer-specified mass for optional equipment*	kg	88	182	100	110
Technically permissible maximum laden mass*	kg	1500	1600	1600	1700
Heating		S 3004, 3.5 kW Gas / Combi 4 G/E, 4 kW Gas-Electric ○	S 3004, 3.5 kW Gas / Combi 4 G/E, 4 kW Gas-Electric ○	S 5004, 6 kW Gas / Combi 6 G/E, 6 kW Gas-Electric ○ / Hot water heating, 6.4 kW Gas-Electric ○	S 5004, 6 kW Gas / Combi 6 G/E, 6 kW Gas-Electric ○ / Hot water heating, 6.4 kW Gas-Electric ○
Refrigerator volume (thereof freezer), approx.	l	137 (15)	137 (15)	137 (15)	137 (15)



* INFO

The specified mass in running order is a standard value defined in the type approval procedure. Due to manufacturing tolerances, the actual weighed mass in running order may deviate from the value stated above. Deviations of up to ± 5% of the mass in running order are legally permissible and possible. The permissible range in kilograms is stated in parentheses after the mass in running order. The mass for optional equipment specified by the manufacturer is an imputed value determined for each type and layout by which Dethleffs specifies the maximum weight available for factory-fitted optional equipment. The purpose of limiting optional equipment is to ensure that the minimum payload, i.e. the legally required free mass for baggage and retrofitted accessories, is actually available for the load capacity of vehicles delivered by

Dethleffs. The actual weight of your vehicle after leaving the factory can only be determined when it is weighed at the end of the line. If, in exceptional cases, the weighing shows that the actual load capacity falls short of the minimum payload due to a permissible weight deviation, despite the limitation of the optional equipment, we will check together with your trading partner and you before delivery of the vehicle whether we should, for example, increase the load capacity of the vehicle or remove optional equipment. The technically permissible maximum laden mass of the vehicle must not be exceeded. For detailed information and explanations on the topic of weight and the configuration of the vehicle, please refer to the "Legal notes" section.

Camper®

Technical info



Camper®		510 ER	510 LE	530 FSK	540 QMK
Waste water tank, approx.	l	22	22	22	22
Fresh water tank capacity, total/ Fresh water tank capacity at driving filling	l	43 / 15	43 / 15	43 / 15	43 / 15
Sockets: 12 V / 230 V / USB		0 / 10 / 1	0 / 7 / 1	0 / 7 / 3	0 / 8 / 3



The specified mass in running order is a standard value defined in the type approval procedure. Due to manufacturing tolerances, the actual weighed mass in running order may deviate from the value stated above. Deviations of up to $\pm 5\%$ of the mass in running order are legally permissible and possible. The permissible range in kilograms is stated in parentheses after the mass in running order. The mass for optional equipment specified by the manufacturer is an imputed value determined for each type and layout by which Dethleffs specifies the maximum weight available for factory-fitted optional equipment. The purpose of limiting optional equipment is to ensure that the minimum payload, i.e. the legally required free mass for baggage and retrofitted accessories, is actually available for the load capacity of vehicles delivered by

Dethleffs. The actual weight of your vehicle after leaving the factory can only be determined when it is weighed at the end of the line. If, in exceptional cases, the weighing shows that the actual load capacity falls short of the minimum payload due to a permissible weight deviation, despite the limitation of the optional equipment, we will check together with your trading partner and you before delivery of the vehicle whether we should, for example, increase the load capacity of the vehicle or remove optional equipment. The technically permissible maximum laden mass of the vehicle must not be exceeded. For detailed information and explanations on the topic of weight and the configuration of the vehicle, please refer to the "Legal notes" section.

Camper®

Technical info

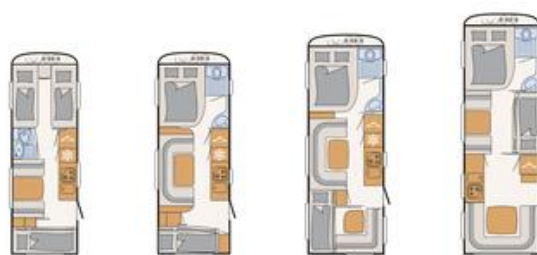

Camper®		550 ESK	560 FMK	650 FMK	730 FRK
Standard chassis		Lightweight chassis, 1600 kg	Lightweight chassis, 1700 kg	Lightweight chassis, 2000 kg	Lightweight chassis, 2000 kg
Overall length, approx.	cm	806	818	872	942
Body length approx.	cm	675	675	735	805
Overall width, approx.	cm	230	250	250	250
Overall height, approx.	cm	265	265	265	265
Circumferential dimension awning approx.	cm	1078	1078	1138	1208
Headroom in living area, approx.	cm	198	198	198	198
Thickness floor / side walls / roof	mm	42 / 34 / 34	42 / 34 / 34	42 / 34 / 34	42 / 34 / 34
Tire size		185 R14C 8PR	195 R14C LI106	185/70 R14 LI88	185/70 R14 LI88
Bed dimension: Front bed, L x W, approx.	cm	2x 200 x 85 / 200 x 210 ○	200 x 155	200 x 155	200 x 155
Bed dimension: Central / middle bed, L X W, approx.	cm	190 x 100	230 x 115	225 x 115	200 x 75 / 2x 195 x 75 / 2x 195 x 75 ○
Bed dimension: Rear bed, L x W, approx.	cm	210 x 70 / 200 x 75 / 210 x 75 ○ / 210 x 80 ○ / 210 x 70 ○	195 x 70 / 190 x 75 / 195 x 75 ○ / 195 x 80 ○ / 195 x 70 ○	200 x 75 / 200 x 70 / 2x 200 x 75 ○ / 195 x 75 ○	230 x 155
Sleeping berths standard / max.		5 / 6 ○	5 / 6 ○	5 / 6 ○	7 / 8 ○
Mass in running order (+/-5%)*	kg	1435 (1363 to 1507)*	1525 (1449 to 1601)*	1755 (1667 to 1843)*	1815 (1724 to 1906)*
Manufacturer-specified mass for optional equipment*	kg	48	58	122	35
Technically permissible maximum laden mass*	kg	1600	1700	2000	2000



* INFO

The specified mass in running order is a standard value defined in the type approval procedure. Due to manufacturing tolerances, the actual weighed mass in running order may deviate from the value stated above. Deviations of up to ± 5% of the mass in running order are legally permissible and possible. The permissible range in kilograms is stated in parentheses after the mass in running order. The mass for optional equipment specified by the manufacturer is an imputed value determined for each type and layout by which Dethleffs specifies the maximum weight available for factory-fitted optional equipment. The purpose of limiting optional equipment is to ensure that the minimum payload, i.e. the legally required free mass for baggage and retrofitted accessories, is actually available for the load capacity of vehicles delivered by

Dethleffs. The actual weight of your vehicle after leaving the factory can only be determined when it is weighed at the end of the line. If, in exceptional cases, the weighing shows that the actual load capacity falls short of the minimum payload due to a permissible weight deviation, despite the limitation of the optional equipment, we will check together with your trading partner and you before delivery of the vehicle whether we should, for example, increase the load capacity of the vehicle or remove optional equipment. The technically permissible maximum laden mass of the vehicle must not be exceeded. For detailed information and explanations on the topic of weight and the configuration of the vehicle, please refer to the "Legal notes" section.

Camper®

Technical info

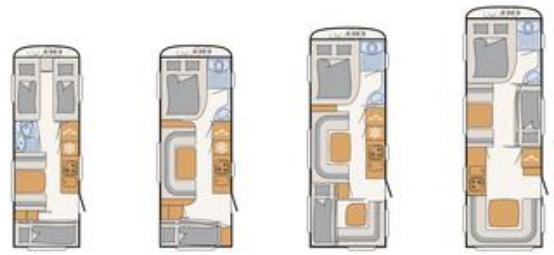

Camper®		550 ESK	560 FMK	650 FMK	730 FKR
Heating		S 5004, 6 kW Gas / Combi 6 G/E, 6 kW Gas-Electric ○ / Hot water heating, 6.4 kW Gas-Electric ○	S 5004, 6 kW Gas / Combi 6 G/E, 6 kW Gas-Electric ○ / Hot water heating, 6.4 kW Gas-Electric ○	S 5004, 6 kW Gas / Combi 6 G/E, 6 kW Gas-Electric ○ / Hot water heating, 6.4 kW Gas-Electric ○	S 5004, 6 kW Gas / Combi 6 G/E, 6 kW Gas-Electric ○ / Hot water heating, 6.4 kW Gas-Electric ○
Refrigerator volume (thereof freezer), approx.	l	137 (15)	137 (15)	137 (15)	86 (11) / 156 (29) ○
Waste water tank, approx.	l	22	22	22	22
Fresh water tank capacity, total/ Fresh water tank capacity at driving filling	l	43 / 15	43 / 15	43 / 15	43 / 15
Sockets: 12 V / 230 V / USB		0 / 8 / 3	0 / 9 / 3	0 / 9 / 3	0 / 10 / 3

○ Optional equipment — Not possible ● Standard equipment ◆ Mandatory ▲ Not known at the time of publication



The specified mass in running order is a standard value defined in the type approval procedure. Due to manufacturing tolerances, the actual weighed mass in running order may deviate from the value stated above. Deviations of up to ± 5% of the mass in running order are legally permissible and possible. The permissible range in kilograms is stated in parentheses after the mass in running order. The mass for optional equipment specified by the manufacturer is an imputed value determined for each type and layout by which Dethleffs specifies the maximum weight available for factory-fitted optional equipment. The purpose of limiting optional equipment is to ensure that the minimum payload, i.e. the legally required free mass for baggage and retrofitted accessories, is actually available for the load capacity of vehicles delivered by

Dethleffs. The actual weight of your vehicle after leaving the factory can only be determined when it is weighed at the end of the line. If, in exceptional cases, the weighing shows that the actual load capacity falls short of the minimum payload due to a permissible weight deviation, despite the limitation of the optional equipment, we will check together with your trading partner and you before delivery of the vehicle whether we should, for example, increase the load capacity of the vehicle or remove optional equipment. The technically permissible maximum laden mass of the vehicle must not be exceeded. For detailed information and explanations on the topic of weight and the configuration of the vehicle, please refer to the "Legal notes" section.

Standard equipment

	460 EL	470 ER	470 FR	500 QSK	510 ER	510 LE	530 FSK	540 QMK	550 ESK	560 FMK	650 FMK	730 FKR
Chassis												
Single axle premium wheel 195 R14 C LI106 (with steel wheel 1.700 kg and 1.800 kg)	—	—	—	—	—	—	—	●	—	●	—	—
Tyres on steel wheels 185 R14 C 8 PR, up to and including 1.600 kg	●	●	●	●	●	●	●	—	●	—	—	—
Tyres on steel wheels 185/70 R14 LI88 up to and including 2.000 kg	—	—	—	—	—	—	—	—	—	—	●	●
Zinc-plated chassis with inertia braking system with reversing automatic	●	●	●	●	●	●	●	●	●	●	●	●
Chassis features												
AAA self-adjusting brake	●	●	●	●	●	●	●	●	●	●	●	●
ACS stabiliser	●	●	●	●	●	●	●	●	●	●	●	●
High-quality brand-name tyres, designed for a speed of 100 km/h	●	●	●	●	●	●	●	●	●	●	●	●
Lightweight corner steadies	●	●	●	●	●	●	●	●	●	●	●	●
Octagon shock absorber	●	●	●	●	●	●	●	●	●	●	●	●
Exterior features												
Floor of the gas bottle locker made of rot-resistant and robust corrugated aluminium	●	●	●	●	●	●	●	●	●	●	●	●
Flyscreen door	●	●	●	●	●	●	●	●	●	●	●	●
Front parts in gas locker area made of LFI (long fiber injection) technology, shock resistant, robust and repair-friendly	●	●	●	●	●	●	●	●	●	●	●	●
Fully-insulated wheel houses	●	●	●	●	●	●	●	●	●	●	●	●
Midi Heki lift-and-tilt skylight incl. illuminated roof lining	●	●	●	●	●	●	●	●	●	●	●	●
One-piece habitation door	●	●	●	●	●	●	●	●	●	●	●	●
Opening window in bathroom	—	—	●	—	—	—	●	●	—	●	●	●
Opening windows, trapezoid, insulated and double-glazed (graphite grey) with blackout and mosquito blinds	●	●	●	●	●	●	●	●	●	●	●	●
Robust GRP roof	●	●	●	●	●	●	●	●	●	●	●	●
Sidewall skirts with integrated side-marker lamps	●	●	●	●	●	●	●	●	●	●	●	●
Skylight Mini Heki	●	●	●	●	●	●	●	●	●	●	●	●
Space-saving gas locker door which opens upwards	●	●	●	●	●	●	●	●	●	●	●	●
Spare wheel carrier in gas locker	●	●	●	●	●	●	●	●	●	●	●	●
Storage space for 2 gas bottles with 11 kg filling weight each	●	●	●	●	●	●	●	●	●	●	●	●
Exterior design												
Front and rear in smooth sides white	●	●	●	●	●	●	●	●	●	●	●	●
Sides in hammer finish, white	●	●	●	●	●	●	●	●	●	●	●	●
Access locker doors												
Access locker door front right side 997x419 mm	●	●	—	●	●	—	●	—	●	—	—	—
Access locker door rear right side 997x419 mm	—	—	—	—	—	●	—	—	—	—	—	—
Interior design												
Upholstery Cloud	●	●	●	●	●	●	●	●	●	●	●	●
Wood décor Rosario Cherry	●	●	●	●	●	●	●	●	●	●	●	●
Textile equipment												
7-zones double bed mattress, made of heat-regulating material	—	—	●	●	—	—	●	●	—	●	●	●
7-zones mattress left side, made of heat-regulating material	●	●	—	—	●	●	—	—	●	—	—	—
7-zones mattress right side, made of heat-regulating material	●	●	—	—	●	●	—	—	●	—	—	—
Furniture layouts												
AirPlus - perfect air circulation in the interior and rear ventilation of the overhead lockers and sideboards	●	●	●	●	●	●	●	●	●	●	●	●
Bunk bed with 2 sleeping berths, foldable	—	—	—	●	—	—	●	●	●	●	●	—
Bunk bed with 2 sleeping berths, not foldable	—	—	—	—	—	—	—	—	—	—	—	●
Bunk beds with safety net and ladder	—	—	—	●	—	—	●	●	●	●	●	●
One-legged telescopic table, height adjustable	—	●	●	—	●	—	—	●	—	●	●	●
Seating lounge converts to bed	●	●	●	●	●	●	●	●	●	●	●	●
Special slatted frame with flexible natural rubber holders, opening for optimal use of storage compartments under the beds	●	●	●	●	●	●	●	●	●	●	●	●

Standard equipment

	460 EL	470 ER	470 FR	500 QSK	510 ER	510 LE	530 FSK	540 QMK	550 ESK	560 FMK	650 FMK	730 FKR
Kitchen												
Generous drawers with soft closing for absolutely silent closing	●	●	●	●	●	●	●	●	●	●	●	●
Large fridge with 137 liters capacity and 15 liters freezer compartment	●	—	●	●	●	●	●	●	●	●	●	—
Practical 3-flames cooker with electric ignition	●	●	●	●	●	●	●	●	●	●	●	●
Practical apothecary drawers (depending on layout)	●	●	●	●	●	●	●	●	●	●	●	●
Spacious fridge with 86-litre volume and 11 litre freezer	—	●	—	—	—	—	—	—	—	—	—	●
Bathroom												
Integrated design washbasin made of solid surface material	●	●	●	●	●	●	●	●	●	●	●	●
Shower tray	●	●	●	●	●	●	●	●	●	●	●	●
Skylight with mosquito net	●	●	●	●	●	●	●	●	●	●	●	●
Heating												
Gas heating S 3004 with automatic ignition	●	●	●	●	●	●	—	—	—	—	—	—
Gas heating S 5004 with automatic ignition	—	—	—	—	—	—	●	●	●	●	●	●
Hot air system	●	●	●	●	●	●	●	●	●	●	●	●
Electrical installation												
12 V power supply throughout vehicle	●	●	●	●	●	●	●	●	●	●	●	●
Awning light 12V	●	●	●	●	●	●	●	●	●	●	●	●
CEE external output socket for 230V on-board electrics	●	●	●	●	●	●	●	●	●	●	●	●
Compact power distribution unit with 230V safety device and 12V fuse box in wardrobe incl. powerful 340W transformer	●	●	●	●	●	●	●	●	●	●	●	●
LED light bar system 12V (on head-side of bed and in seating lounge)	●	●	●	●	●	●	●	●	●	●	●	●
USB port for spotlight bar	●	●	●	●	●	●	●	●	●	●	●	●
Water supply												
Electric water supply	●	●	●	●	●	●	●	●	●	●	●	●
Fresh water tank 38 l	●	●	●	●	●	●	●	●	●	●	●	●
Hot water supply	●	●	●	●	●	●	●	●	●	●	●	●
Mobile 22 l waste water tank	●	●	●	●	●	●	●	●	●	●	●	●

Packages Camper®

Package	Styling Package white (single axle) (13254)	Styling Package white (single axle) (13254)	Styling Package white (single axle) (13254)	Styling Package white (tandem axle) (13256)	Styling Package white (tandem axle) (13256)	Styling Package white (tandem axle 2.8 t) (13258)
Smooth sides white	x					
17" alloy wheels in Dethleffs design (single axle)	x	x	x			
Draw bar cover	x	x	x	x	x	x
Large support feet, 4 pc.	x	x	x	x	x	x
Solid rubber support wheel with support load indicator	x	x	x	x	x	x
Manoeuvring handles in chrome design	x	x	x	x	x	x
Rear light carrier with high attachment and roof rails	x	x	x	x	x	x
Front moulding with high attachment and roof rails	x	x	x	x	x	x
Smooth sides white		x				
Smooth sides white			x	x		
17" alloy wheels in Dethleffs design (tandem axle)				x	x	
Smooth sides white					x	x
Tyres on alloy wheels 195/70 R14 C LI104, 2200 kg to 2800 kg						x
Additional weight (kg)*	45.7	48.3	51.1	41.1	43.4	47.4



The factory installation of optional equipment increases the actual mass of the vehicle and reduces the payload. The specified additional weight for packages and optional equipment shows the additional weight compared with the standard equipment of the respective model or layout. The total weight of the selected optional equipment must not exceed the mass for optional equipment specified by the manufacturer in the model overviews. This is an imputed

value determined for each model and layout that Dethleffs uses to determine the maximum weight available for factory-installed optional equipment. In the event of an increase of load capacity, the mass for optional equipment specified by the manufacturer is increased. For detailed information and explanations on the topic of weight, please refer to the "Legal notes" section.

Package	Styling Package silver (single axle) (13255)	Styling Package silver (single axle) (13255)	Styling Package silver (single axle) (13255)	Styling Package silver (tandem axle) (13257)	Styling Package silver (tandem axle) (13257)	Styling Package silver (tandem axle 2.8 t) (13259)
Smooth sides titanium silver metallic	x					
17" alloy wheels in Dethleffs design (single axle)	x	x	x			
Draw bar cover	x	x	x	x	x	x
Large support feet, 4 pc.	x	x	x	x	x	x
Solid rubber support wheel with support load indicator	x	x	x	x	x	x
Manoeuvring handles in chrome design	x	x	x	x	x	x
Rear light carrier with high attachment and roof rails	x	x	x	x	x	x
Front moulding with high attachment and roof rails	x	x	x	x	x	x
Smooth sides titanium silver metallic		x				
Smooth sides titanium silver metallic			x	x		
17" alloy wheels in Dethleffs design (tandem axle)				x	x	
Smooth sides titanium silver metallic					x	x
Tyres on alloy wheels 195/70 R14 C LI104, 2200 kg to 2800 kg						x
Additional weight (kg)*	45.7	48.3	51.1	41.1	43.4	47.4

Package	Winter Comfort Package Combi 4 (10479)	Winter Comfort Package Combi 4 (10479)	Winter Comfort Package Combi 6 (9536)	Winter Comfort Package Combi 6 (9536)	Winter Comfort Package Combi 6 (9536)
Electric floor heating	x	x	x	x	x
Waste water pipes insulated and heated	x	x	x	x	x
Insulated threader hose	x	x	x	x	x
XPS insulation for front, rear and sides (depending on vehicle size)	x				
Hot air heating Combi 4 G/E incl. digital control unit	x	x			
XPS insulation for front, rear and sides (depending on vehicle size)		x	x		
Hot air heating Combi 6 G/E incl. digital control unit			x	x	x
XPS insulation for front, rear and sides (depending on vehicle size)				x	
XPS insulation for front, rear and sides (depending on vehicle size)					x
Additional weight (kg)*	47.6	50.1	50.1	52.8	55



The factory installation of optional equipment increases the actual mass of the vehicle and reduces the payload. The specified additional weight for packages and optional equipment shows the additional weight compared with the standard equipment of the respective model or layout. The total weight of the selected optional equipment must not exceed the mass for optional equipment specified by the manufacturer in the model overviews. This is an imputed

value determined for each model and layout that Dethleffs uses to determine the maximum weight available for factory-installed optional equipment. In the event of an increase of load capacity, the mass for optional equipment specified by the manufacturer is increased. For detailed information and explanations on the topic of weight, please refer to the "Legal notes" section.

Package	Winter Comfort Package SNOW (5459)	Winter Comfort Package SNOW (5459)	Winter Comfort Package SNOW (5459)	Winter Comfort Package SNOW PLUS (5551)	Winter Comfort Package SNOW PLUS (5551)	Winter Comfort Package SNOW PLUS (5551)
Hot water heating	x	x	x	x	x	x
Electric floor heating	x	x	x			
Waste water pipes insulated and heated	x	x	x	x	x	x
XPS insulation for front, rear and sides (depending on vehicle size)	x			x		
XPS insulation for front, rear and sides (depending on vehicle size)		x			x	
XPS insulation for front, rear and sides (depending on vehicle size)			x			x
Hot water floor heating (only in comb. with option 205)				x	x	x
Additional weight (kg)*	74.1	76.8	79	75.1	77.8	80

Package	Mover Autonomy Package (single axle) (5560)	Mover Autonomy Package (tandem axle) (5561)
Mover manoeuvring support for single-axle	x	
Electric Autonomy equipment	x	x
Mover manoeuvring support for tandem-axle		x
Additional weight (kg)*	70	98

Package	Water and Electric Autonomy Package Combi 4 (11031)	Water and Electric Autonomy Package Combi 6 (11032)	Water & Electric Autonomy Package with Combi or hot water heating system (9943)
Hot air heating Combi 4 G/E incl. digital control unit	x		
Electric Autonomy equipment	x	x	x
Fresh water tank 70 l	x	x	x
Hot air heating Combi 6 G/E incl. digital control unit		x	
Additional weight (kg)*	55.5	55.5	40.5

Safety Package (8950)	
ATC Trailer Control	
DuoControl safety gas pressure regulator with crash sensor and EisEx gas regulator heater	
Smoke detector	
Additional weight (kg)*	7

Shower Package (6105)	
Shower equipment with shower fittings and curtain	
City water connection	
Additional weight (kg)*	7

△ Not known at the time of publication



The factory installation of optional equipment increases the actual mass of the vehicle and reduces the payload. The specified additional weight for packages and optional equipment shows the additional weight compared with the standard equipment of the respective model or layout. The total weight of the selected optional equipment must not exceed the mass for optional equipment specified by the manufacturer in the model overviews. This is an imputed

value determined for each model and layout that Dethleffs uses to determine the maximum weight available for factory-installed optional equipment. In the event of an increase of load capacity, the mass for optional equipment specified by the manufacturer is increased. For detailed information and explanations on the topic of weight, please refer to the "Legal notes" section.

Optional equipment**

	Included in package	Additional weight (kg)*	Code	460 EL	470 ER	470 FR	500 QSK	510 ER	510 LE	530 FSK	540 QMK	550 ESK	560 FMK	650 FMK	730 FRK
Chassis															
17" alloy wheels in Dethleffs design (single axle)	STP	10	11608	○	○	○	○	○	○	○	○	○	○	○	○
17" alloy wheels in Dethleffs design (tandem axle)	STP	0	11609	—	—	—	—	—	—	—	—	—	—	○	○
Tyres on alloy wheels 185 R14 C LI102, up to and including 1600 kg	—	0	836	○	○	○	○	○	○	○	—	○	—	—	—
Tyres on alloy wheels 185/70 R14 LI88, up to and including 2000 kg	—	0	840	—	—	—	—	—	—	—	—	—	—	○	○
Tyres on alloy wheels 195 R14 C LI106, 1700 kg and 1800 kg	—	2	838	○	○	○	○	○	○	○	○	○	○	—	—
Tyres on alloy wheels 195/70 R14 C LI104, 2200 kg to 2800 kg	STP	4	859	—	—	—	—	—	—	—	—	—	—	○	○
Weight upgrade															
Weight upgrade 1.700 kg (incl. steel wheel 195 R14 C LI106)	—	23.1	278	○	○	○	—	—	—	—	—	—	—	—	—
Weight upgrade 1.700 kg (incl. steel wheel 195 R14 C LI106)	—	23.9	278	—	—	—	○	—	—	—	—	—	—	—	—
Weight upgrade 1.700 kg (incl. steel wheel 195 R14 C LI106)	—	24.3	278	—	—	—	—	○	○	—	—	—	—	—	—
Weight upgrade 1.700 kg (incl. steel wheel 195 R14 C LI106)	—	0.3	278	—	—	—	—	—	—	○	—	○	—	—	—
Weight upgrade 1.800 kg (incl. steel wheel 195 R14 C LI106)	—	6.8	279	—	—	—	—	—	—	○	—	○	—	—	—
Weight upgrade 1.800 kg (incl. steel wheel 195 R14 C LI106)	—	6.6	279	—	—	—	—	—	—	—	—	—	○	—	—
Weight upgrade 1.800 kg (incl. steel wheel 195 R14 C LI106)	—	5.9	279	—	—	—	—	—	—	—	○	—	—	—	—
Weight upgrade 1.800 kg (incl. steel wheel 195 R14 C LI106)	—	29.2	279	—	○	○	—	—	—	—	—	—	—	—	—
Weight upgrade 1.800 kg (incl. steel wheel 195 R14 C LI106)	—	31.6	279	—	—	—	○	—	—	—	—	—	—	—	—
Weight upgrade 1.800 kg (incl. steel wheel 195 R14 C LI106)	—	32	279	—	—	—	—	○	○	—	—	—	—	—	—
Weight upgrade 1.900 kg (incl. alloy wheel 225/70 R15 C LI112)	—	18.7	394	—	—	—	—	—	—	—	—	—	○	—	—
Weight upgrade 1.900 kg (incl. alloy wheel 225/70 R15 C LI112)	—	19.2	394	—	—	—	—	—	—	○	—	○	—	—	—
Weight upgrade 1.900 kg (incl. alloy wheel 225/70 R15 C LI112)	—	23.8	394	—	—	—	—	—	—	—	○	—	—	—	—
Weight upgrade 2.000 kg (incl. alloy wheel 225/70 R15 C LI112)	—	18.7	138	—	—	—	—	—	—	—	—	—	○	—	—
Weight upgrade 2.000 kg (incl. alloy wheel 225/70 R15 C LI112)	—	23.8	138	—	—	—	—	—	—	—	○	—	—	—	—
Weight upgrade 2.000 kg (incl. alloy wheel 225/70 R15 C LI112)	—	19.2	138	—	—	—	—	—	—	○	—	○	—	—	—
Weight upgrade 2.200 kg (incl. steel wheel 195/70 R14 C LI104)	—	2.6	6351	—	—	—	—	—	—	—	—	—	—	○	○
Weight upgrade 2.500 kg (incl. steel wheel 195/70 R14 C LI104)	—	2.6	496	—	—	—	—	—	—	—	—	—	—	○	○
Weight upgrade to 1.600 kg	—	23.6	322	—	—	—	○	—	—	—	—	—	—	—	—
Weight upgrade to 1.600 kg	—	24	322	—	—	—	—	○	—	—	—	—	—	—	—
Weight upgrade to 1.600 kg	—	22.8	322	○	○	○	—	—	—	—	—	—	—	—	—
Weight upgrade 2.800 kg (incl. steel wheel 195/70 R14 C LI104)	—	27.4	7713	—	—	—	—	—	—	—	—	—	—	—	○
Chassis features															
ATC Trailer Control	SHP	4	748	○	○	○	○	○	○	○	○	○	○	○	○
Breakdown kit	—	1	620	○	○	○	○	○	○	○	○	○	○	○	○
Draw bar cover	STP	2	434	○	○	○	○	○	○	○	○	○	○	○	○
Large support feet, 4 pc.	STP	1	6348	○	○	○	○	○	○	○	○	○	○	○	○
Solid rubber support wheel with support load indicator	STP	2	10063	○	○	○	○	○	○	○	○	○	○	○	○
Spare tyre with alloy wheel 185 R14 C LI 102, up to and including 1.600 kg	—	17	837	○	○	○	○	○	○	—	—	—	—	—	—
Spare tyre with alloy wheel 185/70 R14 LI 88, up to and including 2.000 kg	—	18	841	—	—	—	—	—	—	—	—	—	—	○	○
Spare tyre with alloy wheel 195 R14 C 8PR-LI 106, 1.700 kg and 1.800 kg	—	19	839	○	○	○	○	○	○	—	—	—	○	—	—



The factory installation of optional equipment increases the actual mass of the vehicle and reduces the payload. The specified additional weight for packages and optional equipment shows the additional weight compared with the standard equipment of the respective model or layout. The total weight of the selected optional equipment must not exceed the mass for optional equipment specified by the manufacturer in the model overviews. This is an imputed

value determined for each model and layout that Dethleffs uses to determine the maximum weight available for factory-installed optional equipment. In the event of an increase of load capacity, the mass for optional equipment specified by the manufacturer is increased. For detailed information and explanations on the topic of weight, please refer to the "Legal notes" section.

Optional equipment**

	Included in package	Additional weight (kg)*	Code	460 EL	470 ER	470 FR	500 QSK	510 ER	510 LE	530 FSK	540 QMK	550 ESK	560 FMK	650 FMK	730 FRK
Spare tyre with alloy wheel 195/70 R14 C-LI 102, 2.200 kg to 2.800 kg	—	19	861	—	—	—	—	—	—	—	—	—	—	○	○
Spare tyre with alloy wheel 225/70 R15 C LI 112 , 1.900 kg and 2.000 kg	—	23.5	1092	—	—	—	—	—	—	—	—	—	○	—	—
Spare tyre with steel wheel 185 R14 C 8 PR, up to and including 1.600 kg	—	18	831	○	○	○	○	○	○	—	—	—	—	—	—
Spare tyre with steel wheel 185/70 R14 LI 88, up to and including 2.000 kg	—	18	835	—	—	—	—	—	—	—	—	—	—	○	○
Spare tyre with steel wheel 195 R14 C LI 106, 1.700 kg and 1.800 kg	—	19.5	833	○	○	○	○	○	○	—	—	—	○	—	—
Spare tyre with steel wheel 195/70 R14 C-LI 104, 2.200 kg to 2.800 kg	—	20	860	—	—	—	—	—	—	—	—	—	—	○	○
Wheel trims for 14" tyres	—	2	276	○	○	○	○	○	○	○	○	○	○	○	○
Exterior features															
Cassette awning 3750x2500 mm, manual	—	25.5	6928	○	○	○	—	—	—	—	—	—	—	—	—
Cassette awning 4000x2500 mm, manual	—	27.5	6928	—	—	—	○	○	○	—	—	—	—	—	—
Cassette awning 4500x2500 mm, manual	—	30	6928	—	—	—	—	—	—	○	○	○	○	—	—
Cassette awning 5500x3000 mm, manual	—	50.6	6928	—	—	—	—	—	—	—	—	—	—	○	—
Cassette awning 6000x3000 mm, manual	—	54.6	6928	—	—	—	—	—	—	—	—	—	—	—	○
Flush-fitting windows (not possible for front and rear windows) 8)	—	3	7561	○	○	○	○	○	○	○	○	○	○	○	○
Front window	—	4	982	○	○	—	○	○	●	—	○	○	—	—	—
Front window (bed area), if washroom in front	—	5	855	—	—	○	—	—	—	○	—	—	○	○	○
Heki II skylight incl. illuminated roof lining	—	8	274	○	○	○	○	○	○	○	○	○	○	○	○
One-piece habitation door with window	—	3	862	○	○	○	○	○	○	○	○	○	○	○	○
Rear window	—	4	1108	●	●	●	—	●	○	—	—	—	—	●	●
XPS insulation for front, rear and sides (depending on vehicle size)	WI-KO	17.6	179	○	○	○	—	—	—	—	—	—	—	—	—
XPS insulation for front, rear and sides (depending on vehicle size)	WI-KO	20.1	179	—	—	—	○	○	○	○	○	—	—	○	—
XPS insulation for front, rear and sides (depending on vehicle size)	WI-KO	22.8	179	—	—	—	—	—	—	—	—	○	○	—	—
XPS insulation for front, rear and sides (depending on vehicle size)	WI-KO	25	179	—	—	—	—	—	—	—	—	—	—	—	○
Exterior design															
Front moulding with high attachment and roof rails	STP	1	627	○	○	○	○	○	○	○	○	○	○	○	○
Manoeuvring handles in chrome design	STP	0	754	○	○	○	○	○	○	○	○	○	○	○	○
Rear light carrier with high attachment and roof rails	STP	11	624	○	○	○	○	○	○	○	○	○	○	○	○
Smooth sides titanium silver metallic	STP	18.7	659	○	○	○	—	—	—	—	—	—	—	—	—
Smooth sides titanium silver metallic	STP	21.3	659	—	—	—	○	○	○	○	○	—	—	—	—
Smooth sides titanium silver metallic	STP	24.1	659	—	—	—	—	—	—	—	—	○	○	○	—
Smooth sides titanium silver metallic	STP	26.4	659	—	—	—	—	—	—	—	—	—	—	—	○
Smooth sides white	STP	18.7	443	○	○	○	—	—	—	—	—	—	—	—	—
Smooth sides white	STP	21.3	443	—	—	—	○	○	○	○	○	—	—	—	—
Smooth sides white	STP	24.1	443	—	—	—	—	—	—	—	—	○	○	○	—
Smooth sides white	STP	26.4	443	—	—	—	—	—	—	—	—	—	—	—	○



The factory installation of optional equipment increases the actual mass of the vehicle and reduces the payload. The specified additional weight for packages and optional equipment shows the additional weight compared with the standard equipment of the respective model or layout. The total weight of the selected optional equipment must not exceed the mass for optional equipment specified by the manufacturer in the model overviews. This is an imputed

value determined for each model and layout that Dethleffs uses to determine the maximum weight available for factory-installed optional equipment. In the event of an increase of load capacity, the mass for optional equipment specified by the manufacturer is increased. For detailed information and explanations on the topic of weight, please refer to the "Legal notes" section.

Optional equipment**

	Included in package	Additional weight (kg)*	Code	460 EL	470 ER	470 FR	500 QSK	510 ER	510 LE	530 FSK	540 QMK	550 ESK	560 FMK	650 FMK	730 FKR
Access locker doors															
Access locker door 1550x1050 mm with window	—	8	9486	—	—	—	—	—	—	—	○	—	—	○	—
Access locker door front left 997x419 mm	—	2.2	1079	—	—	●	—	○	—	—	—	○	●	○	●
Access locker door front left side 1069x299 mm	—	2	1083	—	—	—	—	—	○	—	—	—	—	—	—
Access locker door front left side 648x348 mm	—	2	1071	—	—	○	—	○	—	—	●	○	—	—	—
Access locker door front right side 1069x299 mm	—	2	1084	—	—	—	—	—	○	—	—	—	—	—	—
Access locker door rear left side 1069x299 mm	—	2	1085	—	—	—	—	—	—	—	—	—	—	—	○
Access locker door rear left side 749x297 mm	—	2	1077	○	○	○	—	—	—	—	—	—	—	—	—
Access locker door rear right side 1069x299 mm	—	2	1086	—	—	—	—	○	—	—	—	—	—	●	○
Access locker door rear right side 749x297 mm	—	2	1078	○	○	○	—	—	—	—	—	—	—	—	—
Interior design															
Upholstery Galaxy	—	0	11269	○	○	○	○	○	○	○	○	○	○	○	○
Upholstery Mount	—	0	11270	○	○	○	○	○	○	○	○	○	○	○	○
Textile equipment															
7-zones double bed mattress, made of heat-regulating material with watergel cover	—	4	8214	—	—	○	○	—	—	○	○	—	○	○	○
7-zones mattress left side, made of heat-regulating material with watergel cover	—	2	8215	○	○	—	—	○	○	—	—	○	—	—	—
7-zones mattress right side, made of heat-regulating material with watergel cover	—	5	8216	○	○	—	—	○	○	—	—	○	—	—	—
Corner head rests for U-shaped seating lounge	—	2	9236	—	○	○	—	○	—	—	○	—	○	○	○
Loose carpet	—	8.5	513	○	○	○	○	○	○	○	○	○	○	○	○
Furniture layouts															
Bunk bed with 2 sleeping berths, not foldable, instead of seating lounge	—	0	9775	—	—	—	—	—	—	—	—	—	—	—	○
Bunk bed with 3 sleeping berths, not foldable	—	20	200	—	—	—	○	—	—	○	○	○	○	○	—
Single beds convert to double bed	—	5	685	○	○	—	—	○	○	—	—	○	—	—	—
Slatted bed frame with adjustable head section	—	1	871	○	○	—	—	○	○	—	—	○	—	—	—
Interior features															
2 kg fire extinguisher	—	3.5	843	○	○	○	○	○	○	○	○	○	○	○	○
Smoke detector	SHP	0.5	8949	○	○	○	○	○	○	○	○	○	○	○	○
Kitchen															
Extractor fan	—	3	785	○	○	○	○	○	○	○	○	○	○	○	○
Kitchen unit with large fridge (175 l), separate freezer and electric ignition	—	18	429	—	—	—	—	—	—	—	—	—	—	—	○
Kitchen worktop extension, foldable	—	1	1107	—	—	○	—	○	—	—	—	—	—	—	○
Oven	—	17	572	○	—	○	○	○	○	○	○	○	○	○	○
Bathroom															
Bathroom in alternative design	—	4	604	—	—	—	—	—	—	○	—	—	○	○	○
Multimedia															
FS-SAT system Voyager 65 Digimatic	—	10	1049	—	○	○	○	○	○	○	—	○	—	○	○
Flat screen TV 22" incl. DVD player and receiver	—	3.5	1103	○	○	○	○	○	○	○	○	○	○	○	○
Multifunctional external connection, 12 V, 220 V, TV and SAT	—	1	611	○	○	○	○	○	○	○	○	○	○	○	○



The factory installation of optional equipment increases the actual mass of the vehicle and reduces the payload. The specified additional weight for packages and optional equipment shows the additional weight compared with the standard equipment of the respective model or layout. The total weight of the selected optional equipment must not exceed the mass for optional equipment specified by the manufacturer in the model overviews. This is an imputed

value determined for each model and layout that Dethleffs uses to determine the maximum weight available for factory-installed optional equipment. In the event of an increase of load capacity, the mass for optional equipment specified by the manufacturer is increased. For detailed information and explanations on the topic of weight, please refer to the "Legal notes" section.

Optional equipment**

	Included in package	Additional weight (kg)*	Code	460 EL	470 ER	470 FR	500 QSK	510 ER	510 LE	530 FSK	540 QMK	550 ESK	560 FMK	650 FMK	730 FRK
Preparation for flat screen TV (antenna cable and TV bracket)	—	2	678	○	○	○	○	○	○	○	○	○	○	○	○
SAT parabol antenna flat 65 Easy 65 Twin	—	14	879	—	○	○	○	○	○	○	—	○	○	○	○
Heating															
Electric floor heating	WI-KO	9	387	○	○	○	○	○	○	○	○	○	○	○	○
Fan 12 V with automatic speed control for S 5004	—	2	178	—	—	—	—	—	—	○	○	○	○	○	○
Fan 12V for S 3004	—	2	177	○	○	○	○	○	○	—	—	—	—	—	—
Hot air heating Combi 4 G/E incl. digital control unit	WEA-P, WI-KO	15	10480	○	○	○	○	○	○	—	—	—	—	—	—
Hot air heating Combi 6 G/E incl. digital control unit	WEA-P, WI-KO	15	9427	—	—	—	—	—	—	○	○	○	○	○	○
Hot water floor heating (only in comb. with option 205) ⁹⁾	WI-KO	10	674	—	—	—	—	—	—	○	○	○	○	○	○
Hot water heating	WI-KO	40	205	—	—	—	—	—	—	○	○	○	○	○	○
Ultraheat additional heating for S 3004, electric 220 V	—	2	364	○	○	○	○	○	○	—	—	—	—	—	—
Ultraheat additional heating for S 5004, electric 220 V	—	2	422	—	—	—	—	—	—	○	○	○	○	○	○
Air Conditioning															
Pre-wiring for A/C	—	0	172	○	○	○	○	○	○	○	○	○	○	○	○
Roof A/C	—	35	8145	○	○	○	○	○	○	○	○	○	○	○	○
Electrical installation															
Electric Autonomy equipment	WEA-P, M-P	38	492	○	○	○	○	○	○	○	○	○	○	○	○
Indirect lighting	—	2	633	○	○	○	○	○	○	○	○	○	○	○	○
Water supply															
City water connection	DUP	2	414	○	○	○	○	○	○	○	○	○	○	○	○
Exterior shower	—	2	396	○	○	○	○	○	○	○	○	○	○	○	○
Fresh water tank 70 l	WEA-P	2.5	592	○	○	○	○	○	○	○	○	○	○	○	○
Shower equipment with shower fittings and curtain	DUP	5	1097	○	○	○	○	○	○	○	○	○	○	○	○
Waste water pipes insulated and heated	WI-KO	5	520	○	○	○	○	○	○	○	○	○	○	○	○
Gas supply															
DuoControl safety gas pressure regulator with crash sensor and EisEx gas regulator heater	SHP	2.5	784	○	○	○	○	○	○	○	○	○	○	○	○
Gas socket (exterior)	—	1	187	○	○	○	○	○	○	○	○	○	○	○	○
Packages															
Mover Autonomy Package (single axle)	—	70	5560	○	○	○	○	○	○	○	○	○	○	○	—
Mover Autonomy Package (tandem axle)	—	98	5561	—	—	—	—	—	—	—	—	—	—	—	○
Safety Package	—	7	8950	○	○	○	○	○	○	○	○	○	○	○	○
Shower Package	—	7	6105	○	○	○	○	○	○	○	○	○	○	○	○
Styling Package silver (single axle)	—	51.1	13255	—	—	—	—	—	—	—	—	○	○	—	—
Styling Package silver (single axle)	—	48.3	13255	—	—	—	○	○	○	○	○	—	—	—	—
Styling Package silver (single axle)	—	45.7	13255	○	○	○	—	—	—	—	—	—	—	—	—
Styling Package silver (tandem axle 2.8 t)	—	47.4	13259	—	—	—	—	—	—	—	—	—	—	—	○
Styling Package silver (tandem axle)	—	43.4	13257	—	—	—	—	—	—	—	—	—	—	—	○
Styling Package silver (tandem axle)	—	41.1	13257	—	—	—	—	—	—	—	—	—	—	○	—
Styling Package white (single axle)	—	45.7	13254	○	○	○	—	—	—	—	—	—	—	—	—



The factory installation of optional equipment increases the actual mass of the vehicle and reduces the payload. The specified additional weight for packages and optional equipment shows the additional weight compared with the standard equipment of the respective model or layout. The total weight of the selected optional equipment must not exceed the mass for optional equipment specified by the manufacturer in the model overviews. This is an imputed

value determined for each model and layout that Dethleffs uses to determine the maximum weight available for factory-installed optional equipment. In the event of an increase of load capacity, the mass for optional equipment specified by the manufacturer is increased. For detailed information and explanations on the topic of weight, please refer to the "Legal notes" section.

Optional equipment**

	Included in package	Additional weight (kg)*	Code	460 EL	470 ER	470 FR	500 QSK	510 ER	510 LE	530 FSK	540 QMK	550 ESK	560 FMK	650 FMK	730 FKR
Styling Package white (single axle)	—	51.1	13254	—	—	—	—	—	—	—	—	○	○	—	—
Styling Package white (single axle)	—	48.3	13254	—	—	—	○	○	○	○	○	—	—	—	—
Styling Package white (tandem axle 2.8 t)	—	47.4	13258	—	—	—	—	—	—	—	—	—	—	—	○
Styling Package white (tandem axle)	—	43.4	13256	—	—	—	—	—	—	—	—	—	—	—	○
Styling Package white (tandem axle)	—	41.1	13256	—	—	—	—	—	—	—	—	—	—	○	—
Water & Electric Autonomy Package with Combi or hot water heating system	—	40.5	9943	○	○	○	○	○	○	○	○	○	○	○	○
Water and Electric Autonomy Package Combi 4	—	55.5	11031	○	○	○	○	○	○	—	—	—	—	—	—
Water and Electric Autonomy Package Combi 6	—	55.5	11032	—	—	—	—	—	—	○	○	○	○	○	○
Winter Comfort Package Combi 4	—	50.1	10479	—	—	—	○	○	○	—	—	—	—	—	—
Winter Comfort Package Combi 4	—	47.6	10479	○	○	○	—	—	—	—	—	—	—	—	—
Winter Comfort Package Combi 6	—	52.8	9536	—	—	—	—	—	—	—	—	○	○	—	—
Winter Comfort Package Combi 6	—	55	9536	—	—	—	—	—	—	—	—	—	—	—	○
Winter Comfort Package Combi 6	—	50.1	9536	—	—	—	—	—	—	○	○	—	—	○	—
Winter Comfort Package SNOW	—	79	5459	—	—	—	—	—	—	—	—	—	—	—	○
Winter Comfort Package SNOW	—	76.8	5459	—	—	—	—	—	—	—	—	○	○	—	—
Winter Comfort Package SNOW	—	74.1	5459	—	—	—	—	—	—	○	○	—	—	○	—
Winter Comfort Package SNOW PLUS	—	80	5551	—	—	—	—	—	—	—	—	—	—	—	○
Winter Comfort Package SNOW PLUS	—	75.1	5551	—	—	—	—	—	—	○	○	—	—	○	—
Winter Comfort Package SNOW PLUS	—	77.8	5551	—	—	—	—	—	—	—	—	○	○	—	—
Miscellaneous															
Registration documents (CoC papers)	—	0	15151	◆	◆	◆	◆	◆	◆	◆	◆	◆	◆	◆	◆

○ Optional equipment — Not possible ● Standard equipment ◆ Mandatory △ Not known at the time of publication

STP Styling Package SHP Safety Package WI-KO Winter Comfort Package WEA-P Water and Electric Autonomy Package M-P Mover Package DUP Shower Package



The factory installation of optional equipment increases the actual mass of the vehicle and reduces the payload. The specified additional weight for packages and optional equipment shows the additional weight compared with the standard equipment of the respective model or layout. The total weight of the selected optional equipment must not exceed the mass for optional equipment specified by the manufacturer in the model overviews. This is an imputed

value determined for each model and layout that Dethleffs uses to determine the maximum weight available for factory-installed optional equipment. In the event of an increase of load capacity, the mass for optional equipment specified by the manufacturer is increased. For detailed information and explanations on the topic of weight, please refer to the "Legal notes" section.

Nomad

Experience pays off

With its comprehensive equipment and stylish, detailed solutions, the Nomad is the perfect caravan for demanding travellers. One highlight is the sophisticated Light Moments lighting concept, which is stylishly designed for the ultimate feel-good mood - regardless of the weather!

Upholstery



+ Upholstery Ruby

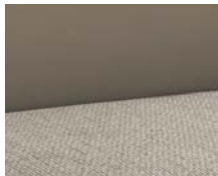

+ Upholstery Champion ○



+ Upholstery Chromo ○

Wood décor



+ Wood décor Noce Nagano

○ optionally available

Technical info

Overall length, approx.	691 - 942 cm
Overall width, approx.	230 - 250 cm
Overall height, approx.	265 cm
Headroom in living area, approx.	198 cm

Maximum values partly not possible for all models or only in connection with certain options.

Plus factors

- + Something for everyone: a wide range of caravans with double and single-bed layouts
- + Sophisticated exterior design: chic details such as a designer rear moulding with integrated lights, chrome trim on the side walls and chrome manoeuvring handles
- + Well-being atmosphere: exquisite, elegant living room design with atmospheric light concept
- + Cooking like at home: very well-equipped gourmet kitchen with illuminated kitchen back panel
- + Good as standard: ready to go thanks to comprehensive specifications

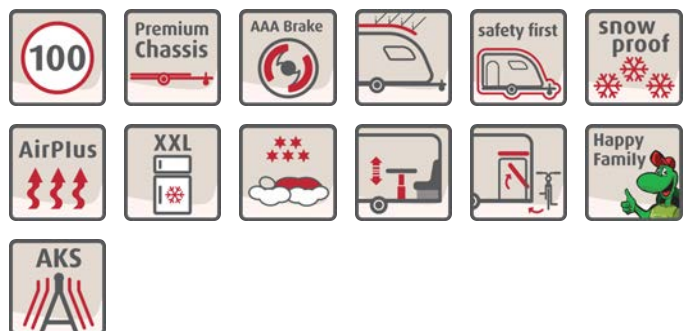

Nomad

Technical info



Nomad		460 EL	470 FR	490 BLF	490 EST	510 ER
Standard chassis		Lightweight chassis, 1500 kg	Lightweight chassis, 1500 kg	Lightweight chassis, 1500 kg	Lightweight chassis, 1500 kg	Lightweight chassis, 1500 kg
Overall length, approx.	cm	691	713	729	729	766
Body length approx.	cm	550	570	590	590	620
Overall width, approx.	cm	230	230	230	230	230
Overall height, approx.	cm	265	265	265	265	265
Circumferential dimension awning approx.	cm	948	968	988	988	1018
Headroom in living area, approx.	cm	198	198	198	198	198
Thickness floor / side walls / roof	mm	42 / 34 / 34	42 / 34 / 34	42 / 34 / 34	42 / 34 / 34	42 / 34 / 34
Tire size		185 R14C 8PR	185 R14C 8PR	185 R14C 8PR	185 R14C 8PR	185 R14C 8PR
Bed dimension: Front bed, L x W, approx.	cm	200 x 85 / 190 x 85 / 190 x 210 ○	200 x 135		200 x 85 / 190 x 85 / 190 x 210 ○	200 x 85 / 190 x 85 / 190 x 210 ○
Bed dimension: Central / middle bed, L X W, approx.	cm			185 x 105	185 x 90	
Bed dimension: Rear bed, L x W, approx.	cm	210 x 115	210 x 135	210 x 135		210 x 135
Sleeping berths standard / max.		3	4	3	3	4
Mass in running order (+/-5%)*	kg	1275 (1211 to 1339)*	1280 (1216 to 1344)*	1360 (1292 to 1428)*	1325 (1259 to 1391)*	1360 (1292 to 1428)*
Manufacturer-specified mass for optional equipment*	kg	140	123	51	86	38
Technically permissible maximum laden mass*	kg	1500	1500	1500	1500	1500
Heating		S 3004, 3.5 kW Gas / Combi 4 G/E, 4 kW Gas-Electric ○	S 3004, 3.5 kW Gas / Combi 4 G/E, 4 kW Gas-Electric ○	Combi 4 G/E, 4 kW Gas-Electric	Combi 4 G/E, 4 kW Gas-Electric	S 3004, 3.5 kW Gas / Combi 4 G/E, 4 kW Gas-Electric ○
Refrigerator volume (thereof freezer), approx.	l	137 (15)	137 (15)	137 (15)	137 (15)	137 (15)
Waste water tank, approx.	l	22	22	22	22	22
Fresh water tank capacity, total/ Fresh water tank capacity at driving filling	l	43 / 15	43 / 15	48 / 15	48 / 15	43 / 15
Sockets: 12 V / 230 V / USB		0 / 6 / 1	0 / 8 / 1	0 / 7 / 1	0 / 6 / 1	0 / 9 / 1



* INFO

The specified mass in running order is a standard value defined in the type approval procedure. Due to manufacturing tolerances, the actual weighed mass in running order may deviate from the value stated above. Deviations of up to ± 5% of the mass in running order are legally permissible and possible. The permissible range in kilograms is stated in parentheses after the mass in running order. The mass for optional equipment specified by the manufacturer is an imputed value determined for each type and layout by which Dethleffs specifies the maximum weight available for factory-fitted optional equipment. The purpose of limiting optional equipment is to ensure that the minimum payload, i.e. the legally required free mass for baggage and retrofitted accessories, is actually available for the load capacity of vehicles delivered by

Dethleffs. The actual weight of your vehicle after leaving the factory can only be determined when it is weighed at the end of the line. If, in exceptional cases, the weighing shows that the actual load capacity falls short of the minimum payload due to a permissible weight deviation, despite the limitation of the optional equipment, we will check together with your trading partner and you before delivery of the vehicle whether we should, for example, increase the load capacity of the vehicle or remove optional equipment. The technically permissible maximum laden mass of the vehicle must not be exceeded. For detailed information and explanations on the topic of weight and the configuration of the vehicle, please refer to the "Legal notes" section.

Nomad

Technical info

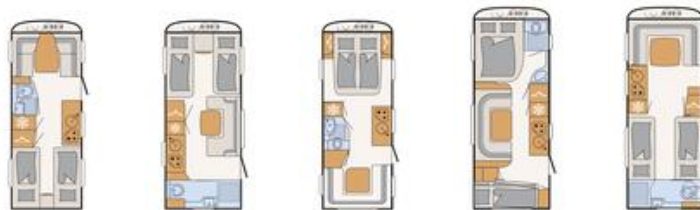

Nomad		510 LE	520 ELT	530 DR	560 FMK	560 RET
Standard chassis		Lightweight chassis, 1600 kg	Lightweight chassis, 1700 kg	Lightweight chassis, 1600 kg	Lightweight chassis, 1700 kg	Lightweight chassis, 1700 kg
Overall length, approx.	cm	762	762	788	818	818
Body length approx.	cm	630	630	650	675	675
Overall width, approx.	cm	230	250	230	250	250
Overall height, approx.	cm	265	265	265	265	265
Circumferential dimension awning approx.	cm	1028	1028	1048	1078	1078
Headroom in living area, approx.	cm	198	198	198	198	198
Thickness floor / side walls / roof	mm	42 / 34 / 34	42 / 34 / 34	42 / 34 / 34	42 / 34 / 34	42 / 34 / 34
Tire size		185 R14C 8PR	195 R14C LI106	185 R14C 8PR	195 R14C LI106	195 R14C LI106
Bed dimension: Front bed, L x W, approx.	cm	210 x 135	200 x 85 / 190 x 85 / 190 x 210 ○	205 x 150	200 x 155	230 x 150
Bed dimension: Central / middle bed, L X W, approx.	cm		185 x 90		230 x 115	2x 200 x 85 / 200 x 210 ○
Bed dimension: Rear bed, L x W, approx.	cm	2x 200 x 85 / 200 x 215 ○		210 x 135	195 x 70 / 190 x 75 / 195 x 75 ○ / 195 x 80 ○ / 195 x 70 ○	
Sleeping berths standard / max.		4	3	4	5 / 6 ○	4
Mass in running order (+/-5%)*	kg	1380 (1311 to 1449)*	1490 (1416 to 1565)*	1395 (1325 to 1465)*	1550 (1473 to 1628)*	1545 (1468 to 1622)*
Manufacturer-specified mass for optional equipment*	kg	117	117	100	33	48
Technically permissible maximum laden mass*	kg	1600	1700	1600	1700	1700
Heating		S 3004, 3.5 kW Gas / Combi 4 G/E, 4 kW Gas-Electric ○	Combi 6 G/E, 6 kW Gas-Electric / Hot water heating, 6.4 kW Gas-Electric ○	S 5004, 6 kW Gas / Combi 6 G/E, 6 kW Gas-Electric ○ / Hot water heating, 6.4 kW Gas-Electric ○	S 5004, 6 kW Gas / Combi 6 G/E, 6 kW Gas-Electric ○ / Hot water heating, 6.4 kW Gas-Electric ○	S 5004, 6 kW Gas / Combi 6 G/E, 6 kW Gas-Electric ○ / Hot water heating, 6.4 kW Gas-Electric ○



* INFO

The specified mass in running order is a standard value defined in the type approval procedure. Due to manufacturing tolerances, the actual weighed mass in running order may deviate from the value stated above. Deviations of up to ± 5% of the mass in running order are legally permissible and possible. The permissible range in kilograms is stated in parentheses after the mass in running order. The mass for optional equipment specified by the manufacturer is an imputed value determined for each type and layout by which Dethleffs specifies the maximum weight available for factory-fitted optional equipment. The purpose of limiting optional equipment is to ensure that the minimum payload, i.e. the legally required free mass for baggage and retrofitted accessories, is actually available for the load capacity of vehicles delivered by

Dethleffs. The actual weight of your vehicle after leaving the factory can only be determined when it is weighed at the end of the line. If, in exceptional cases, the weighing shows that the actual load capacity falls short of the minimum payload due to a permissible weight deviation, despite the limitation of the optional equipment, we will check together with your trading partner and you before delivery of the vehicle whether we should, for example, increase the load capacity of the vehicle or remove optional equipment. The technically permissible maximum laden mass of the vehicle must not be exceeded. For detailed information and explanations on the topic of weight and the configuration of the vehicle, please refer to the "Legal notes" section.

Nomad

Technical info



Nomad		510 LE	520 ELT	530 DR	560 FMK	560 RET
Refrigerator volume (thereof freezer), approx.	l	137 (15)	137 (15)	137 (15)	137 (15)	137 (15)
Waste water tank, approx.	l	22	22	22	22	22
Fresh water tank capacity, total/ Fresh water tank capacity at driving filling	l	43 / 15	48 / 15	43 / 15	43 / 15	43 / 15
Sockets: 12 V / 230 V / USB		0 / 7 / 1	0 / 0 / 1	0 / 9 / 1	0 / 9 / 3	0 / 7 / 1



The specified mass in running order is a standard value defined in the type approval procedure. Due to manufacturing tolerances, the actual weighed mass in running order may deviate from the value stated above. Deviations of up to $\pm 5\%$ of the mass in running order are legally permissible and possible. The permissible range in kilograms is stated in parentheses after the mass in running order. The mass for optional equipment specified by the manufacturer is an imputed value determined for each type and layout by which Dethleffs specifies the maximum weight available for factory-fitted optional equipment. The purpose of limiting optional equipment is to ensure that the minimum payload, i.e. the legally required free mass for baggage and retrofitted accessories, is actually available for the load capacity of vehicles delivered by

Dethleffs. The actual weight of your vehicle after leaving the factory can only be determined when it is weighed at the end of the line. If, in exceptional cases, the weighing shows that the actual load capacity falls short of the minimum payload due to a permissible weight deviation, despite the limitation of the optional equipment, we will check together with your trading partner and you before delivery of the vehicle whether we should, for example, increase the load capacity of the vehicle or remove optional equipment. The technically permissible maximum laden mass of the vehicle must not be exceeded. For detailed information and explanations on the topic of weight and the configuration of the vehicle, please refer to the "Legal notes" section.

Nomad

Technical info

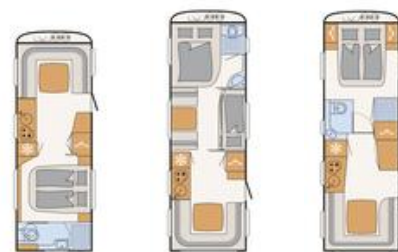

Nomad		650 RQT	730 FKR	760 DR
Standard chassis		Lightweight chassis, 2000 kg	Lightweight chassis, 2200 kg	Lightweight chassis, 2200 kg
Overall length, approx.	cm	872	942	942
Body length approx.	cm	735	805	805
Overall width, approx.	cm	250	250	250
Overall height, approx.	cm	265	265	265
Circumferential dimension awning approx.	cm	1138	1208	1208
Headroom in living area, approx.	cm	198	198	198
Thickness floor / side walls / roof	mm	42 / 34 / 34	42 / 34 / 34	42 / 34 / 34
Tire size		185/70 R14 LI88	195/70 R14C LI104	195/70 R14C LI104
Bed dimension: Front bed, L x W, approx.	cm	230 x 155	200 x 155	200 x 150
Bed dimension: Central / middle bed, L X W, approx.	cm	200 x 155	200 x 75 / 2x 195 x 75 / 2x 195 x 75 ○	
Bed dimension: Rear bed, L x W, approx.	cm		230 x 155	230 x 180
Sleeping berths standard / max.		4	7 / 8 ○	4
Mass in running order (+/-5%)*	kg	1760 (1672 to 1848)*	1855 (1762 to 1948)*	1825 (1734 to 1916)*
Manufacturer-specified mass for optional equipment*	kg	127	195	255
Technically permissible maximum laden mass*	kg	2000	2200	2200
Heating		S 5004, 6 kW Gas / Combi 6 G/E, 6 kW Gas-Electric ○ / Hot water heating, 6.4 kW Gas-Electric ○	S 5004, 6 kW Gas / Combi 6 G/E, 6 kW Gas-Electric ○ / Hot water heating, 6.4 kW Gas-Electric ○	S 5004, 6 kW Gas / Combi 6 G/E, 6 kW Gas-Electric ○ / Hot water heating, 6.4 kW Gas-Electric ○
Refrigerator volume (thereof freezer), approx.	l	137 (15)	86 (11) / 156 (29) ○	156 (29) / 177 (35) ○
Waste water tank, approx.	l	22	22	22



The specified mass in running order is a standard value defined in the type approval procedure. Due to manufacturing tolerances, the actual weighed mass in running order may deviate from the value stated above. Deviations of up to ± 5% of the mass in running order are legally permissible and possible. The permissible range in kilograms is stated in parentheses after the mass in running order. The mass for optional equipment specified by the manufacturer is an imputed value determined for each type and layout by which Dethleffs specifies the maximum weight available for factory-fitted optional equipment. The purpose of limiting optional equipment is to ensure that the minimum payload, i.e. the legally required free mass for baggage and retrofitted accessories, is actually available for the load capacity of vehicles delivered by

Dethleffs. The actual weight of your vehicle after leaving the factory can only be determined when it is weighed at the end of the line. If, in exceptional cases, the weighing shows that the actual load capacity falls short of the minimum payload due to a permissible weight deviation, despite the limitation of the optional equipment, we will check together with your trading partner and you before delivery of the vehicle whether we should, for example, increase the load capacity of the vehicle or remove optional equipment. The technically permissible maximum laden mass of the vehicle must not be exceeded. For detailed information and explanations on the topic of weight and the configuration of the vehicle, please refer to the "Legal notes" section.

Nomad

Technical info

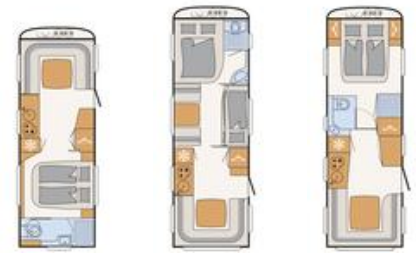

Nomad		650 RQT	730 FKR	760 DR
Fresh water tank capacity, total/ Fresh water tank capacity at driving filling	l	43 / 15	43 / 15	43 / 15
Sockets: 12 V / 230 V / USB		0 / 9 / 1	0 / 10 / 3	0 / 9 / 1

○ Optional equipment — Not possible ● Standard equipment ◆ Mandatory ▲ Not known at the time of publication



The specified mass in running order is a standard value defined in the type approval procedure. Due to manufacturing tolerances, the actual weighed mass in running order may deviate from the value stated above. Deviations of up to $\pm 5\%$ of the mass in running order are legally permissible and possible. The permissible range in kilograms is stated in parentheses after the mass in running order. The mass for optional equipment specified by the manufacturer is an imputed value determined for each type and layout by which Dethleffs specifies the maximum weight available for factory-fitted optional equipment. The purpose of limiting optional equipment is to ensure that the minimum payload, i.e. the legally required free mass for baggage and retrofitted accessories, is actually available for the load capacity of vehicles delivered by

Dethleffs. The actual weight of your vehicle after leaving the factory can only be determined when it is weighed at the end of the line. If, in exceptional cases, the weighing shows that the actual load capacity falls short of the minimum payload due to a permissible weight deviation, despite the limitation of the optional equipment, we will check together with your trading partner and you before delivery of the vehicle whether we should, for example, increase the load capacity of the vehicle or remove optional equipment. The technically permissible maximum laden mass of the vehicle must not be exceeded. For detailed information and explanations on the topic of weight and the configuration of the vehicle, please refer to the "Legal notes" section.

Standard equipment

	460 EL	470 FR	490 BLF	490 EST	510 ER	510 LE	520 ELT	530 DR	560 FMK	560 RET	650 RQT	730 FKR	760 DR
--	--------	--------	---------	---------	--------	--------	---------	--------	---------	---------	---------	---------	--------

Chassis													
Single axle premium wheel 195 R14 C LI106 (with steel wheel 1.700 kg and 1.800 kg)	-	-	-	-	-	-	●	-	●	●	-	-	-
Tandem axle premium wheel 195/70 R14 C LI104 (with steel wheel 2.200 kg to 2.800 kg)	-	-	-	-	-	-	-	-	-	-	-	●	●
Tyres on steel wheels 185 R14 C 8 PR, up to and including 1.600 kg	●	●	●	●	●	●	-	●	-	-	-	-	-
Tyres on steel wheels 185/70 R14 LI88 up to and including 2.000 kg	-	-	-	-	-	-	-	-	-	-	●	-	-
Zinc-plated chassis with inertia braking system with reversing automatic	●	●	●	●	●	●	●	●	●	●	●	●	●
Chassis features													
AAA self-adjusting brake	●	●	●	●	●	●	●	●	●	●	●	●	●
ACS stabiliser	●	●	●	●	●	●	●	●	●	●	●	●	●
High-quality brand-name tyres, designed for a speed of 100 km/h	●	●	●	●	●	●	●	●	●	●	●	●	●
Lightweight corner steadies	●	●	●	●	●	●	●	●	●	●	●	●	●
Octagon shock absorber	●	●	●	●	●	●	●	●	●	●	●	●	●
Exterior features													
Floor of the gas bottle locker made of rot-resistant and robust corrugated aluminium	●	●	●	●	●	●	●	●	●	●	●	●	●
Flyscreen door	●	●	●	●	●	●	●	●	●	●	●	●	●
Front parts in gas locker area made of LFI (long fiber injection) technology, shock resistant, robust and repair-friendly	●	●	●	●	●	●	●	●	●	●	●	●	●
Fully-insulated wheel houses	●	●	●	●	●	●	●	●	●	●	●	●	●
Midi Heki lift-and-tilt skylight incl. illuminated roof lining	●	●	●	●	●	●	●	●	●	●	●	●	●
One-piece habitation door with window	●	●	●	●	●	●	●	●	●	●	●	●	●
Opening window in bathroom	-	-	-	●	-	-	-	-	●	●	●	●	●
Opening windows, trapezoid, insulated and double-glazed (graphite grey) with blackout and mosquito blinds	●	●	●	●	●	●	●	●	●	●	●	●	●
Panoramic front window ¹⁰⁾	-	-	●	-	-	-	-	-	-	-	-	-	-
Robust GRP roof	●	●	●	●	●	●	●	●	●	●	●	●	●
Sidewall skirts with integrated side-marker lamps	●	●	●	●	●	●	●	●	●	●	●	●	●
Skylight Mini Heki	●	●	●	●	●	●	●	●	●	●	●	●	●
Space-saving gas locker door which opens upwards	●	●	●	●	●	●	●	●	●	●	●	●	●
Spare wheel carrier in gas locker	●	●	●	●	●	●	●	●	●	●	●	●	●
Storage space for 2 gas bottles with 11 kg filling weight each	●	●	●	●	●	●	●	●	●	●	●	●	●
Exterior design													
Front and rear in smooth sides white	●	●	●	●	●	●	●	●	●	●	●	●	●
Manoeuvring handles in chrome design	●	●	●	●	●	●	●	●	●	●	●	●	●
Sides in hammer finish, white	●	●	●	●	●	●	●	●	●	●	●	●	●
Access locker doors													
Access locker door front right side 997x419 mm	●	-	-	●	●	-	●	-	-	-	-	-	-
Access locker door rear left side 997x419 mm	-	-	●	-	-	-	-	-	-	●	-	-	-
Interior design													
Upholstery Ruby	●	●	●	●	●	●	●	●	●	●	●	●	●
Wood décor Noce Nagano	●	●	●	●	●	●	●	●	●	●	●	●	●
Textile equipment													
7-zones double bed mattress, made of heat-regulating material	-	●	●	-	-	-	-	●	●	-	●	●	●
7-zones mattress left side, made of heat-regulating material	●	-	-	●	●	●	●	-	-	●	-	-	-
7-zones mattress right side, made of heat-regulating material	●	-	-	●	●	●	●	-	-	●	-	-	-
Furniture layouts													
AirPlus - perfect air circulation in the interior and rear ventilation of the overhead lockers and sideboards	●	●	●	●	●	●	●	●	●	●	●	●	●
Bunk bed with 2 sleeping berths, foldable	-	-	-	-	-	-	-	-	●	-	-	-	-
Bunk bed with 2 sleeping berths, not foldable	-	-	-	-	-	-	-	-	-	-	-	●	-
Bunk beds with safety net and ladder	-	-	-	-	-	-	-	-	●	-	-	●	-
One-legged telescopic table, height adjustable	-	●	●	-	●	-	●	●	●	●	●	●	●

Standard equipment

	460 EL	470 FR	490 BLF	490 EST	510 ER	510 LE	520 ELT	530 DR	560 FMK	560 RET	650 RQT	730 FKR	760 DR
Seating lounge converts to bed	●	●	●	●	●	●	●	●	●	●	●	●	●
Special slatted frame with flexible natural rubber holders, opening for optimal use of storage compartments under the beds	●	●	●	●	●	●	●	●	●	●	●	●	●
Kitchen													
Generous drawers with soft closing for absolutely silent closing	●	●	●	●	●	●	●	●	●	●	●	●	●
Kitchen worktop with indirect lighting	●	●	●	●	●	●	●	●	●	●	●	●	●
Large fridge with 137 liters capacity and 15 liters freezer compartment	●	●	●	●	●	●	●	●	●	●	●	—	—
Practical 3-flames cooker with electric ignition	●	●	●	●	●	●	●	●	●	●	●	●	●
Practical apothecary drawers (depending on layout)	●	●	●	●	●	●	●	●	●	●	●	●	●
Spacious fridge with 86-litre volume and 11 litre freezer	—	—	—	—	—	—	—	—	—	—	—	●	—
Bathroom													
Integrated design washbasin made of solid surface material	●	●	●	●	●	●	●	●	●	●	●	●	●
Shower tray	●	●	●	●	●	●	●	●	●	●	●	●	●
Skylight with mosquito net	●	●	●	●	●	●	●	●	●	●	●	●	●
Heating													
Gas heating S 3004 with automatic ignition	●	●	—	—	●	●	—	—	—	—	—	—	—
Gas heating S 5004 with automatic ignition	—	—	—	—	—	—	—	●	●	●	●	●	●
Hot air system	●	●	●	●	●	●	●	●	●	●	●	●	●
Electrical installation													
12 V power supply throughout vehicle	●	●	●	●	●	●	●	●	●	●	●	●	●
Awning light 12V	●	●	●	●	●	●	●	●	●	●	●	●	●
CEE external output socket for 230V on-board electrics	●	●	●	●	●	●	●	●	●	●	●	●	●
Compact power distribution unit with 230V safety device and 12V fuse box in wardrobe incl. powerful 340W transformer	●	●	●	●	●	●	●	●	●	●	●	●	●
Illuminated kitchen back panel	●	●	●	●	●	●	●	●	●	●	●	●	●
Indirect lighting	●	●	●	●	●	●	●	●	●	●	●	●	●
LED light bar system 12V (on head-side of bed and in seating lounge)	●	●	●	●	●	●	●	●	●	●	●	●	●
USB port for spotlight bar	●	●	●	●	●	●	●	●	●	●	●	●	●
Water supply													
Electric water supply	●	●	●	●	●	●	●	●	●	●	●	●	●
Fresh water tank 38 l	●	●	●	●	●	●	●	●	●	●	●	●	●
Hot water supply	●	●	—	—	●	●	—	●	●	●	●	●	●
Mobile 22 l waste water tank	●	●	●	●	●	●	●	●	●	●	●	●	●

Packages Nomad

Package	Styling Package white (single axle) (13254)	Styling Package white (single axle) (13254)	Styling Package white (single axle) (13254)	Styling Package white (tandem axle) (13256)	Styling Package white (tandem axle) (13256)	Styling Package white (tandem axle 2.8 t) (13258)
Smooth sides white	x					
17" alloy wheels in Dethleffs design (single axle)	x	x	x			
Draw bar cover	x	x	x	x	x	x
Large support feet, 4 pc.	x	x	x	x	x	x
Solid rubber support wheel with support load indicator	x	x	x	x	x	x
Manoeuvring handles in chrome design	x	x	x	x	x	x
Rear light carrier with high attachment and roof rails	x	x	x	x	x	x
Front moulding with high attachment and roof rails	x	x	x	x	x	x
Smooth sides white		x				
Smooth sides white			x	x		
17" alloy wheels in Dethleffs design (tandem axle)				x	x	
Smooth sides white					x	x
Tyres on alloy wheels 195/70 R14 C LI104, 2200 kg to 2800 kg						x
Additional weight (kg)*	45.7	48.3	51.1	41.1	43.4	47.4



The factory installation of optional equipment increases the actual mass of the vehicle and reduces the payload. The specified additional weight for packages and optional equipment shows the additional weight compared with the standard equipment of the respective model or layout. The total weight of the selected optional equipment must not exceed the mass for optional equipment specified by the manufacturer in the model overviews. This is an imputed

value determined for each model and layout that Dethleffs uses to determine the maximum weight available for factory-installed optional equipment. In the event of an increase of load capacity, the mass for optional equipment specified by the manufacturer is increased. For detailed information and explanations on the topic of weight, please refer to the "Legal notes" section.

Package	Styling Package silver (single axle) (13255)	Styling Package silver (single axle) (13255)	Styling Package silver (single axle) (13255)	Styling Package silver (tandem axle) (13257)	Styling Package silver (tandem axle) (13257)	Styling Package silver (tandem axle 2.8 t) (13259)
Smooth sides titanium silver metallic	x					
17" alloy wheels in Dethleffs design (single axle)	x	x	x			
Draw bar cover	x	x	x	x	x	x
Large support feet, 4 pc.	x	x	x	x	x	x
Solid rubber support wheel with support load indicator	x	x	x	x	x	x
Manoeuvring handles in chrome design	x	x	x	x	x	x
Rear light carrier with high attachment and roof rails	x	x	x	x	x	x
Front moulding with high attachment and roof rails	x	x	x	x	x	x
Smooth sides titanium silver metallic		x				
Smooth sides titanium silver metallic			x	x		
17" alloy wheels in Dethleffs design (tandem axle)				x	x	
Smooth sides titanium silver metallic					x	x
Tyres on alloy wheels 195/70 R14 C LI104, 2200 kg to 2800 kg						x
Additional weight (kg)*	45.7	48.3	51.1	41.1	43.4	47.4

Package	Winter Comfort Package Combi 4 (10479)	Winter Comfort Package Combi 4 (10479)	Winter Comfort Package Combi 6 (9536)	Winter Comfort Package Combi 6 (9536)	Winter Comfort Package Combi 6 (9536)	Winter Comfort Package for Combi heating (10481)
Electric floor heating	x	x	x	x	x	x
Waste water pipes insulated and heated	x	x	x	x	x	x
Insulated threader hose	x	x	x	x	x	x
XPS insulation for front, rear and sides (depending on vehicle size)	x					
Hot air heating Combi 4 G/E incl. digital control unit	x	x				
XPS insulation for front, rear and sides (depending on vehicle size)		x	x			x
Hot air heating Combi 6 G/E incl. digital control unit			x	x	x	
XPS insulation for front, rear and sides (depending on vehicle size)				x		
XPS insulation for front, rear and sides (depending on vehicle size)					x	
Additional weight (kg)*	47.6	50.1	50.1	52.8	55	35.1



The factory installation of optional equipment increases the actual mass of the vehicle and reduces the payload. The specified additional weight for packages and optional equipment shows the additional weight compared with the standard equipment of the respective model or layout. The total weight of the selected optional equipment must not exceed the mass for optional equipment specified by the manufacturer in the model overviews. This is an imputed

value determined for each model and layout that Dethleffs uses to determine the maximum weight available for factory-installed optional equipment. In the event of an increase of load capacity, the mass for optional equipment specified by the manufacturer is increased. For detailed information and explanations on the topic of weight, please refer to the "Legal notes" section.

Package	Winter Comfort Package SNOW (5459)	Winter Comfort Package SNOW (5459)	Winter Comfort Package SNOW (5459)	Winter Comfort Package SNOW PLUS (5551)	Winter Comfort Package SNOW PLUS (5551)	Winter Comfort Package SNOW PLUS (5551)
Hot water heating	x	x	x	x	x	x
Electric floor heating	x	x	x			
Waste water pipes insulated and heated	x	x	x	x	x	x
XPS insulation for front, rear and sides (depending on vehicle size)	x			x		
XPS insulation for front, rear and sides (depending on vehicle size)		x			x	
XPS insulation for front, rear and sides (depending on vehicle size)			x			x
Hot water floor heating (only in comb. with option 205)				x	x	x
Additional weight (kg)*	74.1	76.8	79	75.1	77.8	80

Package	Mover Autonomy Package (single axle) (5560)	Mover Autonomy Package (tandem axle) (5561)
Mover manoeuvring support for single-axle	x	
Electric Autonomy equipment	x	x
Mover manoeuvring support for tandem-axle		x
Additional weight (kg)*	70	98

Package	Water and Electric Autonomy Package Combi 4 (11031)	Water and Electric Autonomy Package Combi 6 (11032)	Water & Electric Autonomy Package with Combi or hot water heating system (9943)
Hot air heating Combi 4 G/E incl. digital control unit	x		
Electric Autonomy equipment	x	x	x
Fresh water tank 70 l	x	x	x
Hot air heating Combi 6 G/E incl. digital control unit		x	
Additional weight (kg)*	55.5	55.5	40.5

Safety Package (8950)	
ATC Trailer Control	
DuoControl safety gas pressure regulator with crash sensor and EisEx gas regulator heater	
Smoke detector	
Additional weight (kg)*	7

Shower Package (6105)	
Shower equipment with shower fittings and curtain	
City water connection	
Additional weight (kg)*	7

△ Not known at the time of publication



The factory installation of optional equipment increases the actual mass of the vehicle and reduces the payload. The specified additional weight for packages and optional equipment shows the additional weight compared with the standard equipment of the respective model or layout. The total weight of the selected optional equipment must not exceed the mass for optional equipment specified by the manufacturer in the model overviews. This is an imputed

value determined for each model and layout that Dethleffs uses to determine the maximum weight available for factory-installed optional equipment. In the event of an increase of load capacity, the mass for optional equipment specified by the manufacturer is increased. For detailed information and explanations on the topic of weight, please refer to the "Legal notes" section.

Optional equipment**

	Included in package	Additional weight (kg)*	Code	460 EL	470 FR	490 BLF	490 EST	510 ER	510 LE	520 ELT	530 DR	560 FMK	560 RET	650 RQT	730 FKR	760 DR	
Chassis																	
17" alloy wheels in Dethleffs design (single axle)	STP	10	11608	○	○	○	○	○	○	○	○	○	○	○	○	○	○
17" alloy wheels in Dethleffs design (tandem axle)	STP	0	11609	—	—	—	—	—	—	—	—	—	—	○	○	○	
Tyres on alloy wheels 185 R14 C LI102, up to and including 1600 kg	—	0	836	○	○	○	○	○	○	—	○	—	—	—	—	—	
Tyres on alloy wheels 185/70 R14 LI88, up to and including 2000 kg	—	0	840	—	—	—	—	—	—	—	—	—	—	○	—	—	
Tyres on alloy wheels 195 R14 C LI106, 1700 kg and 1800 kg	—	2	838	○	○	○	○	○	○	○	○	○	○	—	—	—	
Tyres on alloy wheels 195/70 R14 C LI104, 2200 kg to 2800 kg	STP	4	859	—	—	—	—	—	—	—	—	—	—	○	○	○	
Weight upgrade																	
Weight upgrade 1.700 kg (incl. steel wheel 195 R14 C LI106)	—	24	278	○	○	○	○	○	—	—	○	—	—	—	—	—	
Weight upgrade 1.700 kg (incl. steel wheel 195 R14 C LI106)	—	0.3	278	—	—	—	—	—	○	—	—	—	—	—	—	—	
Weight upgrade 1.800 kg (incl. steel wheel 195 R14 C LI106)	—	31.6	279	—	—	—	—	—	○	—	—	—	—	—	—	—	
Weight upgrade 1.800 kg (incl. steel wheel 195 R14 C LI106)	—	27	279	—	○	○	○	○	—	—	○	○	○	—	—	—	
Weight upgrade 1.800 kg (incl. steel wheel 195 R14 C LI106)	—	8	279	—	—	—	—	—	○	—	—	—	—	—	—	—	
Weight upgrade 1.900 kg (incl. alloy wheel 225/70 R15 C LI112)	—	27	394	—	—	—	—	—	—	○	○	○	○	—	—	—	
Weight upgrade 2.000 kg (incl. alloy wheel 225/70 R15 C LI112)	—	27	138	—	—	—	—	—	—	○	○	○	○	—	—	—	
Weight upgrade 2.200 kg (incl. steel wheel 195/70 R14 C LI104)	—	1.5	6351	—	—	—	—	—	—	—	—	—	—	○	—	—	
Weight upgrade 2.500 kg (incl. steel wheel 195/70 R14 C LI104)	—	1.5	496	—	—	—	—	—	—	—	—	—	—	○	—	—	
Weight upgrade 2.500 kg (incl. steel wheel 195/70 R14 C LI104)	—	0	496	—	—	—	—	—	—	—	—	—	—	—	○	○	
Weight upgrade to 1.600 kg	—	24	322	○	○	○	○	○	—	—	—	—	—	—	—	—	
Weight upgrade 2.800 kg (incl. steel wheel 195/70 R14 C LI104)	—	24.9	7713	—	—	—	—	—	—	—	—	—	—	—	○	○	
Chassis features																	
ATC Trailer Control	SHF	4	748	○	○	○	○	○	○	○	○	○	○	○	○	○	
Breakdown kit	—	1	620	○	○	○	○	○	○	○	○	○	○	○	○	○	
Draw bar cover	STP	2	434	○	○	○	○	○	○	○	○	○	○	○	○	○	
Large support feet, 4 pc.	STP	1	6348	○	○	○	○	○	○	○	○	○	○	○	○	○	
Solid rubber support wheel with support load indicator	STP	2	10063	○	○	○	○	○	○	○	○	○	○	○	○	○	
Spare tyre with alloy wheel 185 R14 C LI 102, up to and including 1.600 kg	—	17	837	○	○	—	○	○	○	—	○	—	—	—	—	—	
Spare tyre with alloy wheel 185/70 R14 LI 88, up to and including 2.000 kg	—	18	841	—	—	—	—	—	—	—	—	—	—	○	—	—	
Spare tyre with alloy wheel 195 R14 C 8PR-LI 106, 1.700 kg and 1.800 kg	—	19	839	○	○	—	○	○	○	○	○	○	—	—	—	—	
Spare tyre with alloy wheel 195/70 R14 C-LI 102, 2.200 kg to 2.800 kg	—	19	861	—	—	—	—	—	—	—	—	—	—	○	○	○	
Spare tyre with alloy wheel 225/70 R15 C LI 112 , 1.900 kg and 2.000 kg	—	23.5	1092	—	—	—	—	—	—	○	—	○	—	—	—	—	
Spare tyre with steel wheel 185 R14 C 8 PR, up to and including 1.600 kg	—	18	831	○	○	—	○	○	○	—	○	—	—	—	—	—	



The factory installation of optional equipment increases the actual mass of the vehicle and reduces the payload. The specified additional weight for packages and optional equipment shows the additional weight compared with the standard equipment of the respective model or layout. The total weight of the selected optional equipment must not exceed the mass for optional equipment specified by the manufacturer in the model overviews. This is an imputed

value determined for each model and layout that Dethleffs uses to determine the maximum weight available for factory-installed optional equipment. In the event of an increase of load capacity, the mass for optional equipment specified by the manufacturer is increased. For detailed information and explanations on the topic of weight, please refer to the "Legal notes" section.

Optional equipment**

	Included in package	Additional weight (kg)*	Code	460 EL	470 FR	490 BLF	490 EST	510 ER	510 LE	520 ELT	530 DR	560 FMK	560 RET	650 RQT	730 FKR	760 DR
Spare tyre with steel wheel 185/70 R14 LI 88, up to and including 2.000 kg	—	18	835	—	—	—	—	—	—	—	—	—	—	○	—	—
Spare tyre with steel wheel 195 R14 C LI 106, 1.700 kg and 1.800 kg	—	19.5	833	○	○	—	○	○	○	○	○	○	—	—	—	—
Spare tyre with steel wheel 195/70 R14 C-LI 104, 2.200 kg to 2.800 kg	—	20	860	—	—	—	—	—	—	—	—	—	—	○	○	○
Wheel trims for 14" tyres	—	2	276	○	○	○	○	○	○	○	○	○	○	○	○	○
Exterior features																
Cassette awning 3750x2500 mm, manual	—	25.5	6928	○	○	—	—	—	—	—	—	—	—	—	—	—
Cassette awning 4000x2500 mm, manual	—	27.5	6928	—	—	○	○	○	○	○	—	—	—	—	—	—
Cassette awning 4500x2500 mm, manual	—	30	6928	—	—	—	—	—	—	—	○	○	○	—	—	—
Cassette awning 5500x3000 mm, manual	—	50.6	6928	—	—	—	—	—	—	—	—	—	—	○	—	—
Cassette awning 6000x3000 mm, manual	—	54.6	6928	—	—	—	—	—	—	—	—	—	—	—	○	○
Flush-fitting windows (not possible for front and rear windows) ⁸⁾	—	3	7561	○	○	○	○	○	○	○	○	○	○	○	○	○
Front window	—	4	982	○	—	—	○	○	●	○	○	—	●	●	—	○
Front window (bed area), if washroom in front	—	5	855	—	○	—	—	—	—	—	—	○	—	—	○	—
Heki II skylight incl. illuminated roof lining	—	8	274	○	○	—	○	○	○	○	○	○	○	○	○	○
Rear window	—	4	1108	●	—	○	—	—	○	—	●	—	—	—	●	●
XPS insulation for front, rear and sides (depending on vehicle size)	WI-KO	17.6	179	○	○	—	—	—	—	—	—	—	—	—	—	—
XPS insulation for front, rear and sides (depending on vehicle size)	WI-KO	20.1	179	—	—	○	○	○	○	○	○	—	—	○	—	—
XPS insulation for front, rear and sides (depending on vehicle size)	WI-KO	22.8	179	—	—	—	—	—	—	—	—	○	○	—	—	—
XPS insulation for front, rear and sides (depending on vehicle size)	WI-KO	25	179	—	—	—	—	—	—	—	—	—	—	—	○	○
Exterior design																
Front moulding with high attachment and roof rails	STP	1	627	○	○	○	○	○	○	○	○	○	○	○	○	○
Rear light carrier with high attachment and roof rails	STP	11	624	○	○	○	○	○	○	○	○	○	○	○	○	○
Smooth sides titanium silver metallic	STP	18.7	659	○	○	—	—	—	—	—	—	—	—	—	—	—
Smooth sides titanium silver metallic	STP	21.3	659	—	—	○	○	○	○	○	○	—	—	—	—	—
Smooth sides titanium silver metallic	STP	24.1	659	—	—	—	—	—	—	—	—	○	○	○	—	—
Smooth sides titanium silver metallic	STP	26.4	659	—	—	—	—	—	—	—	—	—	—	—	○	○
Smooth sides white	STP	18.7	443	○	○	—	—	—	—	—	—	—	—	—	—	—
Smooth sides white	STP	21.3	443	—	—	○	○	○	○	○	○	—	—	—	—	—
Smooth sides white	STP	24.1	443	—	—	—	—	—	—	—	—	○	○	○	—	—
Smooth sides white	STP	26.4	443	—	—	—	—	—	—	—	—	—	—	—	○	○
Access locker doors																
Access locker door front left 997x419 mm	—	2.2	1079	—	●	—	—	○	—	○	—	●	—	—	●	—
Access locker door front left side 1069x299 mm	—	2	1083	—	—	—	—	—	○	—	—	—	—	—	—	—
Access locker door front left side 648x348 mm	—	2	1071	—	○	—	—	○	—	○	○	—	—	—	—	○
Access locker door front right side 1069x299 mm	—	2	1084	—	—	—	—	—	○	—	—	—	○	○	—	—
Access locker door front right side 648x348 mm	—	2	1072	—	—	—	—	—	—	—	●	—	—	—	—	○
Access locker door rear left side 1069x299 mm	—	2	1085	—	—	—	—	—	—	—	—	—	—	—	○	—
Access locker door rear left side 749x297 mm	—	2	1077	○	○	—	—	—	—	—	—	—	—	—	—	—



The factory installation of optional equipment increases the actual mass of the vehicle and reduces the payload. The specified additional weight for packages and optional equipment shows the additional weight compared with the standard equipment of the respective model or layout. The total weight of the selected optional equipment must not exceed the mass for optional equipment specified by the manufacturer in the model overviews. This is an imputed

value determined for each model and layout that Dethleffs uses to determine the maximum weight available for factory-installed optional equipment. In the event of an increase of load capacity, the mass for optional equipment specified by the manufacturer is increased. For detailed information and explanations on the topic of weight, please refer to the "Legal notes" section.

Optional equipment**

	Included in package	Additional weight (kg)*	Code	460 EL	470 FR	490 BLF	490 EST	510 ER	510 LE	520 ELT	530 DR	560 FMK	560 RET	650 RQT	730 FKR	760 DR
Access locker door rear right side 1069x299 mm	—	2	1086	—	—	—	—	○	—	—	○	—	—	—	○	●
Access locker door rear right side 749x297 mm	—	2	1078	○	○	—	—	—	—	—	—	—	—	—	—	—
Access locker door rear right side 997x419 mm	—	2.2	1082	—	—	—	—	—	●	—	—	—	○	●	—	—
Interior design																
Upholstery Champion	—	0	10489	○	○	○	○	○	○	○	○	○	○	○	○	○
Upholstery Chromo	—	0	10488	○	○	○	○	○	○	○	○	○	○	○	○	○
Textile equipment																
7-zones double bed mattress, made of heat-regulating material with watergel cover	—	4	8214	—	○	○	—	—	—	—	○	○	—	○	○	○
7-zones mattress left side, made of heat-regulating material with watergel cover	—	2	8215	○	—	—	○	○	○	○	—	—	○	—	—	—
7-zones mattress right side, made of heat-regulating material with watergel cover	—	5	8216	○	—	—	○	○	○	○	—	—	○	—	—	—
Corner head rests for U-shaped seating lounge	—	2	9236	—	○	—	—	○	—	—	○	○	○	○	○	○
Loose carpet	—	8.5	513	○	○	○	○	○	○	○	○	○	○	○	○	○
Furniture layouts																
Bunk bed with 2 sleeping berths, not foldable, instead of seating lounge	—	0	9775	—	—	—	—	—	—	—	—	—	—	—	○	—
Bunk bed with 3 sleeping berths, not foldable	—	20	200	—	—	—	—	—	—	—	—	○	—	—	—	—
Single beds convert to double bed	—	5	685	○	—	—	○	○	○	○	—	—	○	—	—	—
Slatted bed frame with adjustable head section	—	1	871	○	—	—	○	○	○	○	—	—	○	—	—	—
Interior features																
2 kg fire extinguisher	—	3.5	843	○	○	○	○	○	○	○	○	○	○	○	○	○
Smoke detector	SHP	0.5	8949	○	○	○	○	○	○	○	○	○	○	○	○	○
Kitchen																
Extractor fan	—	3	785	○	○	—	○	○	○	○	○	○	○	○	○	○
Kitchen unit with large fridge (175 l), separate freezer and electric ignition	—	18	429	—	—	—	—	—	—	—	—	—	—	—	○	●
Kitchen worktop extension, foldable	—	1	1107	—	○	—	—	○	—	—	—	—	○	○	○	○
Large fridge with 177 l volume and 35 l freezer, with oven (TecTower)	—	15	936	—	—	—	—	—	—	—	—	—	—	—	—	○
Oven	—	17	572	○	○	○	○	○	○	○	○	○	○	○	○	—
Bathroom																
Bathroom in alternative design	—	4	604	—	—	—	—	—	—	—	—	○	—	—	○	—
Multimedia																
FS-SAT system Voyager 65 Digimatic	—	10	1049	—	○	○	○	○	○	○	—	—	○	○	○	○
Flat screen TV 22" incl. DVD player and receiver	—	3.5	1103	○	○	○	○	○	○	○	○	○	○	○	○	○
Multifunctional external connection, 12 V, 220 V, TV and SAT	—	1	611	○	○	○	○	○	○	○	○	○	○	○	○	○
Preparation for flat screen TV (antenna cable and TV bracket)	—	2	678	○	○	○	○	○	○	○	○	○	○	○	○	○
SAT parabol antenna flat 65 Easy 65 Twin	—	14	879	—	○	○	○	○	○	○	—	○	○	○	○	○
TV preparation in sleeping area	—	2	9360	—	—	—	—	—	—	—	—	—	—	○	—	—
Heating																
Electric floor heating	WI-KO	9	387	○	○	○	○	○	○	○	○	○	○	○	○	○
Fan 12 V with automatic speed control for S 5004	—	2	178	—	—	—	—	—	—	—	○	○	○	○	○	○



The factory installation of optional equipment increases the actual mass of the vehicle and reduces the payload. The specified additional weight for packages and optional equipment shows the additional weight compared with the standard equipment of the respective model or layout. The total weight of the selected optional equipment must not exceed the mass for optional equipment specified by the manufacturer in the model overviews. This is an imputed

value determined for each model and layout that Dethleffs uses to determine the maximum weight available for factory-installed optional equipment. In the event of an increase of load capacity, the mass for optional equipment specified by the manufacturer is increased. For detailed information and explanations on the topic of weight, please refer to the "Legal notes" section.

Optional equipment**

	Included in package	Additional weight (kg)*	Code	460 EL	470 FR	490 BLF	490 EST	510 ER	510 LE	520 ELT	530 DR	560 FMK	560 RET	650 RQT	730 FKR	760 DR
Fan 12V for S 3004	—	2	177	○	○	—	—	○	○	—	—	—	—	—	—	—
Hot air heating Combi 4 G/E incl. digital control unit	WEA-P, WI-KO	15	10480	○	○	●	●	○	○	—	—	—	—	—	—	—
Hot air heating Combi 6 G/E incl. digital control unit	WEA-P, WI-KO	15	9427	—	—	—	—	—	—	●	○	○	○	○	○	○
Hot water floor heating (only in comb. with option 205) ⁹⁾	WI-KO	10	674	—	—	—	—	—	—	○	○	○	○	○	○	○
Hot water heating	WI-KO	40	205	—	—	—	—	—	—	○	○	○	○	○	○	○
Ultraheat additional heating for S 3004, electric 220 V	—	2	364	○	○	—	—	○	○	—	—	—	—	—	—	—
Ultraheat additional heating for S 5004, electric 220 V	—	2	422	—	—	—	—	—	—	—	○	○	○	○	○	○
Air Conditioning																
Pre-wiring for A/C	—	0	172	○	○	○	○	○	○	○	○	○	○	○	○	○
Roof A/C	—	35	8145	○	○	○	○	○	○	○	○	○	○	○	○	○
Electrical installation																
Electric Autonomy equipment	WEA-P, M-P	38	492	○	○	○	○	○	○	○	○	○	○	○	○	○
Water supply																
City water connection	DUP	2	414	○	○	○	○	○	○	○	○	○	○	○	○	○
Exterior shower	—	2	396	○	○	○	○	○	○	○	○	○	○	○	○	○
Fresh water tank 70 l	WEA-P	2.5	592	○	○	○	○	○	○	○	○	○	○	○	○	○
Shower equipment with shower fittings and curtain	DUP	5	1097	○	○	○	○	○	○	○	○	○	○	○	○	○
Waste water pipes insulated and heated	WI-KO	5	520	○	○	○	○	○	○	○	○	○	○	○	○	○
Gas supply																
DuoControl safety gas pressure regulator with crash sensor and EisEx gas regulator heater	SHP	2.5	784	○	○	○	○	○	○	○	○	○	○	○	○	○
Gas socket (exterior)	—	1	187	○	○	○	○	○	○	○	○	○	○	○	○	○
Packages																
Mover Autonomy Package (single axle)	—	70	5560	○	○	○	○	○	○	○	○	○	○	○	—	—
Mover Autonomy Package (tandem axle)	—	98	5561	—	—	—	—	—	—	—	—	—	—	—	○	○
Safety Package	—	7	8950	○	○	○	○	○	○	○	○	○	○	○	○	○
Shower Package	—	7	6105	○	○	○	○	○	○	○	○	○	○	○	○	○
Styling Package silver (single axle)	—	51.1	13255	—	—	—	—	—	—	—	—	○	○	—	—	—
Styling Package silver (single axle)	—	48.3	13255	—	—	○	○	○	○	○	○	—	—	—	—	—
Styling Package silver (single axle)	—	45.7	13255	○	○	—	—	—	—	—	—	—	—	—	—	—
Styling Package silver (tandem axle 2.8 t)	—	47.4	13259	—	—	—	—	—	—	—	—	—	—	—	○	○
Styling Package silver (tandem axle)	—	43.4	13257	—	—	—	—	—	—	—	—	—	—	—	○	○
Styling Package silver (tandem axle)	—	41.1	13257	—	—	—	—	—	—	—	—	—	—	—	○	—
Styling Package white (single axle)	—	45.7	13254	○	○	—	—	—	—	—	—	—	—	—	—	—
Styling Package white (single axle)	—	48.3	13254	—	—	○	○	○	○	○	○	—	—	—	—	—
Styling Package white (single axle)	—	51.1	13254	—	—	—	—	—	—	—	—	○	○	—	—	—
Styling Package white (tandem axle 2.8 t)	—	47.4	13258	—	—	—	—	—	—	—	—	—	—	—	○	○
Styling Package white (tandem axle)	—	43.4	13256	—	—	—	—	—	—	—	—	—	—	—	○	○
Styling Package white (tandem axle)	—	41.1	13256	—	—	—	—	—	—	—	—	—	—	—	○	—
Water & Electric Autonomy Package with Combi or hot water heating system	—	40.5	9943	—	—	○	○	—	—	○	—	—	—	—	—	—
Water and Electric Autonomy Package Combi 4	—	55.5	11031	○	○	—	—	○	○	—	—	—	—	—	—	—



The factory installation of optional equipment increases the actual mass of the vehicle and reduces the payload. The specified additional weight for packages and optional equipment shows the additional weight compared with the standard equipment of the respective model or layout. The total weight of the selected optional equipment must not exceed the mass for optional equipment specified by the manufacturer in the model overviews. This is an imputed

value determined for each model and layout that Dethleffs uses to determine the maximum weight available for factory-installed optional equipment. In the event of an increase of load capacity, the mass for optional equipment specified by the manufacturer is increased. For detailed information and explanations on the topic of weight, please refer to the "Legal notes" section.

Optional equipment**

	Included in package	Additional weight (kg)*	Code	460 EL	470 FR	490 BLF	490 EST	510 ER	510 LE	520 ELT	530 DR	560 FMK	560 RET	650 RQT	730 FKR	760 DR
Water and Electric Autonomy Package Combi 6	—	55.5	11032	—	—	—	—	—	—	—	○	○	○	○	○	○
Winter Comfort Package Combi 4	—	50.1	10479	—	—	—	—	○	○	—	—	—	—	—	—	—
Winter Comfort Package Combi 4	—	47.6	10479	○	○	—	—	—	—	—	—	—	—	—	—	—
Winter Comfort Package Combi 6	—	50.1	9536	—	—	—	—	—	—	—	○	—	—	○	—	—
Winter Comfort Package Combi 6	—	55	9536	—	—	—	—	—	—	—	—	—	—	—	○	○
Winter Comfort Package Combi 6	—	52.8	9536	—	—	—	—	—	—	—	—	○	○	—	—	—
Winter Comfort Package SNOW	—	76.8	5459	—	—	—	—	—	—	—	—	○	○	—	—	—
Winter Comfort Package SNOW	—	74.1	5459	—	—	—	—	—	—	○	○	—	—	○	—	—
Winter Comfort Package SNOW	—	79	5459	—	—	—	—	—	—	—	—	—	—	—	○	○
Winter Comfort Package SNOW PLUS	—	80	5551	—	—	—	—	—	—	—	—	—	—	—	○	○
Winter Comfort Package SNOW PLUS	—	77.8	5551	—	—	—	—	—	—	—	—	○	○	—	—	—
Winter Comfort Package SNOW PLUS	—	75.1	5551	—	—	—	—	—	—	○	○	—	—	○	—	—
Winter Comfort Package for Combi heating	—	35.1	10481	—	—	○	○	—	—	○	—	—	—	—	—	—
Miscellaneous																
Registration documents (CoC papers)	—	0	15151	◆	◆	◆	◆	◆	◆	◆	◆	◆	◆	◆	◆	◆

○ Optional equipment — Not possible ● Standard equipment ◆ Mandatory △ Not known at the time of publication

STP Styling Package SHP Safety Package WI-KO Winter Comfort Package WEA-P Water and Electric Autonomy Package M-P Mover Package DUP Shower Package



The factory installation of optional equipment increases the actual mass of the vehicle and reduces the payload. The specified additional weight for packages and optional equipment shows the additional weight compared with the standard equipment of the respective model or layout. The total weight of the selected optional equipment must not exceed the mass for optional equipment specified by the manufacturer in the model overviews. This is an imputed

value determined for each model and layout that Dethleffs uses to determine the maximum weight available for factory-installed optional equipment. In the event of an increase of load capacity, the mass for optional equipment specified by the manufacturer is increased. For detailed information and explanations on the topic of weight, please refer to the "Legal notes" section.

Beduin Scandinavia

Design, comfort and freedom

Loft-style room concepts with unusual layouts and natural materials create a Scandinavian flair with a touch of luxury. The Dethleffs flagship now makes caravanning possible 365 days a year. The powerful hot water heating and the electric floor heating on board guarantee cosy warmth even at sub-zero temperatures.

Upholstery



+ Upholstery
Amposta



+ Upholstery
Badalona ○



+ Upholstery
Tarragona ○

Wood décor



+ Wood décor Amberes Oak

○ optionally available

Technical info

Overall length, approx.	768 - 942 cm
Overall width, approx.	230 - 250 cm
Overall height, approx.	265 cm
Headroom in living area, approx.	198 cm

Maximum values partly not possible for all models or only in connection with certain options.

Plus factors

- + Upscale standard equipment: with hot-water heating as standard, electr. floor heating, side panels in smooth white sheet metal and a wide range of other options
- + Gourmet holidays made easy: high-quality kitchen equipment with oven/cooker combination and a lot of space for food prep
- + Inviting ambience: indirect lighting and illuminated kitchen back panel ensure special atmosphere
- + Unsurpassed comfort: high-quality padding and cleverly sewn fabrics encourage you to stick around
- + Step in: comfortable entry thanks to extra-wide entrance door with window
- + Watch out winter campers: be prepared for colder temperatures with the optional Winter Comfort Package Premium



Beduin Scandinavia

Technical info

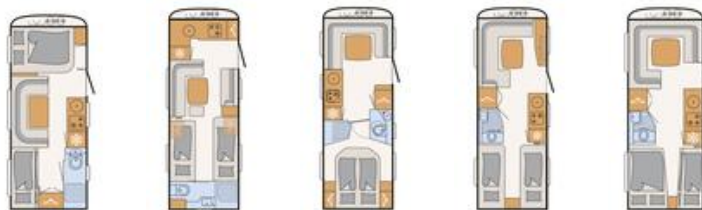

Beduin Scandinavia		540 QMK	550 BET	550 RD	550 SE	590 RK
Standard chassis		Lightweight chassis, 1800 kg	Lightweight chassis, 1800 kg	Lightweight chassis, 1800 kg	Lightweight chassis, 1800 kg	Lightweight chassis, 1900 kg
Overall length, approx.	cm	768	812	806	806	818
Body length approx.	cm	650	675	675	675	675
Overall width, approx.	cm	250	230	230	230	250
Overall height, approx.	cm	265	265	265	265	265
Circumferential dimension awning approx.	cm	1048	1078	1078	1078	1078
Headroom in living area, approx.	cm	198	198	198	198	198
Thickness floor / side walls / roof	mm	42 / 34 / 34	42 / 34 / 34	42 / 34 / 34	42 / 34 / 34	42 / 34 / 34
Tire size		195 R14C LI106	195 R14C LI106	195 R14C LI106	195 R14C LI106	225/70 R15C LI112
Bed dimension: Front bed, L x W, approx.	cm	195 x 135		220 x 110		180 - 130 x 230
Bed dimension: Central / middle bed, L X W, approx.	cm	230 x 115	180 x 110		220 x 110	
Bed dimension: Rear bed, L x W, approx.	cm	190 x 75 / 190 x 70	205 x 80 / 190 x 80 / 205 - 190 x 215 ○	195 x 150	2x 200 x 85 / 200 x 210	200 x 130 - 105 / 2x 190 x 70 - 50
Sleeping berths standard / max.		5	3	3	3	6
Mass in running order (+/-5%)*	kg	1615 (1534 to 1696)*	1645 (1563 to 1727)*	1600 (1520 to 1680)*	1545 (1468 to 1622)*	1685 (1601 to 1769)*
Manufacturer-specified mass for optional equipment*	kg	70	58	103	158	88
Technically permissible maximum laden mass*	kg	1800	1800	1800	1800	1900
Heating		Hot water heating, 6.4 kW Gas-Electric	Hot water heating, 6.4 kW Gas-Electric	Hot water heating, 6.4 kW Gas-Electric	Hot water heating, 6.4 kW Gas-Electric	Hot water heating, 6.4 kW Gas-Electric
Refrigerator volume (thereof freezer), approx.	l	137 (15)	137 (15)	137 (15)	137 (15)	137 (15)
Waste water tank, approx.	l	22	22	22	22	22
Fresh water tank capacity, total/ Fresh water tank capacity at driving filling	l	53 / 15	53 / 15	53 / 15	53 / 15	53 / 15
Sockets: 12 V / 230 V / USB		0 / 7 / 3	0 / 7 / 1	0 / 8 / 1	0 / 7 / 1	0 / 6 / 3



* INFO

The specified mass in running order is a standard value defined in the type approval procedure. Due to manufacturing tolerances, the actual weighed mass in running order may deviate from the value stated above. Deviations of up to ± 5% of the mass in running order are legally permissible and possible. The permissible range in kilograms is stated in parentheses after the mass in running order. The mass for optional equipment specified by the manufacturer is an imputed value determined for each type and layout by which Dethleffs specifies the maximum weight available for factory-fitted optional equipment. The purpose of limiting optional equipment is to ensure that the minimum payload, i.e. the legally required free mass for baggage and retrofitted accessories, is actually available for the load capacity of vehicles delivered by

Dethleffs. The actual weight of your vehicle after leaving the factory can only be determined when it is weighed at the end of the line. If, in exceptional cases, the weighing shows that the actual load capacity falls short of the minimum payload due to a permissible weight deviation, despite the limitation of the optional equipment, we will check together with your trading partner and you before delivery of the vehicle whether we should, for example, increase the load capacity of the vehicle or remove optional equipment. The technically permissible maximum laden mass of the vehicle must not be exceeded. For detailed information and explanations on the topic of weight and the configuration of the vehicle, please refer to the "Legal notes" section.

Beduin Scandinavia

Technical info

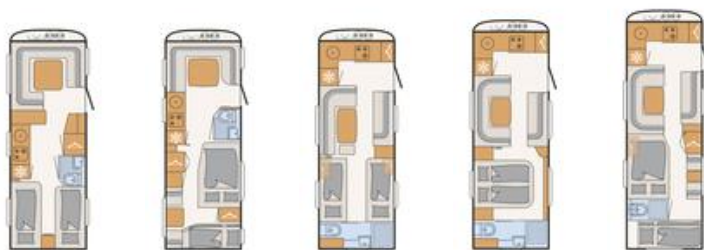

Beduin Scandinavia		650 RE	650 RFK	670 BET	690 BQT	740 BFK
Standard chassis		Lightweight chassis, 2200 kg	Lightweight chassis, 2200 kg	Lightweight chassis, 2200 kg	Lightweight chassis, 2200 kg	Lightweight chassis, 2500 kg
Overall length, approx.	cm	872	872	872	901	942
Body length approx.	cm	735	735	735	765	805
Overall width, approx.	cm	250	250	250	250	250
Overall height, approx.	cm	265	265	265	265	265
Circumferential dimension awning approx.	cm	1133	1133	1138	1163	1208
Headroom in living area, approx.	cm	198	198	198	198	198
Thickness floor / side walls / roof	mm	42 / 34 / 34	42 / 34 / 34	42 / 34 / 34	42 / 34 / 34	42 / 34 / 34
Tire size		195/70 R14C LI104	195/70 R14C LI104	195/70 R14C LI104	195/70 R14C LI104	195/70 R14C LI104
Bed dimension: Front bed, L x W, approx.	cm	210 - 135 x 230	230 x 135			220 x 115
Bed dimension: Central / middle bed, L X W, approx.	cm		200 x 140	220 x 110	230 x 115	200 x 140 - 120
Bed dimension: Rear bed, L x W, approx.	cm	215 x 95 / 195 x 95 / 195 x 230	2x 180 x 90 / 2x 180 x 90 ○ / 180 x 85 ○	2x 200 x 85 / 200 x 230 ○	185 - 200 x 155	195 x 85 / 180 x 90 / 195 x 85 ○ / 195 x 90 ○ / 180 x 80 ○
Sleeping berths standard / max.		4	6 / 7 ○	3	3	5 / 6 ○
Mass in running order (+/-5%)*	kg	1850 (1758 to 1943)*	1895 (1800 to 1990)*	1845 (1753 to 1937)*	1870 (1777 to 1964)*	2025 (1924 to 2126)*
Manufacturer-specified mass for optional equipment*	kg	237	172	252	224	345
Technically permissible maximum laden mass*	kg	2200	2200	2200	2200	2500
Heating		Hot water heating, 6.4 kW Gas-Electric	Hot water heating, 6.4 kW Gas-Electric	Hot water heating, 6.4 kW Gas-Electric	Hot water heating, 6.4 kW Gas-Electric	Hot water heating, 6.4 kW Gas-Electric
Refrigerator volume (thereof freezer), approx.	l	137 (15)	137 (15)	156 (29)	156 (29)	156 (29)
Waste water tank, approx.	l	22	22	22	22	22
Fresh water tank capacity, total/ Fresh water tank capacity at driving filling	l	53 / 15	53 / 15	53 / 15	53 / 15	53 / 15



* INFO

The specified mass in running order is a standard value defined in the type approval procedure. Due to manufacturing tolerances, the actual weighed mass in running order may deviate from the value stated above. Deviations of up to ± 5% of the mass in running order are legally permissible and possible. The permissible range in kilograms is stated in parentheses after the mass in running order. The mass for optional equipment specified by the manufacturer is an imputed value determined for each type and layout by which Dethleffs specifies the maximum weight available for factory-fitted optional equipment. The purpose of limiting optional equipment is to ensure that the minimum payload, i.e. the legally required free mass for baggage and retrofitted accessories, is actually available for the load capacity of vehicles delivered by

Dethleffs. The actual weight of your vehicle after leaving the factory can only be determined when it is weighed at the end of the line. If, in exceptional cases, the weighing shows that the actual load capacity falls short of the minimum payload due to a permissible weight deviation, despite the limitation of the optional equipment, we will check together with your trading partner and you before delivery of the vehicle whether we should, for example, increase the load capacity of the vehicle or remove optional equipment. The technically permissible maximum laden mass of the vehicle must not be exceeded. For detailed information and explanations on the topic of weight and the configuration of the vehicle, please refer to the "Legal notes" section.

Beduin Scandinavia

Technical info

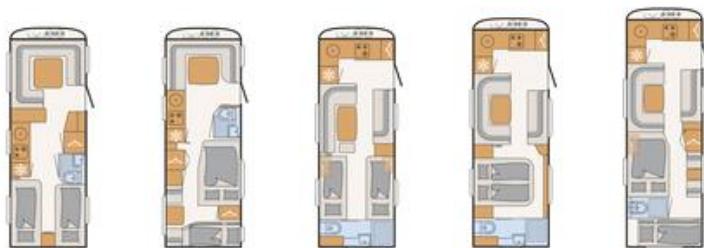

Beduin Scandinavia	650 RE	650 RFK	670 BET	690 BQT	740 BFK
Sockets: 12 V / 230 V / USB	0 / 6 / 1	0 / 7 / 3	0 / 9 / 1	0 / 8 / 1	0 / 7 / 3

○ Optional equipment — Not possible ● Standard equipment ◆ Mandatory ▲ Not known at the time of publication



The specified mass in running order is a standard value defined in the type approval procedure. Due to manufacturing tolerances, the actual weighed mass in running order may deviate from the value stated above. Deviations of up to $\pm 5\%$ of the mass in running order are legally permissible and possible. The permissible range in kilograms is stated in parentheses after the mass in running order. The mass for optional equipment specified by the manufacturer is an imputed value determined for each type and layout by which Dethleffs specifies the maximum weight available for factory-fitted optional equipment. The purpose of limiting optional equipment is to ensure that the minimum payload, i.e. the legally required free mass for baggage and retrofitted accessories, is actually available for the load capacity of vehicles delivered by

Dethleffs. The actual weight of your vehicle after leaving the factory can only be determined when it is weighed at the end of the line. If, in exceptional cases, the weighing shows that the actual load capacity falls short of the minimum payload due to a permissible weight deviation, despite the limitation of the optional equipment, we will check together with your trading partner and you before delivery of the vehicle whether we should, for example, increase the load capacity of the vehicle or remove optional equipment. The technically permissible maximum laden mass of the vehicle must not be exceeded. For detailed information and explanations on the topic of weight and the configuration of the vehicle, please refer to the "Legal notes" section.

Standard equipment

	540 QMK	550 BET	550 RD	550 SE	590 RK	650 RE	650 RFK	670 BET	690 BQT	740 BFK
Chassis										
Single axle premium wheel 195 R14 C LI106 (with steel wheel 1.700 kg and 1.800 kg)	●	●	●	●	—	—	—	—	—	—
Tandem axle premium wheel 195/70 R14 C LI104 (with steel wheel 2.200 kg to 2.800 kg)	—	—	—	—	—	●	●	●	●	●
Tyres on alloy wheels 225/70 R15 C LI112, 1.900 kg and 2.000 kg	—	—	—	—	●	—	—	—	—	—
Zinc-plated chassis with inertia braking system with reversing automatic	●	●	●	●	●	●	●	●	●	●
Chassis features										
AAA self-adjusting brake	●	●	●	●	●	●	●	●	●	●
ACS stabiliser	●	●	●	●	●	●	●	●	●	●
Draw bar cover	●	●	●	●	●	●	●	●	●	●
High-quality brand-name tyres, designed for a speed of 100 km/h	●	●	●	●	●	●	●	●	●	●
Lightweight corner steadies	●	●	●	●	●	●	●	●	●	●
Octagon shock absorber	●	●	●	●	●	●	●	●	●	●
Wheel trims for 14" tyres	●	●	●	●	—	●	●	●	●	●
Exterior features										
Floor of the gas bottle locker made of rot-resistant and robust corrugated aluminium	●	●	●	●	●	●	●	●	●	●
Flyscreen door	●	●	●	●	●	●	●	●	●	●
Front parts in gas locker area made of LFI (long fiber injection) technology, shock resistant, robust and repair-friendly	●	●	●	●	●	●	●	●	●	●
Fully-insulated wheel houses	●	●	●	●	●	●	●	●	●	●
Midi Heki clear-view skylight with blackout blind, flyscreen and integrated lights, operation with crank handle	●	●	●	●	●	●	●	●	●	●
Opening window in bathroom	—	—	—	—	●	—	—	—	—	—
Opening windows, trapezoid, insulated and double-glazed (graphite grey) with blackout and mosquito blinds	●	●	●	●	●	●	●	●	●	●
Panoramic front window	—	●	—	—	—	—	—	●	●	●
Robust GRP roof	●	●	●	●	●	●	●	●	●	●
Sidewall skirts with integrated side-marker lamps	●	●	●	●	●	●	●	●	●	●
Skylight Mini Heki	●	●	●	●	●	●	●	●	●	●
Space-saving gas locker door which opens upwards	●	●	●	●	●	●	●	●	●	●
Spare wheel carrier in gas locker	●	●	●	●	●	●	●	●	●	●
Storage space for 2 gas bottles with 11 kg filling weight each	●	●	●	●	●	●	●	●	●	●
Wide, one-piece habitation door with window	●	●	●	●	●	●	●	●	●	●
Exterior design										
Front and rear in smooth sides white	●	●	●	●	●	●	●	●	●	●
Manoeuvring handles in chrome design	●	●	●	●	●	●	●	●	●	●
Smooth sides white	●	●	●	●	●	●	●	●	●	●
Access locker doors										
Access locker door front left 997x419 mm	●	—	—	—	—	—	—	—	—	—
Access locker door rear left side 1069x299 mm	—	—	—	—	—	—	—	—	—	●
Access locker door rear left side 640 x 1000 mm	—	—	—	—	—	—	—	—	—	●
Access locker door rear right side 648x348 mm	—	—	●	—	—	—	—	—	—	—
Access locker door rear right side 997x419 mm	—	●	—	●	—	●	●	●	—	—
Interior design										
Upholstery Amposta	●	●	●	●	●	●	●	●	●	●
Wood décor Amberes Oak	●	●	●	●	●	●	●	●	●	●
Textile equipment										
7-zones double bed mattress, made of heat-regulating material	●	—	●	—	●	—	●	—	●	●
7-zones mattress left side, made of heat-regulating material	—	●	—	●	—	●	—	●	—	—
7-zones mattress right side, made of heat-regulating material	—	●	—	●	—	●	—	●	—	—
Corner head rests for U-shaped seating lounge	●	●	●	●	●	●	●	●	●	●
High-quality upholstery and materials in the seating group	●	●	●	●	●	●	●	●	●	●
Furniture layouts										
AirPlus - perfect air circulation in the interior and rear ventilation of the overhead lockers and sideboards	●	●	●	●	●	●	●	●	●	●

Standard equipment

	540 QMK	550 BET	550 RD	550 SE	590 RK	650 RE	650 RFK	670 BET	690 BQT	740 BFK
Bunk bed with 2 sleeping berths, not foldable	●	—	—	—	●	—	●	—	—	●
Bunk beds with safety net and ladder	●	—	—	—	●	—	●	—	—	●
One-legged telescopic table, height adjustable	●	●	●	●	●	●	●	●	●	●
Seating lounge converts to bed	●	●	●	●	●	●	●	●	●	●
Special slatted frame with flexible natural rubber holders, opening for optimal use of storage compartments under the beds	●	●	●	●	●	●	●	●	●	●
Kitchen										
Generous drawers with soft closing for absolutely silent closing	●	●	●	●	●	●	●	●	●	●
High-quality three-cooker hob with electric ignition and built-in oven	●	●	●	●	●	●	●	●	●	●
Kitchen worktop with indirect lighting	●	●	●	●	●	●	●	●	●	●
Large fridge with 137 liters capacity and 15 liters freezer compartment	●	●	●	●	●	●	●	—	—	—
Large fridge with 156 liters capacity and 29 liters freezer compartment	—	—	—	—	—	—	—	●	●	●
Oven	●	●	●	●	●	●	●	●	●	●
Practical apothecary drawers (depending on layout)	●	●	●	●	●	●	●	●	●	●
Bathroom										
Integrated design washbasin made of solid surface material	—	●	●	●	●	●	●	●	●	●
Shower tray	●	●	●	●	●	●	●	●	●	●
Skylight with mosquito net	●	●	●	●	●	●	●	●	●	●
Space-saving fold-away washbasin for easy storage in the bathroom cabinet	●	—	—	—	—	—	—	—	—	—
Multimedia										
Preparation for flat screen TV (antenna cable and TV bracket)	●	●	●	●	●	●	●	●	●	●
Heating										
Electric floor heating	●	●	●	●	●	●	●	●	●	●
Hot water heating	●	●	●	●	●	●	●	●	●	●
Air Conditioning										
Pre-wiring for A/C	●	●	●	●	●	●	●	●	●	●
Electrical installation										
12 V power supply throughout vehicle	●	●	●	●	●	●	●	●	●	●
Awning light 12V	●	●	●	●	●	●	●	●	●	●
CEE external output socket for 230V on-board electrics	●	●	●	●	●	●	●	●	●	●
Compact power distribution unit with 230V safety device and 12V fuse box in wardrobe incl. powerful 340W transformer	●	●	●	●	●	●	●	●	●	●
Illuminated kitchen back panel	●	●	●	●	●	●	●	●	●	●
Indirect lighting	●	●	●	●	●	●	●	●	●	●
LED light bar system 12V (on head-side of bed and in seating lounge)	●	●	●	●	●	●	●	●	●	●
USB port for spotlight bar	●	●	●	●	●	●	●	●	●	●
Water supply										
Electric water supply	●	●	●	●	●	●	●	●	●	●
Fresh water tank 38 l	●	●	●	●	●	●	●	●	●	●
Mobile 22 l waste water tank	●	●	●	●	●	●	●	●	●	●

Packages Beduin Scandinavia

Package	Mover Autonomy Package (single axle) (5560)	Mover Autonomy Package (tandem axle) (5561)
Mover manoeuvring support for single-axle	x	
Electric Autonomy equipment	x	x
Mover manoeuvring support for tandem-axle		x
Additional weight (kg)*	70	98

Package	Water & Electric Autonomy Package with Combi or hot water heating system (9943)
Electric Autonomy equipment	x
Fresh water tank 70 l	x
Additional weight (kg)*	40.5

Package	Winter Comfort Package Premium (11332)	Winter Comfort Package Premium (11332)	Winter Comfort Package Premium (11332)
Hot water floor heating (only in comb. with option 205)	x	x	x
Heated and insulated 42-litre waste water tank	x	x	x
Waste water pipes insulated and heated	x	x	x
Electric Autonomy equipment	x	x	x
Flush-fitting windows (not possible for front and rear windows)	x	x	x
XPS insulation for front, rear and sides (depending on vehicle size)	x		
XPS insulation for front, rear and sides (depending on vehicle size)		x	
XPS insulation for front, rear and sides (depending on vehicle size)			x
Additional weight (kg)*	82.1	84.8	87

Safety Package (8950)	
ATC Trailer Control	
DuoControl safety gas pressure regulator with crash sensor and EisEx gas regulator heater	
Smoke detector	
Additional weight (kg)*	7

Shower Package (6105)	
Shower equipment with shower fittings and curtain	
City water connection	
Additional weight (kg)*	7

△ Not known at the time of publication



The factory installation of optional equipment increases the actual mass of the vehicle and reduces the payload. The specified additional weight for packages and optional equipment shows the additional weight compared with the standard equipment of the respective model or layout. The total weight of the selected optional equipment must not exceed the mass for optional equipment specified by the manufacturer in the model overviews. This is an imputed

value determined for each model and layout that Dethleffs uses to determine the maximum weight available for factory-installed optional equipment. In the event of an increase of load capacity, the mass for optional equipment specified by the manufacturer is increased. For detailed information and explanations on the topic of weight, please refer to the "Legal notes" section.

Optional equipment*

	Included in package	Additional weight (kg)*	Code	540 QMK	550 BET	550 RD	550 SE	590 RK	650 RE	650 RFK	670 BET	690 BQT	740 BFK
Chassis													
17" alloy wheels in Dethleffs design (single axle)	—	10	11608	○	○	○	○	○	—	—	—	—	—
17" alloy wheels in Dethleffs design (tandem axle)	—	0	11609	—	—	—	—	—	○	○	○	○	○
Tyres on alloy wheels 195 R14 C LI106, 1700 kg and 1800 kg	—	2	838	○	○	○	○	—	—	—	—	—	—
Tyres on alloy wheels 195/70 R14 C LI104, 2200 kg to 2800 kg	—	4	859	—	—	—	—	—	○	○	○	○	○
Weight upgrade													
Weight upgrade 1.900 kg (incl. alloy wheel 225/70 R15 C LI112)	—	12.4	394	—	○	○	○	—	—	—	—	—	—
Weight upgrade 1.900 kg (incl. alloy wheel 225/70 R15 C LI112)	—	17.9	394	○	—	—	—	—	—	—	—	—	—
Weight upgrade 2.000 kg (incl. alloy wheel 225/70 R15 C LI112)	—	17.9	138	○	—	—	—	—	—	—	—	—	—
Weight upgrade 2.000 kg (incl. alloy wheel 225/70 R15 C LI112)	—	12.4	138	—	○	○	○	—	—	—	—	—	—
Weight upgrade 2.000 kg (incl. alloy wheel 225/70 R15 C LI112)	—	0	138	—	—	—	—	○	—	—	—	—	—
Weight upgrade 2.500 kg (incl. steel wheel 195/70 R14 C LI104)	—	0	496	—	—	—	—	—	○	○	○	○	—
Weight upgrade 2.800 kg (incl. steel wheel 195/70 R14 C LI104)	—	25	7713	—	—	—	—	—	—	—	—	—	○
Chassis features													
ATC Trailer Control	SHP	4	748	○	○	○	○	○	○	○	○	○	○
Breakdown kit	—	1	620	●	●	○	○	○	●	●	●	●	●
Large support feet, 4 pc.	—	1	6348	○	○	○	○	○	○	○	○	○	○
Solid rubber support wheel with support load indicator	—	2	10063	○	○	○	○	○	○	○	○	○	○
Spare tyre with alloy wheel 195 R14 C 8PR-LI 106, 1.700 kg and 1.800 kg	—	19	839	—	○	—	○	—	—	—	—	—	—
Spare tyre with alloy wheel 225/70 R15 C LI 112, 1.900 kg and 2.000 kg	—	23.5	1092	—	○	—	○	●	—	—	—	—	—
Spare tyre with steel wheel 195 R14 C LI 106, 1.700 kg and 1.800 kg	—	19.5	833	—	○	—	○	—	—	—	—	—	—
Exterior features													
Cassette awning 4500x2500 mm, manual	—	30	6928	○	○	○	○	○	—	—	—	—	—
Cassette awning 5500x3000 mm, manual	—	50.6	6928	—	—	—	—	—	○	○	○	○	—
Cassette awning 6000x3000 mm, manual	—	54.6	6928	—	—	—	—	—	—	—	—	—	○
Flush-fitting windows (not possible for front and rear windows) ⁸⁾	WI-KO	3	7561	○	○	○	○	○	○	○	○	○	○
Front window	—	4	982	○	●	●	●	●	●	●	●	●	●
Rear window	—	4	1108	—	—	○	○	○	○	—	—	—	—
XPS insulation for front, rear and sides (depending on vehicle size)	WI-KO	20.1	179	○	—	—	—	—	—	—	—	—	—
XPS insulation for front, rear and sides (depending on vehicle size)	WI-KO	22.8	179	—	○	○	○	○	○	○	○	—	—
XPS insulation for front, rear and sides (depending on vehicle size)	WI-KO	25	179	—	—	—	—	—	—	—	—	○	○
Exterior design													
Front moulding with high attachment and roof rails ¹¹⁾	—	1	627	○	○	○	○	○	○	○	○	○	○
Rear light carrier with high attachment and roof rails ¹²⁾	—	11	624	○	○	○	○	○	○	○	○	○	○
Smooth sides titanium silver metallic	—	0	659	○	○	○	○	○	○	○	○	○	○
Access locker doors													
Access locker door front left side 1069x299 mm	—	2	1083	—	—	—	—	—	○	○	—	—	—
Access locker door front right side 1069x299 mm	—	2	1084	—	—	○	—	—	—	—	—	—	—
Access locker door front right side 749x297 mm	—	2	1076	—	—	—	—	○	○	○	—	—	—
Access locker door rear left side 648x348 mm	—	2	1073	—	—	○	—	—	—	—	—	—	—
Access locker door rear left side 997x419 mm	—	2.2	1081	—	—	—	○	●	—	—	—	●	—
Interior design													
Upholstery Badalona	—	0	11330	○	○	○	○	○	○	○	○	○	○



The factory installation of optional equipment increases the actual mass of the vehicle and reduces the payload. The specified additional weight for packages and optional equipment shows the additional weight compared with the standard equipment of the respective model or layout. The total weight of the selected optional equipment must not exceed the mass for optional equipment specified by the manufacturer in the model overviews. This is an imputed

value determined for each model and layout that Dethleffs uses to determine the maximum weight available for factory-installed optional equipment. In the event of an increase of load capacity, the mass for optional equipment specified by the manufacturer is increased. For detailed information and explanations on the topic of weight, please refer to the "Legal notes" section.

Optional equipment**

	Included in package	Additional weight (kg)*	Code	540 QMK	550 BET	550 RD	550 SE	590 RK	650 RE	650 RFK	670 BET	690 BQT	740 BFK
Upholstery Tarragona	—	0	11331	○	○	○	○	○	○	○	○	○	○
Textile equipment													
7-zones double bed mattress, made of heat-regulating material with watergel cover	—	4	8214	○	—	○	—	○	—	○	—	○	○
7-zones mattress left side, made of heat-regulating material with watergel cover	—	2	8215	—	○	—	○	—	○	—	○	—	—
7-zones mattress right side, made of heat-regulating material with watergel cover	—	5	8216	—	○	—	○	—	○	—	○	—	—
Loose carpet	—	8.5	513	○	○	○	○	○	○	○	○	○	○
Furniture layouts													
Bunk bed with 3 sleeping berths, not foldable	—	20	200	—	—	—	—	—	—	○	—	—	○
Sideboard instead of couch (opposite the central seating group)	—	0	131	—	○	—	●	—	—	—	○	○	○
Single beds convert to double bed	—	5	685	—	○	—	●	—	●	—	○	—	—
Slatted bed frame with adjustable head section	—	1	871	—	○	—	○	—	○	—	○	—	—
Interior features													
2 kg fire extinguisher	—	3.5	843	○	○	○	○	○	○	○	○	○	○
Smoke detector	SHP	0.5	8949	○	○	○	○	○	○	○	○	○	○
Kitchen													
Extractor fan	—	3	785	○	—	○	○	○	○	○	—	—	—
Kitchen worktop extension, foldable	—	1	1107	—	—	○	—	—	—	○	—	—	—
Multimedia													
FS-SAT system Voyager 65 Digimatic	—	10	1049	—	—	○	○	○	○	○	—	○	○
Flat screen TV 22" incl. DVD player and receiver	—	3.5	1103	○	○	○	○	○	○	○	○	○	○
Flat screen TV 32" ¹³⁾	—	5.6	817	—	○	—	—	—	—	—	○	○	○
Flat screen TV 32" ¹⁵⁾	—	5.6	817	—	—	—	○	—	—	—	—	—	—
Multifunctional external connection, 12 V, 220 V, TV and SAT	—	1	611	○	○	○	○	○	○	○	○	○	○
SAT parabol antenna flat 65 Easy 65 Twin	—	14	879	—	—	○	○	○	○	○	—	○	○
TV lift ¹⁴⁾	—	5.4	7006	—	○	—	○	—	—	—	○	○	○
Heating													
Hot water floor heating (only in comb. with option 205) ⁹⁾	WI-KO	10	674	○	○	○	○	○	○	○	○	○	○
Air Conditioning													
Roof A/C	—	35	8145	○	○	○	○	○	○	○	○	○	○
Electrical installation													
Electric Autonomy equipment	WEA-P, M-P, WI-KO	38	492	○	○	○	○	○	○	○	○	○	○
Water supply													
City water connection	DUP	2	414	○	○	○	○	○	○	○	○	○	○
Exterior shower	—	2	396	○	○	○	○	○	○	○	○	○	○
Fresh water tank 70 l	WEA-P	2.5	592	○	○	○	○	○	○	○	○	○	○
Heated and insulated 42-litre waste water tank ¹⁶⁾	WI-KO	6	10067	○	○	○	○	○	○	○	○	○	○
Shower equipment with shower fittings and curtain	DUP	5	1097	○	○	○	○	○	○	○	○	○	○
Waste water pipes insulated and heated	WI-KO	5	520	○	○	○	○	○	○	○	○	○	○
Gas supply													



The factory installation of optional equipment increases the actual mass of the vehicle and reduces the payload. The specified additional weight for packages and optional equipment shows the additional weight compared with the standard equipment of the respective model or layout. The total weight of the selected optional equipment must not exceed the mass for optional equipment specified by the manufacturer in the model overviews. This is an imputed

value determined for each model and layout that Dethleffs uses to determine the maximum weight available for factory-installed optional equipment. In the event of an increase of load capacity, the mass for optional equipment specified by the manufacturer is increased. For detailed information and explanations on the topic of weight, please refer to the "Legal notes" section.

Optional equipment**

	Included in package	Additional weight (kg)*	Code	540 QMK	550 BET	550 RD	550 SE	590 RK	650 RE	650 RFK	670 BET	690 BQT	740 BFK
DuoControl safety gas pressure regulator with crash sensor and EisEx gas regulator heater	SHP	2.5	784	○	○	○	○	○	○	○	○	○	○
Gas socket (exterior)	—	1	187	○	○	○	○	○	○	○	○	○	○
Packages													
Mover Autonomy Package (single axle)	—	70	5560	○	○	○	○	○	—	—	—	—	—
Mover Autonomy Package (tandem axle)	—	98	5561	—	—	—	—	—	○	○	○	○	○
Safety Package	—	7	8950	○	○	○	○	○	○	○	○	○	○
Shower Package	—	7	6105	○	○	○	○	○	○	○	○	○	○
Water & Electric Autonomy Package with Combi or hot water heating system	—	40.5	9943	○	○	○	○	○	○	○	○	○	○
Winter Comfort Package Premium	—	82.1	11332	○	—	—	—	—	—	—	—	—	—
Winter Comfort Package Premium	—	84.8	11332	—	○	○	○	○	○	○	○	—	—
Winter Comfort Package Premium	—	87	11332	—	—	—	—	—	—	—	—	○	○
Miscellaneous													
Registration documents (CoC papers)	—	0	15151	◆	◆	◆	◆	◆	◆	◆	◆	◆	◆

○ Optional equipment — Not possible ● Standard equipment ◆ Mandatory △ Not known at the time of publication

SHP Safety Package WI-KO Winter Comfort Package WEA-P Water and Electric Autonomy Package M-P Mover Package DUP Shower Package



The factory installation of optional equipment increases the actual mass of the vehicle and reduces the payload. The specified additional weight for packages and optional equipment shows the additional weight compared with the standard equipment of the respective model or layout. The total weight of the selected optional equipment must not exceed the mass for optional equipment specified by the manufacturer in the model overviews. This is an imputed

value determined for each model and layout that Dethleffs uses to determine the maximum weight available for factory-installed optional equipment. In the event of an increase of load capacity, the mass for optional equipment specified by the manufacturer is increased. For detailed information and explanations on the topic of weight, please refer to the "Legal notes" section.

LEGAL NOTES ON WEIGHT-RELATED INFORMATION

The weight specifications and tests for caravans are regulated uniformly throughout the EU in EU Implementing Regulation No. 2021/535 (until June 2022: EU Regulation No. 1230/2012). We have summarized and explained the essential terminology and legal requirements from this regulation for you below. Our dealers and the Dethleffs configurator on our website are there to give you additional assistance in configuring your vehicle.

1. Technically permissible maximum laden mass

The **technically permissible maximum laden mass** of the vehicle (e.g. 2,000 kg) is a mass specification defined by the manufacturer that the vehicle must not exceed. You can find information on the technically permissible maximum laden mass of the model you have selected in the technical data. Driving the vehicle even if it exceeds the technically permissible maximum laden mass constitutes an administrative offense that may result in a fine.

2. Mass in running order

In simple terms, the mass in running order is the basic vehicle with standard equipment. This essentially includes the following items:

- the unladen weight of the vehicle together with the bodywork, including operating fluids;
- the standard equipment, i.e. all equipment and standard fittings included when the vehicle leaves the factory;
- the 100% filled water tank or driving tank according to the manufacturer's specifications and a 100% filled aluminum gas cylinder.

You can find information on the mass in running order for each model in our sales documents. It is **important to note** that the value specified in the sales documents for the mass in running order is a **standard value** determined in the type approval process and verified by the authorities. It is legally permissible and possible for the mass in running order of the vehicle delivered to you to deviate from the nominal value specified in the sales documents. The **legally permissible tolerance** is $\pm 5\%$. This allows EU legislation to account for the occurrence of certain fluctuations in the mass in running order due to weight fluctuations in components supplied by third-party suppliers as well as process and weather-related factors.

These weight deviations can be illustrated using the following example calculation:

- Mass in running order according to sales documents: 1,600 kg
- Legally permissible tolerance of $\pm 5\%$: 80 kg
- Legally permissible range of mass in running order: 1,520 kg to 1,680 kg

The specific range of permissible weight deviations can be found in the technical data for each model.

Dethleffs makes great efforts to reduce weight variations to the minimum level that is unavoidable for production reasons. Deviations at the upper and lower ends of the range are therefore very rare; however, they cannot be completely ruled out technically, even after carrying out all possible optimization measures. For this reason, Dethleffs checks the actual weight of the vehicle and compliance with the permissible tolerance by weighing each vehicle at the end of the line.

3. Optional equipment and actual mass

According to the legal definition, optional equipment (also including special or additional equipment) includes all optional equipment parts not included with the standard equipment that are fitted to the vehicle under the responsibility of the manufacturer – i.e. at the factory – and can be ordered by the customer (e.g. awning, smooth panel, Alde heating system, oven, etc.). For information on the individual or package weights of the optional equipment that can be ordered, please refer to our sales documents. In this meaning, optional equipment does not include other accessories that are retrofitted by you or your dealer personally after the vehicle has been delivered from the factory.

The mass of the vehicle in running order (see no. 2 above) and the mass of the optional equipment installed on a specific vehicle at the factory are together referred to as the actual mass. You will find the corresponding information for your vehicle after handover under item 13.2 of the Certificate of Conformity (CoC). Please note that this information also represents a standardized value. Since the mass in running order – as an element of the actual mass – is subject to a legally permissible tolerance of $\pm 5\%$ (see no. 2), the actual mass may also deviate accordingly from the specified nominal value.

4. Payload and minimum payload

The installation of **optional equipment** is also subject to technical and legal limits: It is only permissible to order an amount of optional equipment for installation at the factory that will leave sufficient free weight for baggage and other accessories (i.e. "payload") without exceeding the technically permissible maximum laden mass.

The payload is obtained by deducting the mass in running order (nominal value according to sales documents; see no. 2 above) and the mass of the optional equipment from the technically permissible maximum laden mass (see no. 1 above). The EU regulations stipulate a fixed minimum payload for caravans that must remain as a minimum for baggage or other accessories not installed at the factory. This minimum payload is calculated as follows:

Minimum payload in kg $\geq 10 \cdot (n + L)$

where "n" = maximum number of sleeping berths and

"L" = total length of the vehicle body (without drawbar).

The maximum number of sleeping berths corresponds to the actual configured sleeping berths of the individual vehicle. For a caravan with 6 designated sleeping berths and a total length of the vehicle body of 7 m, the minimum payload is calculated as follows: $10 \text{ kg} \cdot (6 + 7) = 130 \text{ kg}$.

To ensure that the minimum payload is maintained, there is a maximum combination of optional equipment that can be ordered for each vehicle model. In the above example with a minimum payload of 130 kg, the total mass of the optional equipment for a vehicle with 6 designated sleeping berths and a mass in running order of 1,750 kg should not exceed 120 kg:

- 2,000 kg technically permissible maximum laden mass**
- 1,750 kg mass in running order
- 130 kg minimum payload
- = **120 kg maximum permissible mass for optional equipment**

It is important to note that this calculation is based on the standard value for the mass in running order specified in the type approval procedure and does not account for permissible weight deviations for the mass in running order (see no. 2 above). If the maximum permissible value of 120 kg for the optional equipment is nearly or fully exhausted in this example and the standard value of the mass in running order is applied, it is possible for the minimum payload of 130 kg to be complied with mathematically in the event of an upward weight deviation even if the vehicle has no load capacity.

Here is another example calculation for a vehicle with 6 sleeping berths whose actual weighed mass in running order is 2% above the nominal value:

- 2,000 kg technically permissible maximum laden mass**
- 1,785 kg actual weighed mass in running order
(in the example: 2% higher than the specified value of 1,750 kg)
- 120 kg optional equipment (maximum permissible value)
- = **95 kg actual load capacity**
(< minimum pay-mass of 130 kg)

To avoid such a situation, Dethleffs further reduces the maximum permissible weight of the total optional equipment that can be ordered depending on the specific model. The limitation of optional equipment is intended to ensure that the minimum payload, i.e. the legally prescribed free mass for baggage and retrofitted accessories, is actually available for the load capacity of the vehicles delivered by Dethleffs.

Since the weight of a specific vehicle can only be determined when it is weighed at the end of the line, in very rare cases a situation may arise in which the minimum payload is not guaranteed at the end of the line despite this limitation of optional equipment. In order to guarantee the minimum payload even in these cases, Dethleffs will check together with your trading partner and you before delivery of the vehicle whether, for example, the load capacity of your vehicle is to be increased or optional equipment removed.

5. Effects of tolerances of the mass in running order on the remaining load capacity

Irrespective of the minimum payload, you should bear in mind that unavoidable production-related fluctuations in the mass in running order – both upwards and downwards – have a corresponding effect on the remaining load capacity: If, for example, you order our example vehicle with optional equipment with a total weight of 90 kg, the calculated payload based on the standard value for the mass in running order is 160 kg.

The load capacity actually available may deviate upwards or downwards from this value due to tolerances. If the mass of your vehicle in running order is approximately 2% higher than specified in the sales documents, the load capacity is reduced from 160 kg to 125 kg:

- 2,000 kg technically permissible maximum laden mass**
- 1,785 kg actual weighed mass in running order
(in the example: 2% higher than the specified value of 1,750 kg)
- 90 kg ordered optional equipment of the specific vehicle
- = **125 kg actual load capacity**

In order to ensure that the calculated payload is actually adhered to, you should therefore take the possible and permissible tolerances for the mass in running order into account as a precaution when configuring your vehicle.

We also recommend weighing the loaded caravan on a scale before each journey to check whether the technically permissible total weight is adhered to. In addition, we recommend checking the actual drawbar load of the loaded vehicle. This must not be higher than the max. drawbar load of the towing vehicle. Furthermore, the technically permissible maximum laden mass of the vehicle combination must be observed when loaded, i.e. the maximum mass of the combination of your motor vehicle and your caravan.

TECHNICAL INFORMATION / FOOTNOTES

If you order your vehicle with additional equipment, you should check whether it makes sense or is necessary to increase the vehicle's weight! The optional equipment partially replaces the standard equipment.

FOOTNOTES

- 1) With the Dynamic Package, the vehicle must be approved for speeds of 100 km/h.
- 2) Only in combination with package #9243 "Touring Package c'joy".
- 3) Only in combination with option #8699 "Hanging table with rotating device"
- 4) Only in combination with option #187 "Gas exterior socket"
- 5) Only in combination with option #611 "Multifunction exterior socket 12V, 220V, TV and SAT"
- 6) Only in combination with package #7345 "Touring Package c'go".
- 7) Not in combination with option #200 "Bunk beds with 3 sleeping berths".
- 8) Not available for front or rear windows. These windows are standard design.
- 9) Only in combination with option #205 "Hot water heating".
- 10) In combination with option #9933 "Lateral front overhead locker"
- 11) Only in combination with option #624 "Rear light carrier with high attachment and roof rails".
- 12) Only in combination with option #627 "Front with high attachment and roof rails".
- 13) Price incl. options #131 and #7006.
- 14) Only in combination with option #131 "Sideboard instead of sofa (opposite to central seating group)".
- 15) Price incl. option #7006
- 16) Only in combination with option #520 "Waste water hoses insulated and heated".

General Information

The information on the scope of delivery, appearance, performance, dimensions and weights of the vehicles correspond to the knowledge available at the time of going to press and to the European homologation regulations.

Technical changes in design and equipment as well as errors excepted. This Technical Information model year 2024 is valid as of September 15th, 2023.

Vehicle illustrations in this document may contain optional extras subject to surcharge. We expressly reserve the right to make changes. With the publication of this document, all previous Technical Information become invalid.

Different Euro prices may apply throughout Europe. This is due to different country-specific standard equipment and different VAT or luxury tax rates.