

# c'go & c'go up

## Caravans to go

The c'go makes you want to pack your bags and go on tour right away. Be inspired by the new and modern interior and feel at home, no matter where your journey takes you. In addition, the c'go has a wide choice of layouts: from the small compact to the spacious family caravan. Only the c'go up promises more freedom with its clever pull-down bed above the seating group, making it the ideal travel companion and particularly popular with young couples and small families. When do we leave?

## Upholstery

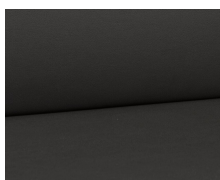

+ Upholstery Ronda

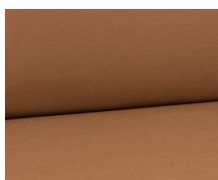

+ Upholstery Estepona

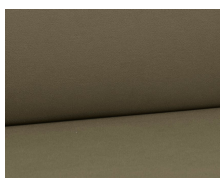

+ Upholstery Manilva

## Wood décor

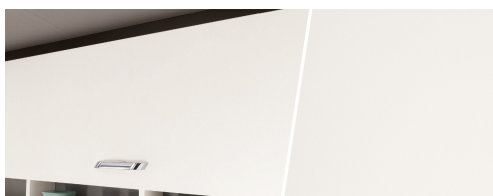

+ WEB Alaska White

optionally available

## Technical info

Overall length, approx.	631 - 803 cm
Overall width, approx.	220 - 250 cm
Overall height, approx.	261 - 271 cm
Headroom in living area, approx.	198 - 208 cm

Maximum values partly not possible for all models or only in connection with certain options.

## Plus factors

- + Lightweight: So light, in many cases you can even tow it with a class B driving licence (depending on the towing vehicle)
- + Something for everyone: thanks to the large selection of layouts
- + Protects you from bad weather: roof, front and rear made of robust GRP
- + Fresh look: chic, modern interior design and a stylish selection of upholstery to suit individual tastes
- + c'go up with standard fold-down bed (200 x 140 cm lying surface) above the seating group



# c'go & c'go up

## Technical info



c'go & c'go up		415 QL	475 EL	475 FR	495 FR
Standard chassis		Lightweight chassis, 1200 kg	Lightweight chassis, 1300 kg	Lightweight chassis, 1300 kg	Lightweight chassis, 1360 kg
Overall length, approx.	cm	631	676	680	725
Body length approx.	cm	498	552	558	588
Overall width, approx.	cm	220	230	230	230
Overall height, approx.	cm	261	261	261	261
Circumferential dimension awning approx.	cm	902	955	962	992
Headroom in living area, approx.	cm	198	198	198	198
Thickness floor / side walls / roof	mm	38 / 28 / 28	38 / 28 / 28	38 / 28 / 28	38 / 28 / 28
Tire size		185 R14C 8PR	185 R14C 8PR	185 R14C 8PR	185 R14C 8PR
Bed dimension: Front bed, L x W, approx.	cm	200 x 135	210 x 85 / 185 x 85 / 200 x 190 ○	205 x 144 - 110	200 x 145 - 110
Bed dimension: Central / middle bed, L X W, approx.	cm				
Bed dimension: Rear bed, L x W, approx.	cm	200 x 130 - 100	210 x 105	212 x 132 - 149	210 x 150 - 130
Sleeping berths standard / max.		3	3	4	4
Mass in running order (+/-5%)*	kg	1005 (955 to 1055)*	1125 (1069 to 1181)*	1135 (1078 to 1192)*	1160 (1102 to 1218)*
Manufacturer-specified mass for optional equipment*	kg	115	90	69	101
Technically permissible maximum laden mass*	kg	1200	1300	1300	1360
Heating		S 3004, 3.5 kW Gas	S 3004, 3.5 kW Gas	S 3004, 3.5 kW Gas	S 3004, 3.5 kW Gas
Refrigerator volume (thereof freezer), approx.	l	78 (11)	78 (11)	137 (15)	137 (15)
Waste water tank, approx.	l	23	23	23	23
Fresh water tank capacity, total/ Fresh water tank capacity at driving filling	l	44 / 15	44 / 15	44 / 15	44 / 15
Sockets: 12 V / 230 V / USB		0 / 5 / 0	0 / 5 / 0	0 / 5 / 0	0 / 5 / 0



\* INFO

The specified mass in running order is a standard value defined in the type approval procedure. Due to manufacturing tolerances, the actual weighed mass in running order may deviate from the value stated above. Deviations of up to  $\pm 5\%$  of the mass in running order are legally permissible and possible. The permissible range in kilograms is stated in parentheses after the mass in running order. The mass for optional equipment specified by the manufacturer is an imputed value determined for each type and layout by which Dethleffs specifies the maximum weight available for factory-fitted optional equipment. The purpose of limiting optional equipment is to ensure that the minimum payload, i.e. the legally required free mass for baggage and retrofitted accessories, is actually available for the load capacity of vehicles delivered by

Dethleffs. The actual weight of your vehicle after leaving the factory can only be determined when it is weighed at the end of the line. If, in exceptional cases, the weighing shows that the actual load capacity falls short of the minimum payload due to a permissible weight deviation, despite the limitation of the optional equipment, we will check together with your trading partner and you before delivery of the vehicle whether we should, for example, increase the load capacity of the vehicle or remove optional equipment. The technically permissible maximum laden mass of the vehicle must not be exceeded. For detailed information and explanations on the topic of weight and the configuration of the vehicle, please refer to the "Legal notes" section.

# ć'go & ć'go up

## Technical info

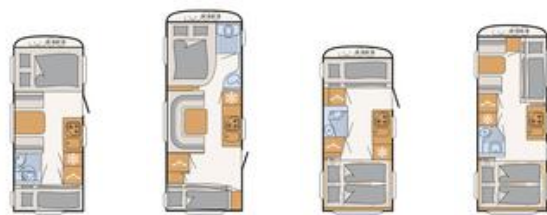

ć'go & ć'go up		495 QSK	565 FMK	up 465 KR	up 525 KR
Standard chassis		Lightweight chassis, 1360 kg	Lightweight chassis, 1600 kg	Lightweight chassis, 1500 kg	Lightweight chassis, 1600 kg
Overall length, approx.	cm	714	803	682	756
Body length approx.	cm	587	672	551	623
Overall width, approx.	cm	230	250	230	230
Overall height, approx.	cm	261	261	271	271
Circumferential dimension awning approx.	cm	990	1086	968	1040
Headroom in living area, approx.	cm	198	198	208	208
Thickness floor / side walls / roof	mm	38 / 28 / 28	38 / 28 / 28	38 / 28 / 28	38 / 28 / 28
Tire size		185 R14C 8PR	185 R14C 8PR	185 R14C 8PR	185 R14C 8PR
Bed dimension: Front bed, L x W, approx.	cm	210 x 135	205 x 165 - 130	2x 210 x 95	205 x 75 / 200 x 75 / 175 x 90 - 80
Bed dimension: Central / middle bed, L X W, approx.	cm	190 x 90	200 x 110		
Bed dimension: Rear bed, L x W, approx.	cm	2x 210 x 75 / 3x 210 x 75 ○	2x 200 x 80 / 2x 200 x 80 ○ / 200 x 70 ○	200 x 145 / 210 x 170 - 160	200 x 145 / 212 x 170 - 160
Sleeping berths standard / max.		5 / 6 ○	5 / 6 ○	6	7
Mass in running order (+/-5%)*	kg	1165 (1107 to 1223)*	1370 (1302 to 1439)*	1230 (1169 to 1292)*	1340 (1273 to 1407)*
Manufacturer-specified mass for optional equipment*	kg	86	113	155	128
Technically permissible maximum laden mass*	kg	1360	1600	1500	1600
Heating		S 3004, 3.5 kW Gas	S 5004, 6 kW Gas	S 3004, 3.5 kW Gas	S 3004, 3.5 kW Gas
Refrigerator volume (thereof freezer), approx.	l	137 (15)	137 (15)	137 (15)	137 (15)
Waste water tank, approx.	l	23	23	23	23
Fresh water tank capacity, total/ Fresh water tank capacity at driving filling	l	44 / 15	44 / 15	44 / 15	44 / 15
Sockets: 12 V / 230 V / USB		0 / 5 / 0	0 / 6 / 0	0 / 5 / 0	0 / 6 / 0

○ Optional equipment — Not possible ● Standard equipment ◆ Mandatory ▲ Not known at the time of publication



The specified mass in running order is a standard value defined in the type approval procedure. Due to manufacturing tolerances, the actual weighed mass in running order may deviate from the value stated above. Deviations of up to ± 5% of the mass in running order are legally permissible and possible. The permissible range in kilograms is stated in parentheses after the mass in running order. The mass for optional equipment specified by the manufacturer is an imputed value determined for each type and layout by which Dethleffs specifies the maximum weight available for factory-fitted optional equipment. The purpose of limiting optional equipment is to ensure that the minimum payload, i.e. the legally required free mass for baggage and retrofitted accessories, is actually available for the load capacity of vehicles delivered by

Dethleffs. The actual weight of your vehicle after leaving the factory can only be determined when it is weighed at the end of the line. If, in exceptional cases, the weighing shows that the actual load capacity falls short of the minimum payload due to a permissible weight deviation, despite the limitation of the optional equipment, we will check together with your trading partner and you before delivery of the vehicle whether we should, for example, increase the load capacity of the vehicle or remove optional equipment. The technically permissible maximum laden mass of the vehicle must not be exceeded. For detailed information and explanations on the topic of weight and the configuration of the vehicle, please refer to the "Legal notes" section.

# Standard equipment

	415 QL	475 EL	475 FR	495 FR	495 QSK	565 FMK	up 465 KR	up 525 KR
<b>Chassis</b>								
Tyres on steel wheels 185 R14 C 8 PR, up to and including 1.600 kg	●	●	●	●	●	●	●	●
Zinc-plated chassis with inertia braking system with reversing automatic	●	●	●	●	●	●	●	●
<b>Chassis features</b>								
AAA self-adjusting brake	—	—	—	—	—	—	●	●
ACS stabiliser	●	●	●	●	●	●	●	●
High-quality brand-name tyres, designed for a speed of 100 km/h	●	●	●	●	●	●	●	●
Lightweight zinc-plated corner steadies	●	●	●	●	●	●	●	●
Octagon shock absorber	●	●	●	●	●	●	●	●
<b>Exterior features</b>								
Floor of the gas bottle locker made of rot-resistant and robust corrugated aluminium	●	●	●	●	●	●	●	●
Front, rear and roof made of robust GRP	●	●	●	●	●	●	●	●
One-piece habitation door	●	●	●	●	●	●	●	●
Opening windows, trapezoid, insulated and double-glazed (graphite grey) with blackout and mosquito blinds	●	—	●	●	●	●	●	●
Skylight Mini Heki	●	—	●	●	●	●	●	●
Spare wheel carrier in gas locker	●	●	●	●	●	●	●	●
Storage space for 2 gas bottles with 11 kg filling weight each	●	●	●	●	●	●	●	●
<b>Exterior design</b>								
Sides in hammer finish, white	●	●	●	●	●	●	●	●
<b>Access locker doors</b>								
Access locker door front right side 1000x420 mm	●	●	●	●	●	—	—	—
Access locker door front right side 749x297 mm	—	—	—	—	—	—	●	—
Access locker door front right side 997x419 mm	—	—	—	—	—	—	—	●
<b>Interior design</b>								
Upholstery Ronda	●	●	●	●	●	●	●	●
WEB Alaska White	●	●	●	●	●	●	●	●
<b>Textile equipment</b>								
7-zones cold foam mattress single bed, left side, standard	—	●	—	—	—	—	—	—
7-zones cold foam mattress single bed, right side, standard	—	●	—	—	—	—	—	—
Cold foam double bed mattress	●	—	●	●	●	●	●	●
<b>Furniture layouts</b>								
AirPlus - perfect air circulation in the interior and rear ventilation of the overhead lockers and sideboards	●	●	●	●	●	●	●	●
Bunk bed with 2 sleeping berths, foldable	—	—	—	—	●	●	●	●
Bunk beds with safety net and ladder	—	—	—	—	●	●	●	●
Seating lounge converts to bed	●	●	●	●	●	●	●	●
Spacious pull-down bed above seating lounge, with manual control	—	—	—	—	—	—	●	●
Special slatted frame with flexible natural rubber holders, opening for optimal use of storage compartments under the beds	●	●	●	●	●	●	●	●
<b>Interior features</b>								
Smoke detector	●	●	●	●	●	●	●	●
<b>Kitchen</b>								
Generous drawers with soft closing for absolutely silent closing	●	●	●	●	●	●	●	●
Large fridge with 137 liters capacity and 15 liters freezer compartment	—	—	●	●	●	●	●	●
Practical 3-flames cooker with electric ignition	●	●	●	●	●	●	●	●
Spacious fridge with 78 liters volume and 11 liters freezer compartment	●	●	—	—	—	—	—	—
<b>Bathroom</b>								
Shapely washbasin	●	●	●	●	●	●	●	●
Shower tray	●	●	●	●	●	●	●	●
Skylight with mosquito net	●	●	●	●	●	●	●	●
<b>Heating</b>								

# Standard equipment

	415 QL	475 EL	475 FR	495 FR	495 QSK	565 FMK	up 465 KR	up 525 KR
Gas heating S 3004 with automatic ignition	●	●	●	●	●	—	●	●
Gas heating S 5004 with automatic ignition	—	—	—	—	—	●	—	—
<b>Electrical installation</b>								
12 V power supply throughout vehicle	●	●	●	●	●	●	●	●
Additional lighting through LED spotlights	●	●	●	●	●	●	●	●
Awning light 12V	●	●	●	●	●	●	●	●
CEE external output socket for 230V on-board electrics	●	●	●	●	●	●	●	●
Compact power distribution unit with 230V safety device and 12V fuse box in wardrobe incl. powerful 340W transformer	●	●	●	●	●	●	●	●
LED spots in front and rear seating lounges	●	●	●	●	●	●	●	●
<b>Water supply</b>								
Electric water supply	●	●	●	●	●	●	●	●
Fresh water tank 44 l	●	●	●	●	●	●	●	●
Mobile 22 l waste water tank	●	●	●	●	●	●	●	●
<b>Miscellaneous</b>								
Dethleffs Connect - System Information Unit: SIU control unit incl. voltage and levelling display via the Dethleffs app.	●	●	●	●	●	●	●	●

## Packages c'go & c'go up

Package	Safety Package (9556)	Safety Package (9556)
ATC Trailer Control	x	x
DuoControl safety gas pressure regulator with crash sensor	x	
DuoControl safety gas pressure regulator with crash sensor and EisEx gas regulator heater		x
Additional weight (kg)*	4.4	4.4

Package	Autonomy Package I (10011)	Autonomy Package II (10012)
Battery (95 Ah)	x	x
Battery charger	x	x
Central 12V main switch	x	x
Voltage display	x	x
Fan 12V for S 3004	x	
Additional weight (kg)*	31	29



The factory installation of optional equipment increases the actual mass of the vehicle and reduces the payload. The specified additional weight for packages and optional equipment shows the additional weight compared with the standard equipment of the respective model or layout. The total weight of the selected optional equipment must not exceed the mass for optional equipment specified by the manufacturer in the model overviews. This is an imputed

value determined for each model and layout that Dethleffs uses to determine the maximum weight available for factory-installed optional equipment. In the event of an increase of load capacity, the mass for optional equipment specified by the manufacturer is increased. For detailed information and explanations on the topic of weight, please refer to the "Legal notes" section.

Package	Edition 10 Package 415 QL (14232)	Edition 10 Package 475 EL/FR (14232)	Edition 10 Package 495 FR (14232)	Edition 10 Package 495 QSK (14232)	Edition 10 Package 565 FMK (14232)	Edition 10 Package up 465 KR (14234)	Edition 10 Package up 525 KR (14236)
Draw bar cover	x	x	x	x	x	x	x
17" alloy wheels in Dethleffs design (single axle)	x	x	x	x	x	x	x
Corner steadies incl. large-area support feet	x	x	x	x	x	x	x
Hot water supply	x	x	x	x	x	x	x
Flyscreen door	x	x	x	x	x	x	x
Hot air system	x	x	x	x	x	x	x
Heki II skylight incl. illuminated roof lining	x	x	x	x	x	x	x
Weight upgrade 1.700 kg (incl. steel wheel 195 R14 C LI106)	x						
Front window	x	x	x	x	x		
Indirect lighting	x	x	x	x	x	x	x
Shower equipment with shower fittings and curtain	x	x	x	x	x	x	x
ATC Trailer Control	x	x	x	x	x	x	x
Smooth sides white	x	x				x	
Weight upgrade 1.700 kg (incl. steel wheel 195 R14 C LI106)		x					
Smooth sides white			x	x	x		x
Weight upgrade 1.700 kg (incl. steel wheel 195 R14 C LI106)			x				
Weight upgrade 1.700 kg (incl. steel wheel 195 R14 C LI106)				x			
Weight upgrade 1.700 kg (incl. steel wheel 195 R14 C LI106)					x		
Weight upgrade 1.700 kg (incl. steel wheel 195 R14 C LI106)						x	
Weight upgrade 1.800 kg (incl. steel wheel 195 R14 C LI106)							x
Additional weight (kg)*	65	86	94	66	56	55	55

#### Touring Package (7345)

Hot water supply  
Hot air system  
Flyscreen door  
Heki II skylight incl. illuminated roof lining

Additional weight (kg)\*

15

△ Not known at the time of publication



The factory installation of optional equipment increases the actual mass of the vehicle and reduces the payload. The specified additional weight for packages and optional equipment shows the additional weight compared with the standard equipment of the respective model or layout. The total weight of the selected optional equipment must not exceed the mass for optional equipment specified by the manufacturer in the model overviews. This is an imputed

value determined for each model and layout that Dethleffs uses to determine the maximum weight available for factory-installed optional equipment. In the event of an increase of load capacity, the mass for optional equipment specified by the manufacturer is increased. For detailed information and explanations on the topic of weight, please refer to the "Legal notes" section.

# Optional equipment\*\*

Included in package	Additional weight (kg)*	Code	415 QL	475 EL	475 FR	495 FR	495 QSK	565 FMK	up 465 KR	up 525 KR
---------------------	-------------------------	------	--------	--------	--------	--------	---------	---------	-----------	-----------

## Chassis

17" alloy wheels in Dethleffs design (single axle)	ED	1	11608	○	○	○	○	○	○	○
Tyres on alloy wheels 185 R14 C LI102, up to and including 1600 kg	—	1	836	○	○	○	○	○	○	○
Tyres on alloy wheels 195 R14 C LI106, 1700 kg and 1800 kg	—	1	838	○	○	○	○	○	○	○

## Weight upgrade

Weight upgrade 1.700 kg (incl. steel wheel 195 R14 C LI106)	ED	15	278	○	—	—	—	—	—	—
Weight upgrade 1.700 kg (incl. steel wheel 195 R14 C LI106)	ED	36	278	—	○	○	—	—	—	—
Weight upgrade 1.700 kg (incl. steel wheel 195 R14 C LI106)	ED	6	278	—	—	—	—	○	—	—
Weight upgrade 1.700 kg (incl. steel wheel 195 R14 C LI106)	ED	8	278	—	—	—	—	—	○	—
Weight upgrade 1.700 kg (incl. steel wheel 195 R14 C LI106)	ED	44	278	—	—	—	○	—	—	—
Weight upgrade 1.700 kg (incl. steel wheel 195 R14 C LI106)	ED	16	278	—	—	—	—	○	—	—
Weight upgrade 1.800 kg (incl. steel wheel 195 R14 C LI106)	—	6	279	—	—	—	—	—	○	—
Weight upgrade 1.800 kg (incl. steel wheel 195 R14 C LI106)	ED	8	279	—	—	—	—	—	—	○
Weight upgrade 1.900 kg (incl. alloy wheel 225/70 R15 C LI112)	—	13	394	—	—	—	—	—	○	—
Weight upgrade 2.000 kg (incl. alloy wheel 225/70 R15 C LI112)	—	13	138	—	—	—	—	—	○	—
Weight upgrade to 1.300 kg	—	0	135	○	—	—	—	—	—	—
Weight upgrade to 1.360 kg (without chassis change)	—	0	9619	○	○	○	—	—	—	—
Weight upgrade to 1.400 kg	—	0	359	○	○	—	—	○	—	—
Weight upgrade to 1.400 kg	—	16	359	—	—	○	—	—	—	—
Weight upgrade to 1.400 kg	—	38	359	—	—	—	○	—	—	—
Weight upgrade to 1.500 kg	—	16	136	—	—	○	—	—	—	—
Weight upgrade to 1.500 kg	—	38	136	—	—	—	○	—	—	—
Weight upgrade to 1.500 kg	—	0	136	○	○	—	—	○	—	—

## Chassis features

ATC Trailer Control	SHP, ED	4	748	○	○	○	○	○	○	○
Corner steadies incl. large-area support feet	ED	4	9138	○	○	○	○	○	○	○
Draw bar cover	ED	2	434	○	○	○	○	○	○	○
Solid rubber support wheel with support load indicator	—	2	10063	○	○	○	○	○	○	○
Spare tyre with alloy wheel 185 R14 C LI 102, up to and including 1.600 kg	—	17	837	○	○	○	○	○	○	○
Spare tyre with alloy wheel 195 R14 C 8PR-LI 106, 1.700 kg and 1.800 kg	—	19	839	○	○	○	○	○	○	○
Spare tyre with alloy wheel 215/60 R17 C LI 109	—	24.1	11540	○	○	○	○	○	○	○
Spare tyre with steel wheel 185 R14 C 8 PR, up to and including 1.600 kg	—	18	831	○	○	○	○	○	○	○
Spare tyre with steel wheel 195 R14 C LI 106, 1.700 kg and 1.800 kg	—	20.4	833	○	○	○	○	○	○	○
Wheel trims for 14" tyres	—	0.5	276	○	○	○	○	○	○	○

## Exterior features

Flyscreen door	TP, ED	3	360	○	○	○	○	○	○	○
Front window	ED	3	982	○	○	○	○	○	—	—
Heki II skylight incl. illuminated roof lining	TP, ED	10	274	○	○	○	○	○	○	○
Kitchen window, sliding (change of window shape)	—	3	6406	○	○	○	○	○	○	○
One-piece habitation door with window	—	0	6427	—	—	—	—	—	○	○



The factory installation of optional equipment increases the actual mass of the vehicle and reduces the payload. The specified additional weight for packages and optional equipment shows the additional weight compared with the standard equipment of the respective model or layout. The total weight of the selected optional equipment must not exceed the mass for optional equipment specified by the manufacturer in the model overviews. This is an imputed

value determined for each model and layout that Dethleffs uses to determine the maximum weight available for factory-installed optional equipment. In the event of an increase of load capacity, the mass for optional equipment specified by the manufacturer is increased. For detailed information and explanations on the topic of weight, please refer to the "Legal notes" section.



# Optional equipment\*\*

	Included in package	Additional weight (kg)*	Code	415 QL	475 EL	475 FR	495 FR	495 QSK	565 FMK	up 465 KR	up 525 KR
Opening window in bathroom	—	2	1028	○	○	○	○	○	○	○	○
<b>Exterior design</b>											
Smooth sides white	ED	17	443	○	○	○	—	—	—	○	—
Smooth sides white	ED	17	443	—	—	—	○	○	○	—	○
<b>Access locker doors</b>											
Access locker door front left side 1000x420 mm	—	2	6415	○	○	—	—	○	●	—	—
Access locker door front right side 1675x885 mm	—	0	9430	—	—	—	—	—	—	—	○
Access locker door front right side 560x1150 mm	—	0	10393	—	—	—	—	—	—	○	—
Access locker door rear left side 749x297 mm	—	2	1077	—	—	—	—	—	—	—	○
Access locker door rear right side 749x297 mm	—	2	1078	—	—	—	—	—	—	○	○
Access locker door rear right side 750x300 mm	—	2	6422	○	—	○	○	—	—	—	—
<b>Interior design</b>											
Upholstery Estepona	—	0	13901	○	○	○	○	○	○	○	○
Upholstery Manilva	—	0	13902	○	○	○	○	○	○	○	○
<b>Textile equipment</b>											
7-zones mattress, made of heat-regulating material	—	0	10318	○	○	○	○	○	○	○	○
Loose carpet	—	7	513	○	○	○	○	○	○	○	○
<b>Furniture layouts</b>											
Bunk bed with 3 sleeping berths, not foldable	—	21	200	—	—	—	—	○	○	—	—
Hanging table with rotating device	—	0	8699	—	—	—	—	○	—	—	—
Seat enlargement for opposite seating lounge (in comb. with option 8699) <sup>3)</sup>	—	0	7750	—	—	—	—	○	—	—	—
Single beds convert to double bed	—	6	685	—	○	—	—	—	—	—	—
<b>Multimedia</b>											
Multifunctional external connection, 12 V, 220 V, TV and SAT <sup>4)</sup>	—	1	611	○	○	○	○	○	○	○	○
Preparation for flat screen TV (antenna cable and TV bracket)	—	2	678	○	○	○	○	○	○	○	○
<b>Heating</b>											
Electric floor heating	—	6	387	○	○	○	○	○	○	○	○
Fan 12 V with automatic speed control for S 5004	—	2	178	—	—	—	—	—	○	—	—
Fan 12V for S 3004	AP	2	177	○	○	○	○	○	—	○	○
Hot air system	TP, ED	0	142	○	○	○	○	○	○	○	○
Ultraheat additional heating for S 3004, electric 220 V	—	2	364	○	○	○	○	○	—	○	○
Ultraheat additional heating for S 5004, electric 220 V	—	2	422	—	—	—	—	—	○	—	—
<b>Air Conditioning</b>											
Pre-wiring for A/C	—	3.5	172	○	○	○	○	○	○	○	○
<b>Electrical installation</b>											
Indirect lighting	ED	1	633	○	○	○	○	○	○	○	○
USB port for spotlight bar	—	0.5	9989	○	○	○	○	○	○	—	○
<b>Water supply</b>											



The factory installation of optional equipment increases the actual mass of the vehicle and reduces the payload. The specified additional weight for packages and optional equipment shows the additional weight compared with the standard equipment of the respective model or layout. The total weight of the selected optional equipment must not exceed the mass for optional equipment specified by the manufacturer in the model overviews. This is an imputed

value determined for each model and layout that Dethleffs uses to determine the maximum weight available for factory-installed optional equipment. In the event of an increase of load capacity, the mass for optional equipment specified by the manufacturer is increased. For detailed information and explanations on the topic of weight, please refer to the "Legal notes" section.

# Optional equipment\*\*

	Included in package	Additional weight (kg)*	Code	415 QL	475 EL	475 FR	495 FR	495 QSK	565 FMK	up 465 KR	up 525 KR
City water connection	—	2	414	—	—	—	—	—	—	○	○
Hot water supply	TP, ED	2	123	○	○	○	○	○	○	○	○
Shower equipment with shower fittings and curtain	ED	3	1097	○	○	○	○	○	○	○	○
<b>Gas supply</b>											
DuoControl safety gas pressure regulator with crash sensor	SHP	0.4	784	○	○	○	○	○	○	○	○
DuoControl safety gas pressure regulator with crash sensor and EisEx gas regulator heater	—	2.5	784	—	—	—	—	—	—	○	○
Gas detection system	—	0.5	10058	○	○	○	○	○	○	○	○
Gas socket (exterior) <sup>5)</sup>	—	1	187	○	○	○	○	○	○	○	○
<b>Packages</b>											
Autonomy Package I <sup>6)</sup>	—	31	10011	○	○	○	○	○	○	○	○
Autonomy Package II	—	29	10012	○	○	○	○	○	○	○	○
Edition 10 Package 415 QL	—	65	14232	○	—	—	—	—	—	—	—
Edition 10 Package 475 EL/FR	—	86	14232	—	○	○	—	—	—	—	—
Edition 10 Package 495 FR	—	94	14232	—	—	—	○	—	—	—	—
Edition 10 Package 495 QSK	—	66	14232	—	—	—	—	○	—	—	—
Edition 10 Package 565 FMK	—	56	14232	—	—	—	—	—	○	—	—
Edition 10 Package up 465 KR	—	55	14234	—	—	—	—	—	—	○	—
Edition 10 Package up 525 KR	—	55	14236	—	—	—	—	—	—	—	○
Safety Package	—	4.4	9556	○	○	○	○	○	○	—	—
Safety Package	—	4.4	9556	—	—	—	—	—	—	○	○
Touring Package	—	15	7345	○	○	○	○	○	○	○	○
<b>Miscellaneous</b>											
Registration documents (CoC papers)	—	0	15151	◆	◆	◆	◆	◆	◆	◆	◆

○ Optional equipment — Not possible ● Standard equipment ◆ Mandatory △ Not known at the time of publication

ED Edition 10 Package SHP Safety Package TP Touring Package AP Autonomy Package



The factory installation of optional equipment increases the actual mass of the vehicle and reduces the payload. The specified additional weight for packages and optional equipment shows the additional weight compared with the standard equipment of the respective model or layout. The total weight of the selected optional equipment must not exceed the mass for optional equipment specified by the manufacturer in the model overviews. This is an imputed

value determined for each model and layout that Dethleffs uses to determine the maximum weight available for factory-installed optional equipment. In the event of an increase of load capacity, the mass for optional equipment specified by the manufacturer is increased. For detailed information and explanations on the topic of weight, please refer to the "Legal notes" section.

# IMPORTANT INFORMATION REGARDING THE SELECTION OF YOUR CARAVAN

When purchasing a caravan, it is especially important to select not only an appealing design, but also the right layout. Weight also plays an essential role here. Family, friends, optional equipment, accessories, and baggage – there should be enough space for all of this. At the same time, there are legal and technical limits for configuration and loading. Each caravan is designed for a certain weight which must not be exceeded during travel. This raises a question for caravan buyers: How should I configure my vehicle to accommodate baggage and accessories according to my needs without causing the vehicle to exceed this maximum weight? To help you make this decision, we have provided you some information below that is particularly important when selecting your vehicle from our product range:

## 1. The technically permissible maximum laden mass...

... is a value specified by the manufacturer which the vehicle must not exceed. Based on the layout, Dethleffs specifies an upper limit for the vehicle, which can vary from layout to layout (e.g. 1,600 kg, 1,700 kg). You will find the corresponding specification for each layout in the technical data.

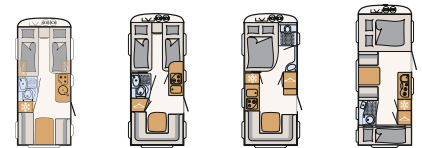

Caravans		460 EL	470 ER	470 FR	500 QSK
Sleeping berths standard / max.		3	3	4	5/6 ○
● Technically permissible maximum laden mass*	kg	1500	1500	1500	1500
Manufacturer-specified mass for optional equipment*	kg	180	188	158	96
● Mass in running order (± 5 %)*	kg	1235 (1173 to 1297)*	1225 (1164 to 1286)*	1245 (1183 to 1307)*	1295 (1130 to 1360)*

## 2. The mass in running order...

... consists – to put it simply – of the basic vehicle with standard equipment. It is legally permissible and possible for the mass in running order of your vehicle to deviate from the nominal value specified in the sales documents. The permissible tolerance is ± 5%. The permissible range in kilograms is stated in parentheses after the mass in running order. In order to provide you with full transparency regarding possible weight deviations, Dethleffs weighs each vehicle at the end of the line and informs your trading partner of the weighing result of your vehicle for forwarding to you. For detailed explanations of the mass in running order and the effect of tolerances on the minimum payload and the payload, please refer to the “Legal notes” section.

### 3. The standard sleeping berths...

... are specified by the manufacturer and shown in the sales documents. The number of sleeping berths can be increased (e.g. 3-person bunk bed) or, if required, reduced (e.g. sideboard instead of seating group) by selecting optional equipment.

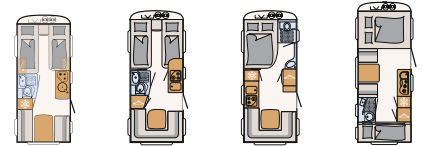

Caravans		460 EL	470 ER	470 FR	500 QSK
● Sleeping berths standard / max.		3	3	4	5/6 ○
Technically permissible maximum laden mass*	kg	1500	1500	1500	1500
● Manufacturer-specified mass for optional equipment*	kg	180	188	158	96
Mass in running order ((± 5 %)*	kg	1235 (1173 to 1297)*	1225 (1164 to 1286)*	1245 (1183 to 1307)*	1295 (1130 to 1360)*

### 4. The mass for optional equipment specified by the manufacturer...

... is a value set for each layout by Dethleffs for the maximum mass of optional equipment that can be ordered. This limit is intended to ensure that the minimum payload, i.e. the legally required free mass for baggage and retrofitted accessories, is actually available for the load capacity of the vehicles delivered by Dethleffs. If, in exceptional cases, the weighing at the end of the line nevertheless shows that the actual load capacity falls short of the minimum payload due to a permissible weight deviation, we will check together with your trading partner and you whether we should, for example, increase the load capacity of the vehicle or remove optional equipment before delivering the vehicle. For detailed explanations of the effects of the tolerances on the minimum payload and the payload, please refer to the "Legal notes" section.

## Optional equipment\*

	Included in package	Price	Additional weight (kg)*	Code	460 EL	470 ER	470 FR
<b>Bathroom</b>							
Bathroom in alternative design	-	399,-	4	604	-	-	-
<b>Multimedia</b>							
Multifunctional external connection, 12 V, 220 V, TV and SAT	-	1.129,-	10	1049	-	○	○
Flat screen TV 22" incl. DVD player and receiver	-	999,-	3.5	1103	○	○	○

### 5. The additional weight of optional equipment and packages...

... increases the actual mass of the vehicle (= mass in running order plus selected optional equipment) and reduces the payload. The specified value shows the additional weight compared to the standard equipment of the respective layout. The total weight of the selected packages and optional equipment must not exceed the mass for optional equipment specified by the manufacturer.