

Just Go Low Profile



Experience the world of motorhomes simply and easily - the new Just Go, based on the Ford Transit, does it perfectly.

Comprehensive equipment as well as modern interior with feel-good character, it already has everything on board as standard - and at a real friendship price. Want more? The Comfort Package supplements the standard equipment with lots of added value: more safety, more comfort, more fun. Just do it!

Technical info

Overall length, approx.	669 - 736 cm
Overall width, approx.	233 cm
Overall height, approx.	299 cm
Headroom in living area, approx.	213 cm

Maximum values partly not possible for all models or only in connection with certain options.

Upholstery



+ Upholstery Ravello



+ Upholstery Calypso
incl. driver and
passenger seat cover
○



+ Upholstery Salerno
incl. driver and front
passenger seat cover

Plus factors

- + Proven Dethleffs quality at an attractive, friendly price
- + 70 cm wide habitation door
- + Interior height 2.13 m (not below pull-down bed)
- + Pleasant sleeping comfort thanks to 7-zone cold foam mattresses made of climate-regulating material and ergonomic wooden slatted frames
- + Optional pull-down bed
- + Fully equipped kitchen with 2-burner hob and Multiflex rail system
- + 137 l fridge with large freezer compartment



Wood décor



+ Wood décor Noce Nagano

○ optionally available

Just Go Low Profile

Technical info

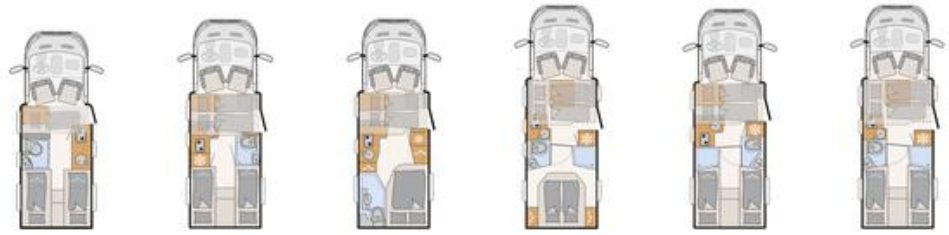

Just Go Low Profile		T 6615 EB	T 6815 EB	T 6905	T 7055 DBL	T 7055 EB	T 7055 EBL
Standard chassis		Ford Transit Low Platform	Ford Transit Low Platform	Ford Transit Low Platform	Ford Transit Low Platform	Ford Transit Low Platform	Ford Transit Low Platform
Emission standards		Euro VI-E	Euro VI-E	Euro VI-E	Euro VI-E	Euro VI-E	Euro VI-E
Overall length, approx.	cm	669	699	699	736	736	736
Overall width, approx.	cm	233	233	233	233	233	233
Overall height, approx.	cm	299 ¹⁾	299 ¹⁾	299 ¹⁾	299 ¹⁾	299 ¹⁾	299 ¹⁾
Headroom in living area, approx.	cm	213	213	213	213	213	213
Towable load braked/unbraked	kg	2000 / 750	2000 / 750	2000 / 750	2000 / 750	2000 / 750	2000 / 750
Wheelbase, approx.	mm	3750	3750	3750	3954	3954	3954
Bed dimension: Front bed, L x W, approx.	cm	200 x 85 ○	200 x 140 - 120 ○	200 x 140 - 120 ○	200 x 140 ○	200 x 140 - 115 ○	200 x 140 ○
Bed dimension: Central / middle bed, L X W, approx.	cm	157 x 101 - 75 ○	210 x 100 - 65 ○	210 x 100 - 65 ○	210 x 105 - 80 ○	210 x 108 - 65 ○	210 x 105 - 80 ○
Bed dimension: Rear bed, L x W, approx.	cm	202 x 80 / 198 x 80 / 210 x 170 ○	198 x 80 / 208 x 80 / 210 x 170 ○	200 x 135 - 100	190 x 150	2x 215 x 80 / 210 x 190 ○	2x 215 x 80 / 210 x 190 ○
Sleeping berths standard / max.		2 / 4 ○	2 / 5 ○	2 / 5 ○	2 / 5 ○	2 / 5 ○	2 / 5 ○
Standard engine		2,0 l TDCi Ford EcoBlue	2,0 l TDCi Ford EcoBlue	2,0 l TDCi Ford EcoBlue	2,0 l TDCi Ford EcoBlue	2,0 l TDCi Ford EcoBlue	2,0 l TDCi Ford EcoBlue
kW (bhp)		96 (130)	96 (130)	96 (130)	96 (130)	96 (130)	96 (130)
Mass in running order (+/-5%)*	kg	2800 (2660 to 2940)*	2865 (2722 to 3008)*	2880 (2736 to 3024)*	2895 (2750 to 3040)*	2885 (2741 to 3029)*	2900 (2755 to 3045)*
Manufacturer-specified mass for optional equipment*	kg	353	290	270	256	266	251
Technically permissible maximum laden mass*	kg	3500	3500	3500	3500	3500	3500
Permitted number of seats (including driver)*		4	4 - 5 ○	4	4	4	4
Refrigerator volume (thereof freezer), approx.		83 (8) / 137 (15) ○	137 (15)	137 (15) / 137 (15) ○	137 (15) / 137 (15) ○	137 (15) / 137 (15) ○	137 (15) / 137 (15) ○



The specified mass in running order is a default value defined in the type-approval procedure. Due to manufacturing tolerances, the actual weighed mass in running order may deviate from the value stated above. Deviations of up to ± 5 % of the mass in running order are legally permissible and possible. The permissible range in kilograms is given in brackets after the mass in running order. The manufacturer-specified mass for optional equipment is a calculated value for each type and layout that Dethleffs uses to determine the maximum weight available for factory-fitted optional equipment. The limitation of optional equipment is intended to ensure that the minimum pay-mass, i.e. the legally prescribed free mass for baggage and retrofitted accessories, is actually available for the vehicle load capacity of the vehicles delivered by Dethleffs. The real weight of your vehicle ex works can only be determined when it is

weighed at the end of the line. If, in exceptional cases, the weighing shows that the actual load capacity falls below the minimum pay-mass despite limiting the optional equipment due to a permissible weight deviation, we will check together with your trade partner and you whether we should, for example, increase the load capacity of the vehicle, reduce the number of seats or remove optional equipment before delivering the vehicle. The technically permissible maximum laden mass of the vehicle and the technically permissible maximum mass on the axle must not be exceeded. Detailed information & explanations on the subject of weight and the configuration of the vehicle can be found in the section Legal information. For a more detailed description of all mandatory technical dependencies, please refer to the explanations on the footnotes.

Just Go Low Profile

Technical info

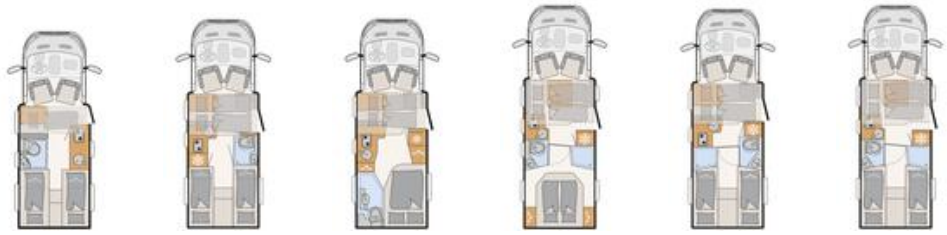

Just Go Low Profile	T 6615 EB	T 6815 EB	T 6905	T 7055 DBL	T 7055 EB	T 7055 EBL
Waste water tank, approx.	95	95	95	95	95	95
Fresh water tank capacity, total/ Fresh water tank capacity at driving filling	115 / 20	115 / 20	115 / 20	115 / 20	115 / 20	115 / 20
Measurement storage opening left (W x H) cm	55 x 95 ○	75 x 95 ○		95 x 95 ○	95 x 95 ○	95 x 95 ○
Measurement storage opening right (W x H) cm	55 x 115	75 x 115	85 x 60	93 x 115	93 x 115	93 x 115

○ Optional equipment — Not possible ● Standard equipment ◆ Mandatory ▲ Zum Zeitpunkt der Veröffentlichung nicht bekannt



The specified mass in running order is a default value defined in the type-approval procedure. Due to manufacturing tolerances, the actual weighed mass in running order may deviate from the value stated above. Deviations of up to ± 5 % of the mass in running order are legally permissible and possible. The permissible range in kilograms is given in brackets after the mass in running order. The manufacturer-specified mass for optional equipment is a calculated value for each type and layout that Dethleffs uses to determine the maximum weight available for factory-fitted optional equipment. The limitation of optional equipment is intended to ensure that the minimum pay-mass, i.e. the legally prescribed free mass for baggage and retrofitted accessories, is actually available for the vehicle load capacity of the vehicles delivered by Dethleffs. The real weight of your vehicle ex works can only be determined when it is

weighed at the end of the line. If, in exceptional cases, the weighing shows that the actual load capacity falls below the minimum pay-mass despite limiting the optional equipment due to a permissible weight deviation, we will check together with your trade partner and you whether we should, for example, increase the load capacity of the vehicle, reduce the number of seats or remove optional equipment before delivering the vehicle. The technically permissible maximum laden mass of the vehicle and the technically permissible maximum mass on the axle must not be exceeded. Detailed information & explanations on the subject of weight and the configuration of the vehicle can be found in the section Legal information. For a more detailed description of all mandatory technical dependencies, please refer to the explanations on the footnotes.

Standard equipment

	T 6615 EB	T 6815 EB	T 6905	T 7055 DBL	T 7055 EB	T 7055 EBL
Ford chassis						
Ford Transit Light low platform (3,499 kg), TDCi EcoBlue (2.0 l / 96 kW / 130 hp) Heavy Duty, 6-speed manual transmission	●	●	●	●	●	●
Steel rims 16" (236/65 R16) with wheel trims	●	●	●	●	●	●
Ford chassis features						
70l fuel tank	●	●	●	●	●	●
ABS, EBD, ESP, TCS, Hill Start Assist, Crosswind Assist, Safety Brake Assist, Rollover Protection Cab, Emergency Brake Support incl. Emergency Brake Light	●	●	●	●	●	●
Cruise control	●	●	●	●	●	●
Driver airbag	●	●	●	●	●	●
Driver and passenger seat Pilot Chair with double armrest, swivelling	●	●	●	●	●	●
Exterior Colour Cab Frost White	●	●	●	●	●	●
Exterior mirrors manually adjustable	●	●	●	●	●	●
Fix&Go kit (tyre repair kit)	●	●	●	●	●	●
Ford 6-speed manual gear box	●	●	●	●	●	●
Ford audio system radio incl. DAB/DAB+, remote control on steering wheel, hands-free system, 4 speakers and antenna	●	●	●	●	●	●
Front-wheel drive	●	●	●	●	●	●
Leather steering wheel	●	●	●	●	●	●
Passenger airbag	●	●	●	●	●	●
Rear axle mudflaps	●	●	●	●	●	●
Wider rear axle	●	●	●	●	●	●
Exterior features						
70 cm wide habitation door	●	●	●	●	●	●
Bedroom window right and left	●	●	—	●	●	●
Dethleffs Exclusive rear light carrier with 3rd brake light	●	●	●	●	●	●
EPS insulation	●	●	●	●	●	●
Floor thickness: 49 mm, side wall thickness: 34mm and roof thickness: 35 mm	●	●	●	●	●	●
Flyscreen habitation door	●	●	●	●	●	●
GRP roof	●	●	●	●	●	●
Habitation access with comfortable, wide, electric step	●	●	●	●	●	●
Large rear garage: right-hand garage door with turn/tighten lock, rear lowering (150 kg surface load), anti-slip surface, heated, lashing strips, illuminated, 1x 230 V socket	●	●	—	●	●	●
Lifetime construction technology: Tried-and-tested reliable flooring and superstructure with excellent insulation	●	●	●	●	●	●
Side panels and rear panel made of resistant high-gloss GRP with smooth, shiny surface	●	●	●	●	●	●
Skylight 40 x 40 cm above the seating lounge	●	●	●	●	●	●
Exterior design						
Exterior body painted in white	●	●	●	●	●	●
Interior design						
Upholstery Ravello	●	●	●	●	●	●
Wood décor Noce Nagano	●	●	●	●	●	●
Textile equipment						
Fixed beds with ergonomic wooden slatted frames and 150 mm thick 7-zone premium mattresses made of climate-regulating material	●	●	●	●	●	●
Furniture layouts						
Cosy lounge seating group with free-standing, rigid table base	—	—	—	●	—	●
French double bed	—	—	●	—	—	—
Height-adjustable double bed	—	—	—	●	—	—
High-level single beds incl. comfortable access via steps	●	●	—	—	●	●
Overhead locker doors with soft-close function	●	●	●	●	●	●
Room-height wardrobes with clothes rail or shelves	—	—	●	—	—	—
Seating area with mountable and extendible table and two integrated 3-point seatbelts	●	●	●	—	●	—
Wardrobe to the left and right of the queen-size bed	—	—	—	●	—	—
Kitchen						
Floor-to-ceiling fridge with separate freezer compartment and automatic energy selection (AES) (137 l)	—	●	●	●	●	●

Standard equipment

	T 6615 EB	T 6815 EB	T 6905	T 7055 DBL	T 7055 EB	T 7055 EBL
Fridge with separate freezer compartment and automatic energy selection (AES) (83 l)	●	—	—	—	—	—
Gourmet kitchen: two-ring hob, large drawers, cutlery tray, bin and generous worktop	●	●	●	●	●	●
MultiFlex rail system incl. hooks (further accessories via Dethleffs Original Accessories)	●	●	●	●	●	●
Bathroom						
Equipped with cabinets, storage compartments, large mirrors, toothbrush mug and toilet paper holder	●	●	—	●	●	●
Large bathroom with separate shower and toilet with locking door to the lounge	—	—	—	●	●	●
Swiveling bathroom wall for optimal use of space	●	●	●	—	—	—
Heating						
Gas hot-air heating 6kW with hot-water boiler	●	●	●	●	●	●
Heating in the seating unit for optimum heat distribution, built-in	●	●	●	●	●	●
Electrical installation						
Automatic switch-on/disconnect for starter battery, leisure battery and refrigerator	●	●	●	●	●	●
Awning light 12 V	●	●	●	●	●	●
Dimmable LED lighting in the separate shower and toilet room	—	—	—	●	●	●
Electric block with integrated overvoltage protection and separate ground fault circuit breaker	●	●	●	●	●	●
LED lighting throughout the vehicle	●	●	●	●	●	●
Leisure battery AGM, 95 Ah	●	●	●	●	●	●
Number of sockets 1x 12V, 7x 230V, 4x USB	●	—	—	—	—	—
Number of sockets 1x 12V, 8x 230V, 4x USB	—	●	●	●	●	●
On-board control panel	●	●	●	●	●	●
Spotlights in the roof lining above the habitation door	●	●	●	●	●	●
Water supply						
Fresh water tank in insulated and heated area	●	●	●	●	●	●
Submersible pump	●	●	●	●	●	●
Gas supply						
Storage space for 2 gas bottles with a filling weight of 11 kg each	●	●	●	●	●	●

PACKAGES JUST GO LOW PROFILE

Package	Package One, 4 m awning (12126)	Package One, 4,5 m awning (12126)	Package X (awning 4.0 m) (11936)	Package X (awning 4.5 m) (11936)
Automatic HD satellite system 65 Twin	x	x		
Flat screen 22" HD TV (incl. DVD player, HDMI, DVB-S2 satellite receiver and terrestrial DVB-T2 receiver)	x	x		
Flat-screen TV bracket	x	x		
Rear view camera (single camera)	x	x	x	x
Omnistor cassette awning 4.0 m (manual)	x		x	
Omnistor cassette awning 4.5 m (manual)		x		x
Additional weight (kg)*	51.6	55.6	35.1	39.1



* INFO

The factory installation of optional equipment increases the actual mass of the vehicle and reduces the pay-mass. The additional weight indicated for packages and optional equipment shows the additional weight compared to the standard equipment of the respective model or layout. The total weight of the selected optional equipment must not exceed the manufacturer-specified mass for

optional equipment shown in the model overviews. This is a calculated value for each type and layout that Dethleffs uses to determine the maximum weight available for factory-fitted optional equipment. Detailed information and explanations on the subject of weight can be found in the Legal information section.

Package	Comfort Package T 6615 EB (13803)	Comfort Package T 6815, 7055 EB (13803)	Comfort Package T 7055 DBL (13803)	Comfort Package T 7055 EBL (13803)	Comfort Package T 6905 (13803)	Camper Premium Package (13715)
Air conditioning incl. dust and pollen filter	x	x	x	x	x	x
Glove compartment with lid, lockable	x	x	x	x	x	x
Interior package Trend Line	x	x	x	x	x	x
Side protection strips painted in car colour	x	x	x	x	x	x
Front bumper painted in car colour	x	x	x	x	x	x
Fog light	x	x	x	x	x	x
Headlamps with static cornering light	x	x	x	x	x	x
Electrically adjustable and heated exterior mirrors	x	x	x	x	x	x
Alloy wheel Ford 16" , black	x	x	x	x	x	
Windscreen, heatable	x	x	x	x	x	
Windscreen wiper with rain sensor	x	x	x	x	x	
Emergency brake assist, activ (camera-based)	x	x	x	x	x	
Lane Assist with drowsiness warning, High Beam Assist and Lane Keep Assist	x	x	x	x	x	
Headlight assist with day/night sensor	x	x	x	x	x	
Habitation door with window incl. blackout and central locking (incl. cab door)	x	x	x	x	x	
Panorama skylight 70 x 50 cm in the living area	x	x	x	x	x	
Upholstery Salerno incl. driver and front passenger seat cover	x	x	x	x	x	
Light Moments: Indirect wall surface ambient lighting	x	x	x	x	x	
Light Moments: Indirect ambient lighting above the overhead lockers	x	x	x	x	x	
Cab blackout blinds	x	x	x	x	x	
Opening window in T-hood	x	x	x	x	x	
Cosy L-shaped seating group with free-standing, lowerable table base and 2 integrated 3-point belts	x	x			x	
Option to convert single beds to double bed	x	x		x		
Access locker door left	x				x	
Access locker door left		x	x	x		
Additional weight (kg)*	51.65	53.65	37.65	45.65	43.65	13



The factory installation of optional equipment increases the actual mass of the vehicle and reduces the pay-mass. The additional weight indicated for packages and optional equipment shows the additional weight compared to the standard equipment of the respective model or layout. The total weight of the selected optional equipment must not exceed the manufacturer-specified mass for

optional equipment shown in the model overviews. This is a calculated value for each type and layout that Dethleffs uses to determine the maximum weight available for factory-fitted optional equipment. Detailed information and explanations on the subject of weight can be found in the Legal information section.

Package	Winter Comfort Package hot-air heating Just Go 6615 (8251)	Winter Comfort Package hot-air heating Just Go 6815 EB, 6905 (8251)	Winter Comfort Package hot-air heating Just Go7055 (8251)
Insulated under-floor pipes	x	x	x
Switch for water pump	x	x	x
Gas hot-air heating 6kW with 1.8kW electric heating element and hot-water boiler incl. digital control panel	x	x	x
Waste water tank and pipes electrically heated	x	x	x
Insulated waste water tank	x	x	x
XPS insulation	x		
XPS insulation		x	
XPS insulation			x
Additional weight (kg)*	25	26	27

Pre-wiring kit (11350)

Pre-wiring for solar

Pre-wiring for roof A/C

Pre-wiring for satellite system

Pre-wiring for first reversing camera

Pre-wiring for second reversing camera

Additional weight (kg)*

7.6

△ Zum Zeitpunkt der Veröffentlichung nicht bekannt



* INFO

The factory installation of optional equipment increases the actual mass of the vehicle and reduces the pay-mass. The additional weight indicated for packages and optional equipment shows the additional weight compared to the standard equipment of the respective model or layout. The total weight of the selected optional equipment must not exceed the manufacturer-specified mass for

optional equipment shown in the model overviews. This is a calculated value for each type and layout that Dethleffs uses to determine the maximum weight available for factory-fitted optional equipment. Detailed information and explanations on the subject of weight can be found in the Legal information section.

Optional equipment**

	Included in package	Additional weight (kg)*	Code	T 6615 EB	T 6815 EB	T 6905	T 7055 DBL	T 7055 EB	T 7055 EBL
Ford chassis									
Ford Transit Light low platform (3,499 kg), TDCi EcoBlue (2.0 l / 114 kW / 155 hp) Heavy Duty, 6-speed automatic transmission ⁵⁾	—	45	155A	○	○	○	○	○	○
Ford Transit Light low platform (3,499 kg), TDCi EcoBlue (2.0 l / 114 kW / 155 hp) Heavy Duty, 6-speed manual transmission	—	0	155S	○	○	○	○	○	○
Ford Transit Light low platform (3,499 kg), TDCi EcoBlue (2.0 l / 96 kW / 130 hp) Heavy Duty, 6-speed automatic transmission ⁵⁾	—	45	130A	○	○	○	○	○	○
Ford chassis features									
Additional seat ¹³⁾	—	14	435	—	○	○	—	—	—
Tow bar (check permissible gross towing weight for trailer operation) ⁵⁾	—	50	273	—	○	○	—	—	—
Tow bar (check permissible gross towing weight for trailer operation) ⁵⁾	—	48	273	○	—	—	—	—	—
Tow bar (check permissible gross towing weight for trailer operation) ⁵⁾	—	51	273	—	—	—	○	○	○
Exterior features									
Access locker door left	CO	8	331	—	○	—	○	○	○
Access locker door left	CO	6	331	○	—	—	—	—	—
Bike rack for 3 bikes (lowerable)	—	21.1	7482	○	○	○	○	○	○
Bike rack for 3 bikes (rear)	—	9.6	938	○	○	○	○	○	○
Stable, double-glazed flush-fitting windows with integrated blinds and flyscreens	—	1	415	○	○	○	○	○	○
Interior design									
Upholstery Calypso incl. driver and passenger seat cover ¹²⁾	—	0	13491	○	○	○	○	○	○
Furniture layouts									
Bed convert for seating lounge transverse	—	6.5	1944	—	○	○	—	—	—
Bed convert for seating lounge transverse	—	7.5	1944	—	—	—	—	○	—
Bed convert for seating lounge transverse	—	5.5	1944	—	—	—	○	—	○
Electric pull-down bed across the seating unit	—	72	680	—	—	—	○	—	○
Electric pull-down bed across the seating unit	—	65	680	—	—	—	—	○	—
Electric pull-down bed across the seating unit	—	64	680	—	—	○	—	—	—
Electric pull-down bed across the seating unit	—	62	680	—	○	—	—	—	—
Electric single folding bed above the seating group	—	52	680	○	—	—	—	—	—
ISOFIX child seat bracket for third and fourth seat facing direction of travel	—	4	8125	○	○	○	—	○	—
Makeshift bed	—	4.5	339	○	—	—	—	—	—
Option to convert single beds to double bed	CO	8	1883	○	○	—	—	○	○
Kitchen									
Fridge (137 l)	—	18	713	○	—	—	—	—	—
Fridge (137 l) with integrated oven	—	12	290	—	—	○	○	○	○
Bathroom									
Additional window in bathroom	—	5	372	—	—	—	○	○	○
Shower grid	—	2	1657	○	—	—	○	○	○
Shower grid	—	1.5	1657	—	○	—	—	—	—
Shower grid	—	4.5	1657	—	—	○	—	—	—
Multimedia									
Dethleffs Moniceiver incl. DAB+, Apple Carplay and Android Auto ^{15) 3)}	—	2.3	13222	○	○	○	○	○	○
Second reversing camera in rear moulding	—	1	11541	○	○	○	○	○	○



The factory installation of optional equipment increases the actual mass of the vehicle and reduces the pay-mass. The additional weight indicated for packages and optional equipment shows the additional weight compared to the standard equipment of the respective model or layout. The total weight of the selected optional equipment must not exceed the manufacturer-specified mass for optional equipment shown in the model overviews. This is a calculated value for each type and layout that Dethleffs uses to determine the maximum weight available for factory-fitted optional equipment. Detailed information and

explanations on the subject of weight can be found in the Legal information section. An increase of load capacity increases the manufacturer-specified mass for optional equipment. The increase results from the higher pay-mass due to the alternative chassis. The increased tare weight of the alternative chassis and, in particular, the weight for any mandatory heavier engine variants (e.g. 180 hp) must be deducted from this. For a more detailed description of all mandatory technical dependencies, please refer to the explanations on the footnotes.

Optional equipment**

	Included in package	Additional weight (kg)*	Code	T 6615 EB	T 6815 EB	T 6905	T 7055 DBL	T 7055 EB	T 7055 EBL
Heating									
Gas hot-air heating 6kW with 1.8kW electric heating element and hot-water boiler incl. digital control panel	WI-KO	1	330	○	○	○	○	○	○
Electrical installation									
Second leisure battery AGM, 95 Ah ¹¹⁾	—	27	830	○	○	○	○	○	○
Solar power system 100 watt	—	12.6	922	○	○	○	○	○	○
Water supply									
Insulated waste water tank	WI-KO	8.5	665	○	○	○	○	○	○
Switch for water pump	WI-KO	0.2	397	○	○	○	○	○	○
Gas supply									
Automatic gas cylinder switchover incl. crash sensor, EisEx and gas filter	—	2.5	1577	○	○	○	○	○	○
Packages									
Camper Premium Package	—	13	13715	○	○	○	○	○	○
Comfort Package T 6615 EB	—	51.65	13803	○	—	—	—	—	—
Comfort Package T 6815, 7055 EB	—	53.65	13803	—	○	—	—	○	—
Comfort Package T 6905	—	43.65	13803	—	—	○	—	—	—
Comfort Package T 7055 DBL	—	37.65	13803	—	—	—	○	—	—
Comfort Package T 7055 EBL	—	45.65	13803	—	—	—	—	—	○
Package One, 4 m awning	—	51.6	12126	○	○	○	—	—	—
Package One, 4,5 m awning	—	55.6	12126	—	—	—	○	○	○
Package X (awning 4.0 m)	—	35.1	11936	○	○	○	—	—	—
Package X (awning 4.5 m)	—	39.1	11936	—	—	—	○	○	○
Pre-wiring kit	—	7.6	11350	○	○	○	○	○	○
Winter Comfort Package hot-air heating Just Go 6615	—	25	8251	○	—	—	—	—	—
Winter Comfort Package hot-air heating Just Go 6815 EB, 6905	—	26	8251	—	○	○	—	—	—
Winter Comfort Package hot-air heating Just Go7055	—	27	8251	—	—	—	○	○	○
Miscellaneous									
Registration documents (CoC papers)	—	0	15152	◆	◆	◆	◆	◆	◆

○ Optional equipment — Not possible ● Standard equipment ◆ Mandatory ▲ Zum Zeitpunkt der Veröffentlichung nicht bekannt

CO Comfort Package WI-KO Winter Comfort Package



The factory installation of optional equipment increases the actual mass of the vehicle and reduces the pay-mass. The additional weight indicated for packages and optional equipment shows the additional weight compared to the standard equipment of the respective model or layout. The total weight of the selected optional equipment must not exceed the manufacturer-specified mass for optional equipment shown in the model overviews. This is a calculated value for each type and layout that Dethleffs uses to determine the maximum weight available for factory-fitted optional equipment. Detailed information and

explanations on the subject of weight can be found in the Legal information section. An increase of load capacity increases the manufacturer-specified mass for optional equipment. The increase results from the higher pay-mass due to the alternative chassis. The increased tare weight of the alternative chassis and, in particular, the weight for any mandatory heavier engine variants (e.g. 180 hp) must be deducted from this. For a more detailed description of all mandatory technical dependencies, please refer to the explanations on the footnotes.

LEGAL NOTES ON WEIGHT-RELATED INFORMATION

The weight specifications and tests for **motorhomes** are uniformly regulated throughout the EU in EU Implementing Regulation No. 2021/535 (until June 2022: EU Implementing Regulation No. 1230/2012). We have summarised and explained the key terms and legal requirements from this **regulation** for you below. Our **dealers** and the Dethleffs configurator on our website offer you additional assistance in configuring your vehicle.

1. Technically permissible maximum laden mass

The **technically permissible maximum laden mass** of the vehicle (e.g. 3,500 kg) is a mass specification set by the manufacturer which the vehicle must not exceed. Information on the **technically permissible maximum laden mass** of the model you have chosen can be found in the technical data. If the vehicle exceeds the **technically permissible maximum laden mass** in everyday driving, this constitutes an administrative offence which may result in a fine.

2. Mass in running order

In simple terms, the **mass in running order** is the basic vehicle with **standard equipment** plus a legally fixed standard weight of 75 kg for the driver. This essentially includes the following items:

- the unladen weight of the vehicle together with the bodywork, including operating fluids such as greases, oils and coolants;
- the **standard equipment**, i.e. all equipment items that are included as standard in the factory-fitted scope of delivery;
- the fresh water tank filled to 100 % in driving mode (driving fill according to manufacturer's specifications;) and an aluminium gas cylinder filled to 100 %;
- the **fuel tank**, which is 90 % full, including fuel;
- the driver, whose weight – regardless of the actual weight – is generally specified as 75 kg in accordance with EU law.

Information on the **mass in running order** can be found for each model in our sales documents. It is important to note that the value for **mass in running order** given in the sales documents is a default value determined in the **type-approval procedure** and verified by the authorities. It is legally permissible and possible for the **mass in running order** of the vehicle delivered to you to deviate from the nominal value stated in the sales documents. The legally permissible **tolerance** is $\pm 5\%$. In this way, the EU legislator accounts for the fact that certain fluctuations in the **mass in running order** occur due to variations in the weight of supplied parts as well as due to processes and weather conditions.

These weight deviations can be illustrated by means of an example calculation:

- **Mass in running order** acc. to sales documents: 2,850 kg
- Legally permissible **tolerance** of $\pm 5\%$: 142.50 kg
- Legally permissible range of **mass in running order**: 2,707.50 kg to 2,992.50 kg

The specific range of permissible weight deviations can be found for each model in the technical data. Dethleffs makes great efforts to reduce weight variations to the minimum that is unavoidable for production reasons. **Deviations** at the upper and lower end of the range are therefore very rare; however, they cannot be completely ruled out technically, even

with all optimisations. The real weight of the vehicle and compliance with the permissible **tolerance** is therefore checked by Dethleffs by weighing each vehicle at the **end of the line**.

3. Mass of the passengers

The **mass of the passengers** is set a standard value of 75 kg for each seat provided by the manufacturer, regardless of the actual weight of the passengers. The **mass of the driver** is already included in the **mass in running order** (see no. 2 above) and is therefore not included again. In the case of a **motorhome** with four **permitted seats**, the **mass of the passengers** is therefore $3 * 75 \text{ kg} = 225 \text{ kg}$.

4. Optional equipment and actual mass of the vehicle

Optional equipment (also: additional equipment) includes, according to the legal definition, all optional equipment parts not included in the **standard equipment** which are fitted to the vehicle under the responsibility of the manufacturer – i.e. ex works – and can be ordered by the customer (e.g. awning, bicycle or motorbike carrier, satellite system, solar system, oven, etc.). Information on the individual or package weights of the **optional equipment** that can be ordered can be found in our sales documents. **Optional equipment** in this sense does not include other **accessories** that are retrofitted by the **dealer** or you personally after the vehicle has been delivered ex works.

The **mass of the vehicle in running order** (see no. 2 above) and the mass of the **optional equipment** fitted to a specific vehicle at the factory are together referred to as the **actual mass**. You will find the corresponding information for your vehicle after handover under item 13.2 of the Certificate of Conformity (CoC). Please note that this specification also represents a standardised value. Since the **mass in running order** – as an element of the **actual mass** – is subject to a legally permissible **tolerance** of $\pm 5\%$ (see no. 2), the **actual mass** may also deviate accordingly from the stated nominal value.

5. Pay-mass and minimum pay-mass

The installation of optional equipment is also subject to technical and legal limits: Only so much optional equipment can be ordered and fitted at the factory that sufficient free weight remains for baggage and other accessories ("pay-mass") without exceeding the technically permissible maximum laden mass. The pay-mass is calculated by subtracting the mass in running order (nominal value according to sales documents, see no. 2 above), mass of the optional equipment and the mass of the passengers (see no. 3 above) from the technically permissible maximum laden mass (see no. 1 above). The EU regulations stipulate a fixed minimum pay-mass for motorhomes, which must remain as a minimum for baggage or other non-factory-fitted accessories. This minimum pay-mass is calculated as follows:

Minimum pay-mass in kg $\geq 10 * (n + L)$

Where: "n" is the maximum number of passengers plus the driver and "L" is the overall length of the vehicle in metres.

For a motorhome with a length of 6 m and 4 approved seats, the minimum pay-mass is therefore e.g. $10 \text{ kg} * (4 + 6) = 100 \text{ kg}$.

To ensure that the **minimum pay-mass** is maintained, there is a maximum combination of **optional equipment** that can be ordered for each vehicle model. In the above example with a **minimum pay-mass** of 100 kg, the total mass of **optional equipment** for a vehicle with four **permitted seats** and a **mass in running order** of 2,850 kg should not exceed 325 kg:

3,500 kg **technically permissible maximum laden mass**
 - 2,850 kg **mass in running order**
 - 3*75 kg **mass of the passengers**
 - 100 kg **minimum pay-mass**
 = 325 kg **maximum permissible mass of optional equipment**

It is important to note that this calculation is based on the default value for **mass in running order** as defined in the **type-approval procedure**, without taking into account the permissible weight deviations for **mass in running order** (see no. 2 above). If the maximum permissible value for the **optional equipment** of (in the example) 325 kg is almost or completely exhausted, an upward weight deviation can therefore result in the **minimum pay-mass** of 100 kg being met mathematically using the default value for the **mass in running order**, although in fact there is no corresponding **load capacity**. Here, too, an example calculation for a vehicle with four seats, whose real weighed **mass in running order** is 2 % above the nominal value:

3.500 kg **technically permissible maximum laden mass**
 - 2.907 kg **real weighed mass in running order** (+ 2 % compared to the stated value of 2,850 kg)
 - 3*75 kg **mass of the passengers**
 - 325 kg **optional equipment** (maximum permissible value)
 = 43 kg **actual load capacity** (< **minimum pay-mass** of 100 kg)

In order to avoid such a situation, Dethleffs further reduces the maximum permissible weight of the total **optional equipment** that can be ordered on a model-specific basis. The limitation of **optional equipment** is intended to ensure that the **minimum pay-mass**, i.e. the legally prescribed free mass for **baggage** and retrofitted **accessories**, is actually available for the **vehicle load capacity** of the vehicles delivered by Dethleffs. Since the weight of a specific vehicle can only be determined when it is weighed at the **end of the line**, in very rare cases a situation may arise in which the **minimum pay-mass** at the **end of the line** is not guaranteed, despite this limitation of **optional equipment**. In order to guarantee the **minimum pay-mass** even in these cases, Dethleffs will check together with your **trade partner** and you before delivery of the vehicle whether, for example, the vehicle is loaded up, seats are reduced or **optional equipment** is removed.

6. Effects of tolerances of the mass in running order on the pay-mass

Regardless of the **minimum pay-mass**, you should note that unavoidable production-related fluctuations in the **mass in running order** – both upwards and downwards – have a mirror-image effect on the remaining **load capacity**: If you order our example vehicle (see no. 3. above), for example, with **optional equipment** with a total weight of 150 kg, the calculated **pay-mass** based on the default value for the **mass in running order** is 275 kg. The **load capacity** actually available may deviate from this value due to **tolerances** and may be higher or lower. If the **mass in running or-**

der of your vehicle is, for example, permissibly 2 % higher than stated in the sales documents, the **load capacity** is reduced from 275 kg to 218 kg:

3.500 kg **technically permissible maximum laden mass**
 2.907 kg **real weighed mass in running order** (+ 2 % compared to the stated value of 2,850 kg)
 3*75 kg **mass of the passengers**
 150 kg **optional equipment** ordered for the specific vehicle
 = 218 kg **sactical load capacity**

As a precaution to ensure that the calculated **pay-mass** is actually given, you should therefore take the possible and permissible **tolerances** for the **mass in running order** into account when configuring your vehicle. We also recommend that you weigh the laden **motorhome** on a non-automatic scale before each journey and, taking the individual weight of the **passengers** into account, determine whether the **technically permissible maximum laden mass** and the **technically permissible maximum mass on the axle** are observed.